

**Tract 13**

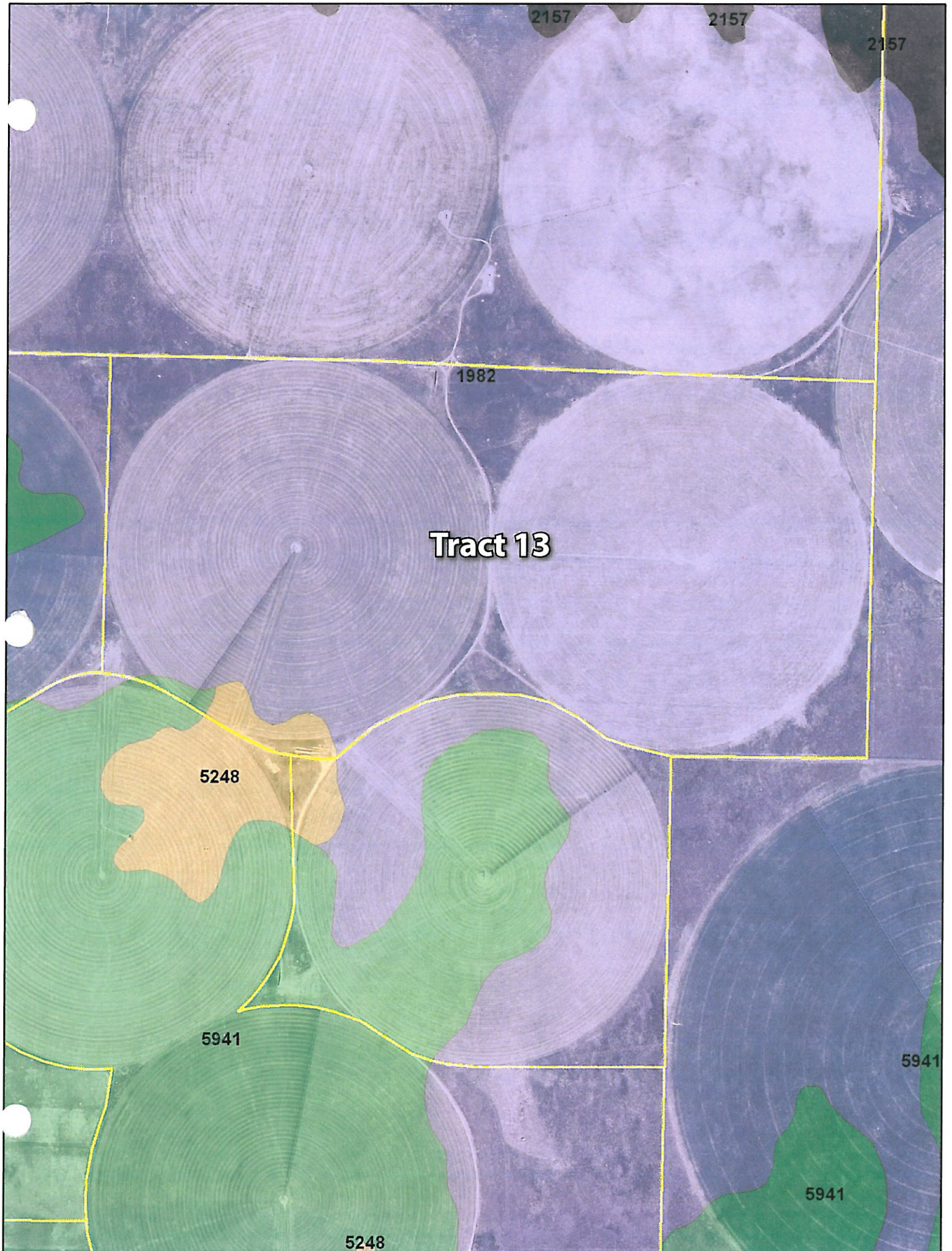



2157

2157

2157

1982

**Tract 13**

5248

5941

5941

5941

5248



# Tract 13

## Soils Map

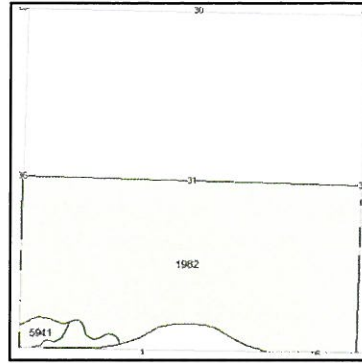
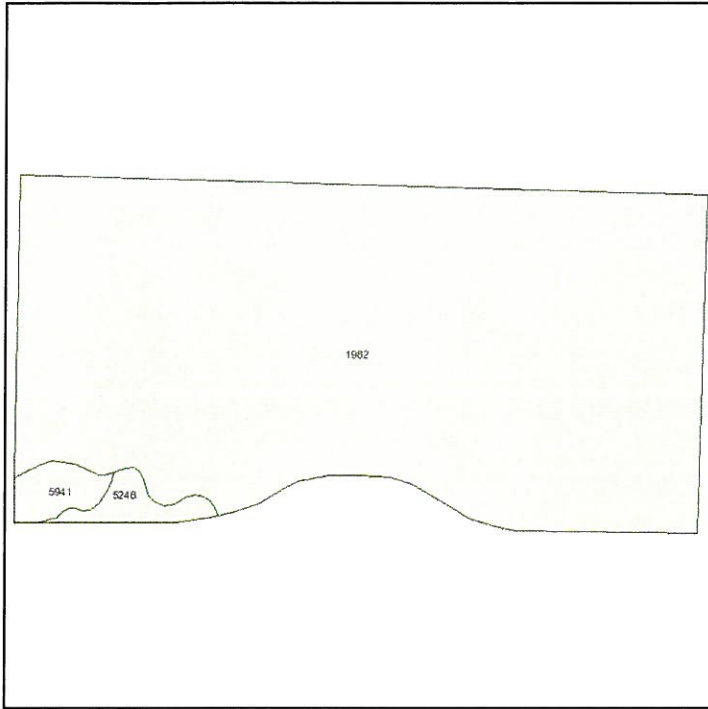

State: **Kansas**  
 County: **Gray**  
 Location: **031-025S-029W**  
 Township: **Ingalls**  
 Acres: **300.5**  
 Date: **8/10/2010**



Fsa borders provided by the Farm Service Agency as of May 23, 2008.  
 Soils data provided by USDA and NRCS.



| Code                    | Soil Description                                      | Acres | Percent of field | Non-Irr Class | Irr Class | Alfalfa hay Irrigated | Corn Irrigated | Grain sorghum Irrigated | Grain sorghum | Winter wheat Irrigated | Winter wheat |
|-------------------------|---|-------|------------------|---------------|-----------|-----------------------|----------------|-------------------------|---------------|------------------------|--------------|
| 1982                    | Valent fine sand, 5 to 20 percent slopes              | 289   | 96.2%            | VIIe          | VIe       |                       |                |                         |               |                        |              |
| 5941                    | Pratt-Tivoli loamy fine sands, 5 to 15 percent slopes | 5.9   | 2.0%             | Ve            | IIIe      | 6                     | 105            | 85                      | 35            |                        | 18           |
| 5248                    | Optima fine sand, 0 to 5 percent slopes               | 5.6   | 1.9%             | VIe           | IVe       |                       | 80             | 60                      |               | 40                     |              |
| <b>Weighted Average</b> |   |       |                  |               |           | <b>0.1</b>            | <b>3.6</b>     | <b>2.8</b>              | <b>0.7</b>    | <b>0.8</b>             | <b>0.4</b>   |



13

W Cr.

Don Renick

SW $\frac{1}{4}$  31-25-29 - Gray County

Total Depth 200' - drilled 9-21-78

Well #69

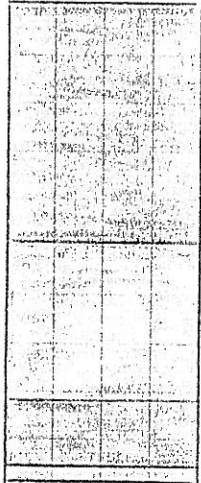

100' Plain

65' Perf.

30' Screen

5' Perf.

200 ft. Drilling, Casing & Gravel

30 ft. Johnson Well Screen

140 ft. 8 x 2 $\frac{1}{2}$  x 1 $\frac{1}{2}$ " Column, Tube & Shaft  
w/LH Woodline Tube

1 - 4 stage 12" Bowl 2/5. 12JHMO 1-H 3-M

1 - 8 x 16 $\frac{1}{2}$  Discharge Assembly - Goulds

8/14/03 - Inv. #9636 - lowered 50' - now at 190'.





13  
E Cr

Don Renick  
SE 31-25-29 - Gray County  
Total Depth 215' - drilled 9-29-78  
Well #70



100' Plain

60' Perf.

30' Screen

10' Perf.  
10' Screen  
5' Perf.

215' Drilling, Casing & Gravel

40' Johnson Screen

180' 8 x 2½ x 1½" Column, Tube & Shaft  
LH Woodline

1 - 4 Stage 12" Bowl JHMO

1 - H 3 - M

1 - 8 x 16½ Discharge Assembly Goulds

8-22-02 - Inv. #0008878 - put on a 8" McCrometer  
Meter - Model #MD308-1300V - S/N 02-8-2589.

5-30-04 - Inv. #010202 - lowered 20' - now set at 200'. Pump is 4½ to 5' off  
of bottom.

7-26-06-Henkle Inv. #509744 - Pulled 200' pump, put down a new 12L55 3 Stage Bowl Unit.  
set 200' pump.

Bought 50 HP Motor at Midwest

Bought 50 HP Soft Start at Meis Electric

3-22-10 - Inv. #014905 - Pulled 200' pump, T.V.'d well, sonar jet cleaned 75 ft., bailed  
well, repaired 3 Stage 12L44 American Turbine Bowl Unit, repaired column, tube & shaft  
lowered 10' - set 210' pump.



WATER RIGHT INFORMATION REPORT FOR : 29083 00

RIGHT TYPE: Appropriation

SOURCE: Groundwater USE: IRR

CURRENT STATUS: Certificate Issued

PRIORITY DATE: 25-FEB-77

CURRENT COMPLETE BY DATE: 31-DEC-78

COMPLETION ACKNOWLEDGED DATE: 13-DEC-78

CURRENT PERFECT BY DATE: 31-DEC-82

YEAR PERFECTED:

CERTIFICATE ISSUED DATE: 28-FEB-84

.....

APPLICANT(S):

> RENICK CATTLE CO(AKA: RENICK BROS INC) MIKE RENICK 10807 #6 RD INGALLS KS 67853

> PERSON ID (Old Address Code): 14563

> CORRESPONDENT SEQUENCE NUMBER: 1

>-----

.....

WATER USE CORRESPONDENT(S):

> W R RENICK INC 6514 US HIGHWAY 50 INGALLS KS 67853

> PERSON ID (Old Address Code): 31701

> CORRESPONDENT SEQUENCE NUMBER: 1

>-----

> BEST FARMS INC 10502 6 RD INGALLS KS 67853

> PERSON ID (Old Address Code): 58733

> CORRESPONDENT SEQUENCE NUMBER: 1

>-----

.....

ACTION TRAIL:

- 25-FEB-77 Pending Initial Review
- 17-MAY-77 Approved Pending Completion N+P BY 31-DEC-78 PERF BY 31-DEC-82
- 13-DEC-78 Completed Pending Inspection
- 17-MAY-82 Inspected Pending Perfection
- 18-NOV-83 Proposed Certificate
- 10-JAN-84 Corres & Wur From Renick Cattle Co To Renick Brothers Inc
- 28-FEB-84 Certificate Issued
- 17-JAN-89 Notarized Wuc
- 22-MAR-89 Corres & Wur From Renick Bros To W R Renick
- 23-FEB-90 Ownership-Lms
- 27-FEB-91 Add To Multiple Wur List
- 27-FEB-91 Corres & Wur From W R Renick To W R Renick & Renick Bros Inc
- 20-OCT-94 Notarized Wuc
- 23-NOV-94 Corres & Wur From Renick Bros Inc To David L Reynolds
- 13-DEC-94 Corres & Wur From David L Reynolds To Donoco Farms Inc
- 17-NOV-05 Landowner Chg-Part Of Land- Best Farms Inc
- 17-NOV-05 Wur From Donoco Farms Inc To Best Farms Inc -Pdiv 24339, 33964 & 48331

.....

CONSERVATION CONTRACT ACTION TRAIL:

.....

CONSERVATION PLAN ACTION TRAIL:

.....

SPECIAL CONDITIONS:

.....

QUANTITIES BY POINT OF DIVERSION:

|                              |   |                |            |            |            |
|------------------------------|---|----------------|------------|------------|------------|
| > Section 1, T 26, R 30W ID  | 4 | IRR AUTHORIZED | 257.000 AF | ADDITIONAL | 257.000 AF |
| > Section 31, T 25, R 29W ID | 3 | IRR AUTHORIZED | 263.000 AF | ADDITIONAL | 263.000 AF |
| > Section 31, T 25, R 29W ID | 4 | IRR AUTHORIZED | 272.000 AF | ADDITIONAL | 272.000 AF |
| > Section 32, T 25, R 29W ID | 5 | IRR AUTHORIZED | 272.000 AF | ADDITIONAL | 272.000 AF |

.....

RATES BY POINT OF DIVERSION:

|                              |   |                |             |            |             |
|------------------------------|---|----------------|-------------|------------|-------------|
| > Section 1, T 26, R 30W ID  | 4 | IRR AUTHORIZED | 804.000 gpm | ADDITIONAL | 804.000 gpm |
| > Section 31, T 25, R 29W ID | 3 | IRR AUTHORIZED | 800.000 gpm | ADDITIONAL | 800.000 gpm |
| > Section 31, T 25, R 29W ID | 4 | IRR AUTHORIZED | 878.000 gpm | ADDITIONAL | 878.000 gpm |
| > Section 32, T 25, R 29W ID | 5 | IRR AUTHORIZED | 922.000 gpm | ADDITIONAL | 922.000 gpm |

.....

LIMITATIONS: None

.....

STORAGE QUANTITIES: No active storage quantities associated with IRR use under this water right

STORAGE RATES: No active storage rates associated with IRR use under this water right

.....

AUTHORIZED POINTS(S) OF DIVERSION

Section 31, T 25, R 29W, ID 3 (Internal PDIV\_ID = 33964)

QUALIFIERS: NC SW

DIST. FROM SE CORNER: 1280 ft North 3960 ft West

NUMBER OF WELLS: 1

COMMENT:

OLD LONGITUDE: 100.550730 OLD LATITUDE: 37.832589

NEW LONGITUDE: 100.550866 NEW LATITUDE: 37.831674

GPS LONGITUDE: GPS LATITUDE:

GPS FEET NORTH: GPS FEET WEST:

COUNTY: GRAY

FIELD OFFICE: GARDEN CITY FIELD OFFICE

GMD : 3

BASIN: ARKANSAS RIVER

STREAM:

SPECIAL\_USE\_AREA(S):

> ARK RIVER (IGUCA)

AQUIFER(S):

> ARK RIVER (IGUCA)

TEST INFORMATION:

> 17-MAY-82 800 gpm Field Inspection Test

METER ACTION TRAIL:

> 11-NOV-92 Meter Required GWMD Order Install by: 01-JUL-96

OVERLAPS:

-----

Section 31, T 25, R 29W, ID 4 (Internal PDIV\_ID = 48331)

QUALIFIERS: NC SE

DIST. FROM SE CORNER: 1240 ft North 1220 ft West

NUMBER OF WELLS: 1

COMMENT:

OLD LONGITUDE: 100.541325 OLD LATITUDE: 37.832480

NEW LONGITUDE: 100.541379 NEW LATITUDE: 37.831558

GPS LONGITUDE: GPS LATITUDE:

GPS FEET NORTH: GPS FEET WEST:

COUNTY: GRAY

FIELD OFFICE: GARDEN CITY FIELD OFFICE

GMD : 3

BASIN: ARKANSAS RIVER

STREAM:

SPECIAL\_USE\_AREA(S):

> ARK RIVER (IGUCA)

AQUIFER(S):

> ARK RIVER (IGUCA)

TEST INFORMATION:

> 17-MAY-82 878 gpm Field Inspection Test

METER ACTION TRAIL:

> 01-JAN-92 Meter Required GWMD Order Install by: 31-DEC-92

METER INFORMATION:

Date Installed : Currently Installed? Y

> Manufacturer: SIGNET Model: 9-4515

> Type: Not Available Serial No.: 211117

> Meter Unit: N/A Meter Size: 3 Inch Multiplier: 00

> Portable Pump Installation? N Multiple PDS? N Straightening Vanes? N

> Measuring Chamber? Meter Comment:

OVERLAPS:

-----

Section 32, T 25, R 29W, ID 5 (Internal PDIV\_ID = 52644)

QUALIFIERS: NC N2 SW

DIST. FROM SE CORNER: 1665 ft North 3900 ft West

NUMBER OF WELLS: 1

COMMENT:

OLD LONGITUDE: 100.532428 OLD LATITUDE: 37.833658

NEW LONGITUDE: 100.532682 NEW LATITUDE: 37.832548

GPS LONGITUDE: GPS LATITUDE:

GPS FEET NORTH: GPS FEET WEST:

COUNTY: GRAY

FIELD OFFICE: GARDEN CITY FIELD OFFICE

GMD : 3

BASIN: ARKANSAS RIVER

STREAM:

SPECIAL\_USE\_AREA(S):

> ARK RIVER (IGUCA)

AQUIFER(S):

> ARK RIVER (IGUCA)

TEST INFORMATION:

> 17-MAY-82 922 gpm Field Inspection Test

METER ACTION TRAIL:

> 11-NOV-92 Meter Required GWMD Order Install by: 01-JUL-96

OVERLAPS:

-----

Section 1, T 26, R 30W, ID 4 (Internal PDIV\_ID = 24339)

QUALIFIERS: NC

DIST. FROM SE CORNER: 5962 ft North 1320 ft West

NUMBER OF WELLS: 1

COMMENT: LINE BETWEEN LOT 1 & LOT 2

OLD LONGITUDE: 100.547361 OLD LATITUDE: 37.830961

NEW LONGITUDE: 100.546385 NEW LATITUDE: 37.826153

GPS LONGITUDE: GPS LATITUDE:
GPS FEET NORTH: GPS FEET WEST:
COUNTY: GRAY
FIELD OFFICE: GARDEN CITY FIELD OFFICE
GMD : 3
BASIN: ARKANSAS RIVER
STREAM:

SPECIAL\_USE\_AREA(S):

> ARK RIVER (IGUCA)

AQUIFER(S):

> ARK RIVER (IGUCA)

TEST INFORMATION:

> 17-MAY-82 804 gpm Field Inspection Test

METER ACTION TRAIL:

> 11-NOV-92 Meter Required GWMD Order Install by: 01-JUL-94

> 22-JUL-04 Meter Reported Replaced

> 22-JUL-04 Meter Reported Installed

METER INFORMATION:

Date Installed : 10-MAY-04 Currently Installed? Y

> Manufacturer: MCCROMETER Model: MD308-1300 OV

> Type: Not Available Serial No.: 04-8-2010

> Meter Unit: N/A Meter Size: 5 Inch Multiplier: .001

> Portable Pump Installation? Multiple PDs? Straightening Vanes?

> Measuring Chamber? Meter Comment:

METER INFORMATION:

Date Installed : Currently Installed? N

> Manufacturer: SIGNET Model: 4515

> Type: Not Available Serial No.: 211121

> Meter Unit: N/A Meter Size: 3 Inch Multiplier: 00

> Portable Pump Installation? N Multiple PDs? N Straightening Vanes? N

> Measuring Chamber? Meter Comment:

OVERLAPS:

-----

:::::::::::::::

AUTHORIZED PLACE(S) OF USE

Section 31, T 25, R 29W, ID 2 (Internal PUSE\_ID = 159)

OWNER: BEST FARMS INC

Address:

\*\* 10502 6 RD

\*\* INGALLS KS 67853

Total acres authorized = 280.00 Acres

Table with 16 columns representing sections NE, NW, SW, SE and 4 rows of data values.

COMMENT: LOT-3(NWSW) LOT-4(SWSW)

OVERLAPS:

-----

Section 32, T 25, R 29W, ID 2 (Internal PUSE\_ID = 13336)

OWNER: RENICK BROS INC(AKA: RENICK CATTLE CO)

Address: GARY S RENICK

\*\* 10807 #6 RD

\*\* INGALLS KS 67853

Total acres authorized = 240.00 Acres

| NE  |     |     |     | NW  |     |     |     | SW  |     |     |     | SE  |     |     |     |
|-----|-----|-----|-----|-----|-----|-----|-----|-----|-----|-----|-----|-----|-----|-----|-----|
| NE  | NW  | SW  | SE  | NE  | NW  | SW  | SE  | NE  | NW  | SW  | SE  | NE  | NW  | SW  | SE  |
| .00 | .00 | .00 | .00 | .00 | .00 | .00 | .00 | .00 | .00 | .00 | .00 | .00 | .00 | .00 | .00 |

COMMENT:

OVERLAPS:

-----

Section 1, T 26, R 30W, ID 3 (Internal PUSE\_ID = 40831)

OWNER: BEST FARMS INC

Address:

\*\* 10502 6 RD

\*\* INGALLS KS 67853

Total acres authorized = 122.00 Acres

| NE    |       |     |     | NW  |     |     |     | SW  |     |     |     | SE  |     |     |     |
|-------|-------|-----|-----|-----|-----|-----|-----|-----|-----|-----|-----|-----|-----|-----|-----|
| NE    | NW    | SW  | SE  | NE  | NW  | SW  | SE  | NE  | NW  | SW  | SE  | NE  | NW  | SW  | SE  |
| 61.00 | 61.00 | .00 | .00 | .00 | .00 | .00 | .00 | .00 | .00 | .00 | .00 | .00 | .00 | .00 | .00 |

COMMENT: LOT 1 (NENE) LOT 2 (NWNE)

OVERLAPS:

-----

::::::::::::::::::

WATER USE INFORMATION:

| Year | Qualifiers | SC    | ID | Date Rcvd   | Hours | GPM   | Acre-feet | Code | Ac_Irr    | Date Msrd | Wtr_Dp | Well_Dp | Reel | Blip |
|------|------------|-------|----|-------------|-------|-------|-----------|------|-----------|-----------|--------|---------|------|------|
| 2009 | 5962N      | 1320W | 1  | 4 22-FEB-10 | 1806  | 558   | 186.0     | A    | 118       | 10-JAN-10 | 125    | N/A     | 61   | 116  |
| 2009 | 1280N      | 3960W | 31 | 3 22-FEB-10 | 1732  | 509   | 162.0     | A    | 125       | 10-JAN-10 | 99     | N/A     | 61   | 116  |
| 2009 | 1240N      | 1220W | 31 | 4 22-FEB-10 | 348   | 295   | 18.9      | M    | 118       | 10-JAN-10 | 115    | N/A     | 61   | 116  |
| 2009 | 1665N      | 3900W | 32 | 5 01-MAR-10 |       | 113.0 | A         | 150  |           | N/A       | N/A    | 62      | 282  |      |
| 2008 | 5962N      | 1320W | 1  | 4 27-FEB-09 | 1919  | 578   | 204.0     | A    | 118       | 01-JAN-09 | 121    | N/A     | 55   | 2510 |
| 2008 | 1280N      | 3960W | 31 | 3 27-FEB-09 | 2037  | 480   | 180.0     | A    | 157       | 01-JAN-09 | 99     | N/A     | 55   | 2510 |
| 2008 | 1240N      | 1220W | 31 | 4 27-FEB-09 | 1510  | 370   | 99.4      | M    | 86        | 01-JAN-09 | 110    | N/A     | 55   | 2510 |
| 2008 | 1665N      | 3900W | 32 | 5 02-MAR-09 |       | 2.0   | A         | 150  |           | N/A       | N/A    | 56      | 621  |      |
| 2007 | 5962N      | 1320W | 1  | 4 25-FEB-08 | 1446  | 638   | 170.0     | A    | 118       | 01-JAN-90 | 69     | N/A     | 48   | 3197 |
| 2007 | 1280N      | 3960W | 31 | 3 25-FEB-08 | 2204  | 560   | 227.0     | A    | 125       | 01-JAN-87 | 48     | N/A     | 48   | 3197 |
| 2007 | 1240N      | 1220W | 31 | 4 25-FEB-08 | 1490  | 483   | 132.0     | A    | 118       | 01-JAN-07 | 96     | N/A     | 48   | 3197 |
| 2007 | 1665N      | 3900W | 32 | 5 29-FEB-08 |       | 88.0  | A         | 150  |           | N/A       | N/A    | 49      | 2101 |      |
| 2006 | 5962N      | 1320W | 1  | 4 01-MAR-07 | 1992  | 600   | 216.0     | A    | 118       | 01-JAN-90 | 69     | N/A     | 43   | 2919 |
| 2006 | 1280N      | 3960W | 31 | 3 01-MAR-07 | 1921  | 575   | 199.0     | A    | 125       | 01-JAN-87 | 48     | N/A     | 43   | 2919 |
| 2006 | 1240N      | 1220W | 31 | 4 01-MAR-07 | 1207  | 850   | 188.0     | A    | 118       | 01-JAN-07 | 96     | N/A     | 43   | 2919 |
| 2006 | 1665N      | 3900W | 32 | 5 01-MAR-07 |       | 183.0 | A         | 150  |           | N/A       | N/A    | 43      | 2495 |      |
| 2005 | 5962N      | 1320W | 1  | 4 23-FEB-06 |       | 700   | 132.0     | A    | 118       | 01-JAN-90 | 69     | N/A     | 37   | 637  |
| 2005 | 1280N      | 3960W | 31 | 3 23-FEB-06 | 1565  | 570   | 164.0     | A    | 125       | 01-JAN-87 | 48     | N/A     | 37   | 637  |
| 2005 | 1240N      | 1220W | 31 | 4 23-FEB-06 | 1195  | 570   | 124.0     | A    | 118       | 01-DEC-05 | 96     | N/A     | 37   | 637  |
| 2005 | 1665N      | 3900W | 32 | 5 02-MAR-06 |       | 230.0 | A         | 150  |           | N/A       | N/A    | 38      | 917  |      |
| 2004 | 5962N      | 1320W | 1  | 4 10-FEB-05 |       | 203.0 | A         | 118  | 01-JAN-90 | 69        | N/A    | 30      | 563  |      |
| 2004 | 1280N      | 3960W | 31 | 3 10-FEB-05 |       | 224.0 | A         | 125  | 01-JAN-87 | 48        | N/A    | 30      | 563  |      |
| 2004 | 1240N      | 1220W | 31 | 4 10-FEB-05 |       | 142.0 | A         | 118  | 01-JAN-03 | 83        | N/A    | 30      | 563  |      |
| 2004 | 1665N      | 3900W | 32 | 5 25-FEB-05 | 48    | 450   | 252.0     | A    | 150       |           | N/A    | N/A     | 31   | 1198 |
| 2003 | 5962N      | 1320W | 1  | 4 01-MAR-04 |       | 264.5 | M         | 118  | 01-JAN-90 | 69        | N/A    | 26      | 10   |      |
| 2003 | 1280N      | 3960W | 31 | 3 01-MAR-04 |       | 239.0 | A         | 125  | 01-JAN-87 | 48        | N/A    | 26      | 10   |      |
| 2003 | 1240N      | 1220W | 31 | 4 01-MAR-04 |       | 242.0 | A         | 118  | 01-NOV-03 | 92        | N/A    | 26      | 10   |      |
| 2003 | 1665N      | 3900W | 32 | 5 01-MAR-04 |       | 283.0 | A         | 150  |           | N/A       | N/A    | 25      | 2948 |      |
| 2002 | 5962N      | 1320W | 1  | 4 27-FEB-03 |       | 179.8 | M         | 118  | 01-JAN-90 | 69        | N/A    | 19      | 2202 |      |
| 2002 | 1280N      | 3960W | 31 | 3 27-FEB-03 |       | 301.0 | A         | 125  | 01-JAN-87 | 48        | N/A    | 19      | 2202 |      |

|      |       |       |    |   |           |       |     |       |           |     |           |     |             |         |
|------|-------|-------|----|---|-----------|-------|-----|-------|-----------|-----|-----------|-----|-------------|---------|
| 2002 | 1240N | 1220W | 31 | 4 | 27-FEB-03 | 249.0 | A   | 118   | 16-JAN-03 | 83  | N/A       | 19  | 2202        |         |
| 2002 | 1665N | 3900W | 32 | 5 | 03-MAR-03 | N/A   |     |       | N/A       | N/A |           |     |             |         |
| 2001 | 5962N | 1320W | 1  | 4 | 27-FEB-02 | 750   |     | 213.5 | M         | 125 | 01-JAN-90 | 69  | 236 13 2308 |         |
| 2001 | 1280N | 3960W | 31 | 3 | 27-FEB-02 | 740   |     | 228.0 | A         | 125 | 01-JAN-87 | 48  | 200 13 2308 |         |
| 2001 | 1240N | 1220W | 31 | 4 | 27-FEB-02 | 750   |     | 205.1 | M         | 125 | 01-JAN-87 | 65  | 215 13 2308 |         |
| 2001 | 1665N | 3900W | 32 | 5 | 04-MAR-02 | 264.0 | A   | 150   | 15-AUG-89 | 70  |           | 205 | 14 1982     |         |
| 2000 | 5962N | 1320W | 1  | 4 | 02-MAR-01 | 750   |     | 253.8 | M         | 125 | 01-JAN-90 | 69  | 236 8 991   |         |
| 2000 | 1280N | 3960W | 31 | 3 | 02-MAR-01 | 740   |     | 275.0 | A         | 125 | 01-JAN-87 | 48  | 200 8 991   |         |
| 2000 | 1240N | 1220W | 31 | 4 | 02-MAR-01 | 750   |     | 261.7 | M         | 125 | 01-JAN-87 | 65  | 215 8 991   |         |
| 2000 | 1665N | 3900W | 32 | 5 | 02-MAR-01 | 284.0 | A   | 150   | 15-AUG-89 | 70  |           | 205 | 8 882       |         |
| 1999 | 5962N | 1320W | 1  | 4 | 03-MAR-00 | 217.4 |     |       | M         | 125 | 01-JAN-90 | 69  | 236 4 1414  |         |
| 1999 | 1280N | 3960W | 31 | 3 | 03-MAR-00 | 192.0 |     |       | A         | 125 | 01-JAN-87 | 48  | 200 4 1414  |         |
| 1999 | 1240N | 1220W | 31 | 4 | 03-MAR-00 | 221.0 |     |       | M         | 125 | 01-JAN-87 | 65  | 215 4 1414  |         |
| 1999 | 1665N | 3900W | 32 | 5 | 25-FEB-00 | 237.0 |     |       | A         | 150 | 15-AUG-89 | 70  | 205 3 816   |         |
| 1998 | 5962N | 1320W | 1  | 4 | 22-FEB-99 | 750   |     | 292.9 | M         | 125 | 01-JAN-90 | 69  | 236 93 2960 |         |
| 1998 | 1280N | 3960W | 31 | 3 | 22-FEB-99 | 740   |     | 227.0 | A         | 125 | 01-JAN-87 | 48  | 200 93 2959 |         |
| 1998 | 1240N | 1220W | 31 | 4 | 22-FEB-99 | 750   |     | 307.2 | M         | 125 | 01-JAN-87 | 65  | 215 93 2959 |         |
| 1998 | 1665N | 3900W | 32 | 5 | 01-MAR-99 | 277.0 |     |       | A         | 150 | 15-AUG-89 | 70  | 205 94 2922 |         |
| 1997 | 5962N | 1320W | 1  | 4 | 02-MAR-98 | 241.4 |     |       | M         | 125 | 01-JAN-90 | 69  | 236 89 1105 |         |
| 1997 | 1280N | 3960W | 31 | 3 | 02-MAR-98 | 200.0 |     |       | A         | 125 | 01-JAN-87 | 48  | 200 89 1104 |         |
| 1997 | 1240N | 1220W | 31 | 4 | 02-MAR-98 | 228.9 |     |       | M         | 125 | 01-JAN-87 | 65  | 215 89 1105 |         |
| 1997 | 1665N | 3900W | 32 | 5 | 02-MAR-98 | 223.0 |     |       | A         | 150 |           | 70  | 205 89 841  |         |
| 1996 | 5962N | 1320W | 1  | 4 | 03-MAR-97 | 207.2 |     |       | M         | 120 | 01-JAN-97 | 79  | 236 83 1001 |         |
| 1996 | 1280N | 3960W | 31 | 3 | 03-MAR-97 | 1375  | 650 | 117.0 | A         | 125 | 01-JAN-87 | 48  | 200 83 1000 |         |
| 1996 | 1240N | 1220W | 31 | 4 | 03-MAR-97 | 272.1 |     |       | M         | 120 | 01-JAN-87 | 65  | 215 83 1000 |         |
| 1996 | 1665N | 3900W | 32 | 5 | 03-MAR-97 | 1930  | 650 | 125.0 | A         | 150 | 15-AUG-88 | 70  | 205 83 717  |         |
| 1995 | 5962N | 1320W | 1  | 4 | 01-MAR-96 | 0     | 750 | 266.9 | 8         | 125 | 01-JAN-87 | 69  | 236 77 650  |         |
| 1995 | 1280N | 3960W | 31 | 3 | 01-MAR-96 | 1877  | 750 | 259.2 | G         | 125 | 01-JAN-87 | 48  | 200 77 650  |         |
| 1995 | 1240N | 1220W | 31 | 4 | 01-MAR-96 | 1833  | 700 | 236.3 | G         | 125 | 01-JAN-87 | 65  | 215 77 650  |         |
| 1995 | 1665N | 3900W | 32 | 5 | 01-MAR-96 | 2270  | 650 | 271.7 | G         | 150 | 01-AUG-88 | 70  | 205 77 651  |         |
| 1994 | 5962N | 1320W | 1  | 4 | 01-MAR-95 | 0     | 750 | 182.7 | 8         | 125 | 01-JAN-90 | 69  | 236 72 703  |         |
| 1994 | 1280N | 3960W | 31 | 3 | 01-MAR-95 | 2119  | 750 | 292.6 | G         | 125 | 01-JAN-87 | 48  | 200 72 703  |         |
| 1994 | 1240N | 1220W | 31 | 4 | 01-MAR-95 | 0     | 700 | 268.3 | 8         | 125 | 01-JAN-87 | 65  | 215 72 703  |         |
| 1994 | 1665N | 3900W | 32 | 5 | 01-MAR-95 | 2792  | 650 | 334.2 | G         | 150 | 01-AUG-88 | 70  | 205 72 704  |         |
| 1993 | 5962N | 1320W | 1  | 4 | 28-FEB-94 | 1797  | 750 | 248.2 | G         | 125 | 01-JAN-90 | 69  | 236 65 2050 |         |
| 1993 | 1280N | 3960W | 31 | 3 | 28-FEB-94 | 1779  | 750 | 245.7 | G         | 125 | 01-JAN-87 | 48  | 200 65 2049 |         |
| 1993 | 1240N | 1220W | 31 | 4 | 28-FEB-94 | 1399  | 700 | 180.3 | G         | 125 | 01-JAN-87 | 65  | 215 65 2049 |         |
| 1993 | 1665N | 3900W | 32 | 5 | 02-MAR-94 | 1328  | 650 | 158.9 | G         | 145 | 01-AUG-88 | 70  | 205 66 645  |         |
| 1992 | 5962N | 1320W | 1  | 4 | 01-MAR-93 | 1710  | 750 | 236.2 | G         | 125 | 01-JAN-90 | 69  | 236 59 2210 |         |
| 1992 | 1280N | 3960W | 31 | 3 | 01-MAR-93 | 2159  | 750 | 298.2 | G         | 125 | 01-JAN-87 | 48  | 200 59 2208 |         |
| 1992 | 1240N | 1220W | 31 | 4 | 01-MAR-93 | 1486  | 700 | 191.5 | G         | 125 | 01-JAN-87 | 65  | 215 59 2208 |         |
| 1992 | 1665N | 3900W | 32 | 5 | 01-MAR-93 | 1873  | 650 | 224.2 | G         | 145 | 01-AUG-88 | 70  | 205 60 244  |         |
| 1991 | 5962N | 1320W | 1  | 4 | 02-MAR-92 | 2849  | 750 | 393.4 | G         | 125 | 01-JAN-90 | 69  | 236 54 550  |         |
| 1991 | 1280N | 3960W | 31 | 3 | 02-MAR-92 | 2905  | 750 | 401.2 | G         | 125 | 01-JAN-87 | 48  | 200 54 549  |         |
| 1991 | 1240N | 1220W | 31 | 4 | 02-MAR-92 | 3093  | 650 | 370.2 | G         | 125 | 01-JAN-87 | 65  | 215 54 549  |         |
| 1991 | 1665N | 3900W | 32 | 5 | 02-MAR-92 | 3265  | 700 | 420.8 | G         | 145 | 01-AUG-88 | 70  | 205 54 1821 |         |
| 1990 | 5962N | 1320W | 1  | 4 | 21-FEB-91 | 2517  | 750 | 347.6 | G         | 120 | 01-JAN-90 | 69  | 236 47 265  |         |
| 1990 | 1280N | 3960W | 31 | 3 | 21-FEB-91 | 1291  | 750 | 178.3 | G         | 125 | 01-JAN-87 | 48  | 200 47 264  |         |
| 1990 | 1240N | 1220W | 31 | 4 | 21-FEB-91 | 2233  | 750 | 308.4 | G         | 120 | 01-JAN-87 | 65  | 215 47 265  |         |
| 1990 | 1665N | 3900W | 32 | 5 | 01-MAR-91 | 2596  | 700 | 334.6 | G         | 145 | 01-AUG-88 | 70  | 205 47 439  |         |
| 1989 | 5962N | 1320W | 1  | 4 | 23-FEB-90 | 2964  | 750 | 409.3 | G         | 125 | 01-JAN-87 | 70  | 236 41 3419 |         |
| 1989 | 1280N | 3960W | 31 | 3 | 23-FEB-90 | 2823  | 750 | 389.9 | G         | 125 |           | N/A | N/A         | 41 3418 |



|      |       |       |    |   |           |                                   |      |       |   |     |           |     |     |    |      |
|------|-------|-------|----|---|-----------|-----------------------------------|------|-------|---|-----|-----------|-----|-----|----|------|
| 1989 | 1240N | 1220W | 31 | 4 | 23-FEB-90 | 2099                              | 750  | 289.9 | G | 125 | 01-JAN-87 | 65  | 215 | 41 | 3419 |
| 1989 | 1665N | 3900W | 32 | 5 | 23-FEB-90 | 2258                              | 700  | 291.0 | G | 145 | 01-AUG-88 | 70  | 205 | 41 | 3419 |
| 1989 | 1665N | 3900W | 32 | 5 | 23-FEB-90 | Comment: ALSO SEE-41-1984- 2785-N |      |       |   |     |           |     |     |    |      |
| 1988 | 5962N | 1320W | 1  | 4 |           | 1269                              | 750  | 175.2 | G | 125 | 01-JAN-89 | 70  | 236 | 35 | 3002 |
| 1988 | 1280N | 3960W | 31 | 3 |           | 2082                              | 750  | 287.5 | G | 125 | 01-JAN-87 | 48  | 200 | 35 | 3002 |
| 1988 | 1240N | 1220W | 31 | 4 |           | 2400                              | 650  | 287.2 | G | 125 | 01-JAN-87 | 65  | 215 | 35 | 3002 |
| 1988 | 1665N | 3900W | 32 | 5 |           | 2706                              | 700  | 348.8 | G | 145 | 15-AUG-88 | 70  | 205 | 36 | 2284 |
| 1987 | 5962N | 1320W | 1  | 4 |           | 2227                              | 750  | 307.5 | G | 150 |           | N/A | N/A | 32 | 3195 |
| 1987 | 1280N | 3960W | 31 | 3 |           | 1524                              | 750  | 210.5 | G | 125 |           | N/A | N/A | 32 | 3194 |
| 1987 | 1240N | 1220W | 31 | 4 |           | 1524                              | 750  | 210.5 | G | 125 |           | N/A | N/A | 32 | 3195 |
| 1987 | 1665N | 3900W | 32 | 5 |           | 2179                              | 750  | 300.9 | G | 125 |           | N/A | N/A | 32 | 3195 |
| 1986 | 5962N | 1320W | 1  | 4 |           | 2409                              | 798  | 354.0 | G | 125 | 01-JAN-87 | N/A | 50  | 28 | 301  |
| 1986 | 1280N | 3960W | 31 | 3 |           | 2201                              | 800  | 324.2 | G | 125 | 01-JAN-87 | N/A | 48  | 28 | 300  |
| 1986 | 1240N | 1220W | 31 | 4 |           | 2436                              | 780  | 349.9 | G | 125 | 01-JAN-87 | N/A | 65  | 28 | 300  |
| 1986 | 1665N | 3900W | 32 | 5 |           | 2866                              | 700  | 369.4 | G | 150 | 01-JAN-87 | N/A | 72  | 28 | 300  |
| 1985 | 5962N | 1320W | 1  | 4 |           | 2121                              | 798  | 311.7 | G |     |           | N/A | N/A | 22 | 3918 |
| 1985 | 1280N | 3960W | 31 | 3 |           | 1904                              | 800  | 280.5 | G |     |           | N/A | N/A | 22 | 3917 |
| 1985 | 1240N | 1220W | 31 | 4 |           | 2020                              | 780  | 290.1 | G |     |           | N/A | N/A | 22 | 3917 |
| 1985 | 1665N | 3900W | 32 | 5 |           | 2244                              | 780  | 322.3 | G |     |           | N/A | N/A | 22 | 3917 |
| 1984 | 5962N | 1320W | 1  | 4 |           | 1730                              | 805  | 256.4 | G | 125 |           | N/A | N/A | 19 | 425  |
| 1984 | 1280N | 3960W | 31 | 3 |           | 1750                              | 800  | 257.8 | G | 125 |           | N/A | N/A | 19 | 424  |
| 1984 | 1240N | 1220W | 31 | 4 |           | 1800                              | 880  | 291.7 | G | 125 |           | N/A | N/A | 19 | 424  |
| 1984 | 1665N | 3900W | 32 | 5 |           | 2630                              | 920  | 445.5 | G | 148 |           | N/A | N/A | 19 | 424  |
| 1983 | 5962N | 1320W | 1  | 4 |           | 0                                 | 1000 | 280.0 | 7 | 130 |           | N/A | N/A | 13 | 21   |
| 1983 | 1280N | 3960W | 31 | 3 |           | 0                                 | 950  | 230.0 | 7 | 130 |           | N/A | N/A | 14 | 21   |
| 1983 | 1240N | 1220W | 31 | 4 |           | 0                                 | 1000 | 240.0 | 7 | 130 |           | N/A | N/A | 14 | 21   |
| 1983 | 1665N | 3900W | 32 | 5 |           | 0                                 | 1000 | 320.0 | 7 | 130 |           | N/A | N/A | 13 | 21   |
| 1982 | 5962N | 1320W | 1  | 4 |           | 1722                              | 1000 | 317.1 | G | 130 | 01-FEB-83 | 63  | 282 | 7  | 1613 |
| 1982 | 1280N | 3960W | 31 | 3 |           | 1761                              | 1000 | 324.3 | G | 130 | 01-FEB-83 | 45  | 200 | 7  | 1613 |
| 1982 | 1240N | 1220W | 31 | 4 |           | 1666                              | 980  | 300.6 | G | 130 | 01-FEB-83 | 62  | 215 | 7  | 1613 |
| 1982 | 1665N | 3900W | 32 | 5 |           | 1755                              | 950  | 307.0 | G | 130 | 01-FEB-83 | 38  | 205 | 7  | 1613 |
| 1981 | 5962N | 1320W | 1  | 4 |           | 1553                              | 0    | .0    | G | 130 | 01-JAN-80 | 42  | 232 | 1  | 3675 |
| 1981 | 5962N | 1320W | 1  | 4 |           | Comment: 106680-E                 |      |       |   |     |           |     |     |    |      |
| 1981 | 1280N | 3960W | 31 | 3 |           | 1496                              | 0    | .0    | G | 130 | 01-JAN-80 | 42  | 200 | 1  | 3675 |
| 1981 | 1280N | 3960W | 31 | 3 |           | Comment: 102840-E                 |      |       |   |     |           |     |     |    |      |
| 1981 | 1240N | 1220W | 31 | 4 |           | 1754                              | 0    | .0    | G | 130 | 01-JAN-80 | 59  | 215 | 1  | 3675 |
| 1981 | 1240N | 1220W | 31 | 4 |           | Comment: 120480-E                 |      |       |   |     |           |     |     |    |      |
| 1981 | 1665N | 3900W | 32 | 5 |           | 2192                              | 0    | .0    | G | 130 | 01-JAN-80 | 42  | 205 | 1  | 3675 |
| 1981 | 1665N | 3900W | 32 | 5 |           | Comment: 150560-E                 |      |       |   |     |           |     |     |    |      |
| 1980 | 5962N | 1320W | 1  | 4 |           | 1890                              | 0    | .0    | G | 125 |           | N/A | N/A | 99 | 9999 |
| 1980 | 1280N | 3960W | 31 | 3 |           | 2600                              | 800  | 383.0 | G | 125 |           | N/A | N/A | 99 | 9999 |
| 1980 | 1240N | 1220W | 31 | 4 |           | 2580                              | 0    | .0    | G | 125 |           | N/A | N/A | 99 | 9999 |
| 1980 | 1665N | 3900W | 32 | 5 |           | 1580                              | 1500 | 436.4 | G | 140 |           | N/A | N/A | 99 | 9999 |
| 1979 | 5962N | 1320W | 1  | 4 |           | 1740                              | 800  | 256.3 | 0 | 136 |           | N/A | N/A | 0  | 0    |
| 1979 | 1280N | 3960W | 31 | 3 |           | 1755                              | 900  | 290.8 | 0 | 136 |           | N/A | N/A | 0  | 0    |
| 1979 | 1240N | 1220W | 31 | 4 |           | 1790                              | 1000 | 329.6 | 0 | 136 |           | N/A | N/A | 0  | 0    |
| 1979 | 1665N | 3900W | 32 | 5 |           | 1810                              | 800  | 266.6 | 0 | 136 |           | N/A | N/A | 0  | 0    |
| 1978 | 5962N | 1320W | 1  | 4 |           | 1750                              | 800  | 257.8 | 0 | 136 |           | N/A | N/A | 0  | 0    |
| 1978 | 1280N | 3960W | 31 | 3 |           | 1750                              | 900  | 290.0 | 0 | 130 |           | N/A | N/A | 0  | 0    |
| 1978 | 1240N | 1220W | 31 | 4 |           | 1800                              | 1000 | 331.4 | 0 | 130 |           | N/A | N/A | 0  | 0    |
| 1978 | 1665N | 3900W | 32 | 5 |           | 1800                              | 800  | 265.2 | 0 | 136 |           | N/A | N/A | 0  | 0    |



GRAY COUNTY TREASURER  
 PO BOX 507  
 CIMARRON, KS 67835-0507

**Instructions**  
 DUE DEC 21, 2009  
 NO 2ND HALF NOTICE  
 OLDEST TAX IS PAID FIRST  
 PHONE # TREASURER 620-855-3861  
 APPRAISER 620-855-3858  
 REMIT COUPON with PAYMENT



BEST FARMS, INC.  
 % RENICK, MICHAEL  
 10502 6 RD  
 INGALLS KS 67853-9217

Mail to

**Property Description**  
 Tax Unit 030 Twp-INGALLS TOWNSHIP USD 477  
 CAMA: 069-31-0-00-00-001.00-D  
 SE1/4 31-25-29 153A

**COPY**  
 #70

|                                   |        |
|-----------------------------------|--------|
| Total Tax                         | 287.72 |
| Half due 12/21/2009               | 143.86 |
| CREDIT CARD - Fee Charged to User |        |

| Assessments Class | Land         | Imprv | Tax Year 2009 |               | 2008         | Change     |             |
|-------------------|--------------|-------|---------------|---------------|--------------|------------|-------------|
|                   |              |       | Total         | Tax           | Value        | Value      | %           |
| AG RURAL          | 1,971        |       | 1,971         | 252.87        | 1,695        | 276        | 16.3        |
| GROUNDWATER MGMT  |              |       |               | 34.85         |              |            |             |
| <b>Total</b>      | <b>1,971</b> |       | <b>1,971</b>  | <b>287.72</b> | <b>1,695</b> | <b>276</b> | <b>16.3</b> |

| Your Levies/Taxes       | 2009 Levy      | 2009 Tax      | 2008 Levy      | %Chg       | 2008 Tax      | Change \$    | %           |
|-------------------------|----------------|---------------|----------------|------------|---------------|--------------|-------------|
| USD 477 GENERAL FUND    | 20.000         | 39.42         | 20.000         |            | 33.90         | 5.52         | 16.3        |
| USD 477 OTHER FUNDS     | 26.130         | 51.50         | 18.867         | 38.5       | 31.98         | 19.52        | 61.0        |
| USD 477 RECREATION      | 2.849          | 5.62          | 2.880          | 1.1-       | 4.88          | .74          | 15.2        |
| KANSAS STATE            | 1.500          | 2.96          | 1.500          |            | 2.54          | .42          | 16.5        |
| GRAY COUNTY             | 74.752         | 147.32        | 75.264         | .7-        | 127.58        | 19.74        | 15.5        |
| INGALLS TWP             | .232           | .46           | .215           | 7.9        | .36           | .10          | 27.8        |
| COUNTY LIBRARY DISTRICT | .815           | 1.61          | .813           | .2         | 1.38          | .23          | 16.7        |
| RURAL FIRE DISTRICT     | 2.019          | 3.98          | 1.349          | 49.7       | 2.29          | 1.69         | 73.8        |
| GROUNDWATER MGMT        |                | 34.85         |                |            | 34.85         |              |             |
| <b>Total</b>            | <b>128.297</b> | <b>287.72</b> | <b>120.888</b> | <b>6.1</b> | <b>239.76</b> | <b>47.96</b> | <b>20.0</b> |

| Tax Revenue             | 2009 Revenue     | 2008 Revenue     | \$ Chg        | % Chg      |
|-------------------------|------------------|------------------|---------------|------------|
| USD 477 GENERAL FUND    | 309,595          | 336,502          | 26,907-       | 8.0-       |
| USD 477 OTHER FUNDS     | 422,385          | 330,171          | 92,214        | 27.9       |
| USD 477 RECREATION      | 46,053           | 50,399           | 4,346-        | 8.6-       |
| KANSAS STATE            | 97,111           | 97,153           | 42-           |            |
| GRAY COUNTY             | 4,839,538        | 4,874,788        | 35,250-       | .7-        |
| INGALLS TWP             | 1,548            | 1,564            | 16-           | 1.0-       |
| COUNTY LIBRARY DISTRICT | 30,386           | 30,409           | 23-           | .1-        |
| RURAL FIRE DISTRICT     | 90,556           | 61,163           | 29,393        | 48.1       |
| <b>Total</b>            | <b>5,837,172</b> | <b>5,782,149</b> | <b>55,023</b> | <b>1.0</b> |

Please remit appropriate pa



GRAY COUNTY TREASURER  
 PO BOX 507  
 CIMARRON, KS 67835-0507

**Instructions**  
 DUE DEC 21, 2009  
 NO 2ND HALF NOTICE  
 OLDEST TAX IS PAID FIRST  
 PHONE # TREASURER 620-855-3861  
 APPRAISER 620-855-3858  
 REMIT COUPON with PAYMENT



BEST FARMS, INC.  
 % RENICK, MICHAEL  
 10502 6 RD  
 INGALLS KS 67853-9217

Mail to

**Property Description**  
 Tax Unit 030 Twp-INGALLS TOWNSHIP USD 477  
 CAMA: 069-31-0-00-001.00-C  
 SW1/4 31-25-29 154A

69 ✓

COPY

|                                   |               |
|-----------------------------------|---------------|
| <b>Total Tax</b>                  | <b>350.38</b> |
| Half due 12/21/2009               | 175.19        |
| CREDIT CARD - Fee Charged to User |               |

| Assessments<br>Class | Tax Year 2009 |       |              | 2008          |              |            | Change      |  |
|----------------------|---------------|-------|--------------|---------------|--------------|------------|-------------|--|
|                      | Land          | Imprv | Total Tax    | Value         | Value        | %          |             |  |
| AG RURAL             | 2,466         |       | 2,466        | 316.38        | 2,115        | 351        | 16.6        |  |
| GROUNDWATER MGMT     |               |       |              | 34.00         |              |            |             |  |
| <b>Total</b>         | <b>2,466</b>  |       | <b>2,466</b> | <b>350.38</b> | <b>2,115</b> | <b>351</b> | <b>16.6</b> |  |

| Your Levies/Taxes       | 2009 Levy      | 2009 Tax      | 2008 Levy      | %Chg       | 2008 Tax      | Change \$    | %           |
|-------------------------|----------------|---------------|----------------|------------|---------------|--------------|-------------|
| USD 477 GENERAL FUND    | 20.000         | 49.32         | 20.000         |            | 42.30         | 7.02         | 16.6        |
| USD 477 OTHER FUNDS     | 26.130         | 64.44         | 18.867         | 38.5       | 39.90         | 24.54        | 61.5        |
| USD 477 RECREATION      | 2.849          | 7.03          | 2.880          | 1.1-       | 6.09          | .94          | 15.4        |
| KANSAS STATE            | 1.500          | 3.70          | 1.500          |            | 3.17          | .53          | 16.7        |
| GRAY COUNTY             | 74.752         | 184.33        | 75.264         | .7-        | 159.20        | 25.13        | 15.8        |
| INGALLS TWP             | .232           | .57           | .215           | 7.9        | .45           | .12          | 26.7        |
| COUNTY LIBRARY DISTRICT | .815           | 2.01          | .813           | .2         | 1.72          | .29          | 16.9        |
| RURAL FIRE DISTRICT     | 2.019          | 4.98          | 1.349          | 49.7       | 2.85          | 2.13         | 74.7        |
| GROUNDWATER MGMT        |                | 34.00         |                |            | 34.00         |              |             |
| <b>Total</b>            | <b>128.297</b> | <b>350.38</b> | <b>120.888</b> | <b>6.1</b> | <b>289.68</b> | <b>60.70</b> | <b>21.0</b> |

| Tax Revenue             | 2009 Revenue | 2008 Revenue | \$ Chg  | % Chg |
|-------------------------|--------------|--------------|---------|-------|
| USD 477 GENERAL FUND    | 309,595      | 336,502      | 26,907- | 8.0-  |
| USD 477 OTHER FUNDS     | 422,385      | 330,171      | 92,214  | 27.9  |
| USD 477 RECREATION      | 46,053       | 50,399       | 4,346-  | 8.6-  |
| KANSAS STATE            | 97,111       | 97,153       | 42-     |       |
| GRAY COUNTY             | 4,839,538    | 4,874,788    | 35,250- | .7-   |
| INGALLS TWP             | 1,548        | 1,564        | 16-     | 1.0-  |
| COUNTY LIBRARY DISTRICT | 30,386       | 30,409       | 23-     | .1-   |
| RURAL FIRE DISTRICT     | 90,556       | 61,163       | 29,393  | 48.1  |

