

Soils Map

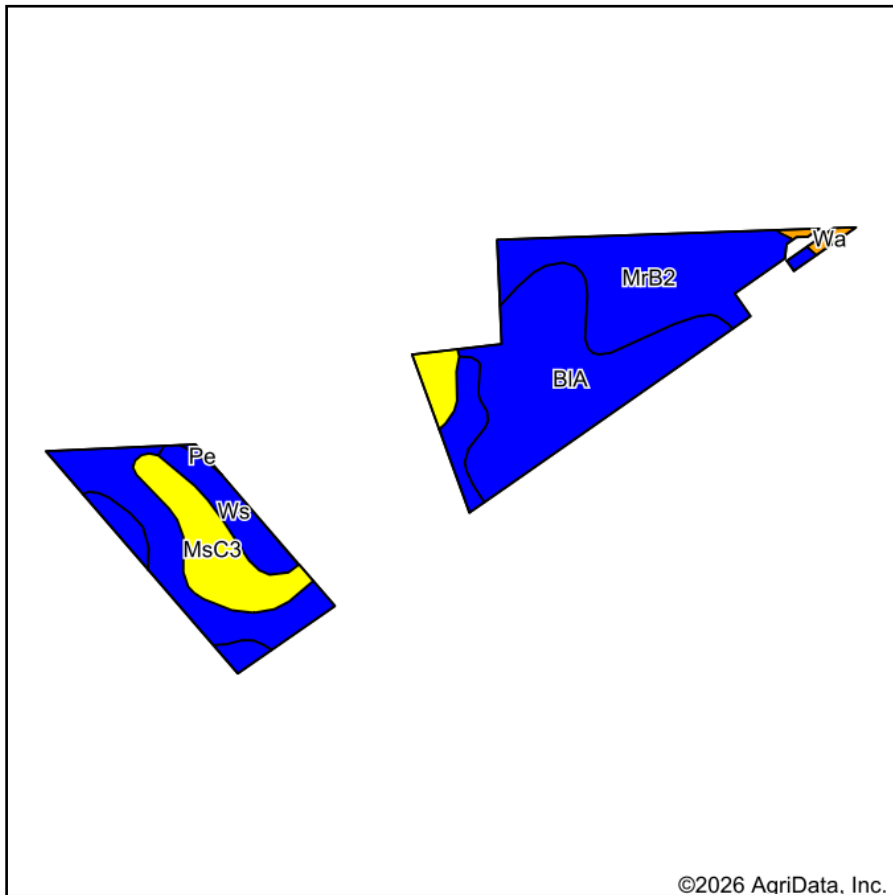

Soils data provided by USDA and NRCS.

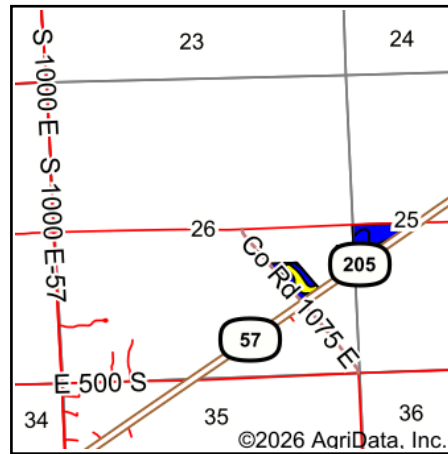

State: **Indiana**
 County: **Noble**
 Location: **26-33N-11E**
 Township: **Swan**
 Acres: **20.37**
 Date: **6/10/2026**



Area Symbol: IN113, Soil Area Version: 31

Code	Soil Description	Acres	Percent of field	Non-Irr Class Legend	Non-Irr Class	Corn	Corn Bu	Corn silage Tons	Grass legume hay	Grass legume hay Tons	Oats Bu	Pasture AUM	Soybeans	Soybeans Bu	Winter wheat	Winter wheat Bu
MrB2	Glynwood silt loam, 2 to 6 percent slopes, eroded	8.97	44.1%		Ile	128	128	1	4	4	5		44	44	57	57
BIA	Blount loam, interlobate moraines, 0 to 2 percent slopes	7.11	34.9%		Ilw	142	142	17	5	5		9	52	52	56	56
MsC3	Morley silty clay loam, 6 to 12 percent slopes, severely eroded	2.90	14.2%		Ive	105	105	15	4	4			37	37	47	47
Ws	Washtenaw silt loam	1.21	5.9%		Ilw	170	170	22	6	6		11	51	51	68	68
Wa	Walkill silt loam, 0 to 2 percent slopes	0.18	0.9%		Illw	142	142		5	5			49	49	3	3
Weighted Average					2.29	132.2	132.2	9.8	4.5	4.5	2.2	3.8	46.3	46.3	55.4	55.4

Soils data provided by USDA and NRCS.