

20.37± Acres Land For Sale

4 Lots Available



LOTS 1-3

LOTS 1-3

LOT 5

DESCRIPTION: Discover **20.37± ACRES** (consisting of four lots) of peaceful land in Noble County, offering the perfect blend of open space and natural beauty on rolling topography. This land offers four potential building sites ranging from 4.00± acres to 7.25± acres - ideal for your new dream home within a rural setting. Deer and turkey have been seen on this land, which makes wildlife viewing a possibility in your backyard. With room for walking trails and outdoor exploration, this Noble County land is simply waiting for your vision!

All Lots are part of The Lake Family Property, located on the Northeast corner of S.R. 205 and County Road 1075 East, Laotto, In 46763.

DIRECTIONS: From the Intersection of S.R. 3 And S.R. 205 In Laotto, IN: Drive Southwest on S.R. 205 for 1.7 Miles to County Road 1075 East. Property is located between County Road 450 South and County Road 1075 East, which has road frontage on S.R. 205.

LIST PRICE: \$420,600.00

(See individual lot prices below)

- **LOT 1: (4.05 Acres) - \$82,900.00**
- **LOT 2: (4.00 Acres) - \$82,900.00**
- **LOT 3: (5.07 Acres) - \$104,900.00**
- **LOT 5: (7.25 Acres) - \$149,900.00**

ADDITIONAL PROVISION: LOTS 2 AND 3 SHALL COMPLY WITH AN ACCESS EASEMENT AND MAINTENANCE AGREEMENT DATED AUGUST 8, 2025.

The information on this sheet is subject to verification and no liability for errors or omissions is assumed by the Schrader Agency.



LOTS 1-3

LOT 3

LOT 5

LAKE - SC03N

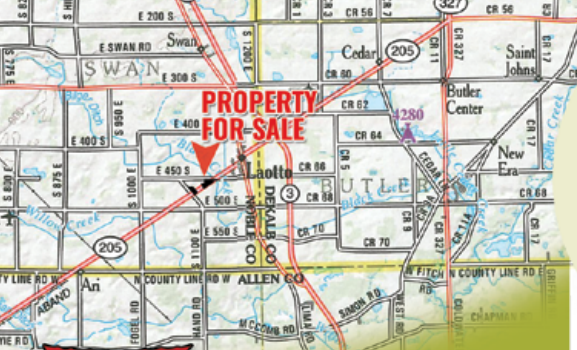

NOBLE COUNTY, IN • SWAN TOWNSHIP

20.37± Acres Land For Sale

4 Lots Available



CORPORATE HEADQUARTERS:
950 N. Liberty Dr., Columbia City, IN 46725

LISTING AGENT:
Steven Coil
260-446-2037
scoil@schraderauction.com

Steven Craig Coil, RB22001310
Schrader Real Estate and Auction Company, Inc., BO090900079
Schrader Real Estate and Auction Company, Inc., BO090700041



800-451-2709
SchraderAuction.com

NOBLE COUNTY, IN • SWAN TOWNSHIP

Land For Sale

20.37± Acres
4 Lots Available

- POTENTIAL BUILDING SITES
- SCHOOL DISTRICT = EAST NOBLE SCHOOL CORPORATION
- ANNUAL TAXES (INCLUDING DITCH ASSESSMENT) = TBD
- FOUR POTENTIAL BUILDING SITES RANGING FROM 4.00± ACRES TO 7.25± ACRES
- ROLLING TOPOGRAPHY

800-451-2709 • SchraderAuction.com

