

# SNELLER RETIREMENT Farm Equipment AUCTION

Wiley, Colorado

Tractors • Tractor & Loader Attachments  
 Combine-Headers-Grain Carts • Tillage Equipment  
 Hay Equipment • Semis and Semi-Trailers • Trailers  
 Planters-Drills • Miscellaneous • Offline Items  
*Very Few Offline Items!*



**LIVE INTERNET BIDDING**  
 Visit [SchraderAuction.com](http://SchraderAuction.com) or  
 call 800-451-2709 for details.



**Thursday MARCH 6**  
 10am MST Start Time

**SCHRADER**  
 Real Estate and Auction Company, Inc.  
 PO Box 508 • 950 N Liberty Dr  
 Columbia City, IN 46725  
 800.451.2709 • 260.244.7606



Follow Us and Get Our Schrader App:  
 Facebook, YouTube, App Store, Google Play

**Auction Manager** Jess Nighswonger  
 303.362.3285  
 FA.100096271

MARCH						
Sun	Mon	Tue	Wed	THU	Fri	Sat
				6	7	8
2	3	4	5			
9	10	11	12	13	14	15
16	17	18	19	20	21	22
23	24	25	26	27	28	29
30	31					

2.5% Buyer's Premium capped at USD \$750 per item added to all winning bids.  
 TERMS: Cash or check with proper ID. Additional 3% surcharge for credit cards. Announcements made day of auction take precedence. Not responsible for accidents.

**800.451.2709**  
**SchraderAuction.com**

# SNELLER RETIREMENT Farm Equipment AUCTION

Wiley, Colorado



**LIVE INTERNET BIDDING**  
 Visit [SchraderAuction.com](http://SchraderAuction.com) or  
 call 800-451-2709 for details.

10am MST Start Time  
**Thursday MARCH 6**

# SNELLER RETIREMENT Farm Equipment AUCTION

Wiley, Colorado



**Thursday MARCH 6**  
 10am MST Start Time

Tractors  
 Tractor & Loader Attachments  
 Combine-Headers-Grain Carts  
 Tillage Equipment  
 Hay Equipment  
 Semis and Semi-Trailers  
 Trailers  
 Planters-Drills  
 Miscellaneous  
 Offline Items  
*Very Few Offline Items!*



**LIVE INTERNET BIDDING**  
 Visit [SchraderAuction.com](http://SchraderAuction.com) or  
 call 800-451-2709 for details.



**800.451.2709 • SchraderAuction.com**



# SNELLER RETIREMENT Farm Equipment AUCTION

Wiley, Colorado

## Thursday MARCH 6

10am MST Start Time

**LIVE INTERNET BIDDING**  
Visit [SchraderAuction.com](http://SchraderAuction.com) or call 800-451-2709 for details.

Very Few Offline Items! Be on Time!

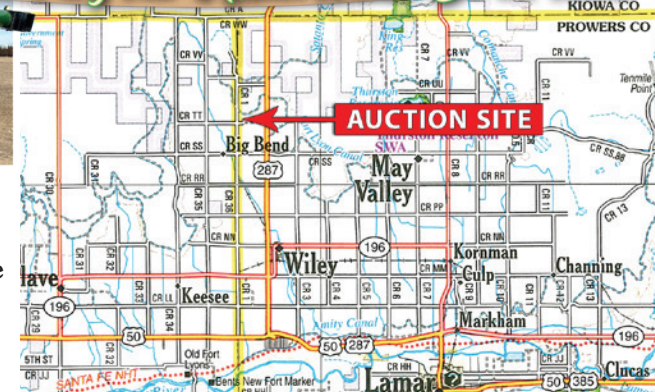

### TRACTORS

- **CAT Challenger 45 Track Tractor**, 30" tracks, 3 remotes, pto, 5052 hrs

- **CAT MT765 Challenger**, 24" tracks, 20 Front weights, Front Idler weights, 5 Remotes, 1000 pto, 3 pt., quick hitch, 5755 hrs
- **John Deere 4960 Tractor**, Powershift, 3 remotes, Big 1000 pto, 12 front weights, rear inner weights, 14L-16.1 fronts, 18.4-42 rear duals, 5513 hrs
- **John Deere 4560 Tractor**, Powershift, 3 remotes, Big 1000 pto, 3 pt., 12 front weights, outer rear weights, 14L-16.1 fronts, 18.4-42 rear Firestone duals, 4468 hrs
- **John Deere 7210 MFWD tractor**, Quad range, left hand reverser, 2 remotes, 1000 pto, 3 pt., 14.9R28 fronts, 18.4R38 rears, rear inner weights, JD 740 loader w/material bucket, 3772 hrs.
- **John Deere 7410 Tractor**, Powershift, 3 remotes, 1000 pto, 11.00-20 SL fronts, 18.4-42 Firestone rear duals, 8 front weights 5385 hrs
- **John Deere 4430 Tractor**, Quad range, 3 remotes, 540/1000 pto, 3 pt., 16.9-38 rears, shows 1545 hrs
- **2004 CAT 924G Loader**, Quick Attach., Aux. hyd., 92" 2.0 cu. yd. Material bucket, Michelin 17.5R25 Tires, 1309 hrs

### TRACTOR & LOADER ATTACHMENTS

- **CAT 2.7 cu. yd Bucket**, 99" wide, teeth w/cutting edge, quick attach.
- **CAT Quick Attach. Loader Pallet forks**, 48"
- **CAT Quick Attach 5 prong bale fork**

- **3 pt. Big Square Bale Mover**
- **Big Square Bale Mover**, (fits JD 740 loader)

### COMBINE-HEADERS-GRAIN CARTS

- **Case IH 2366 Axial Flow Combine**, 3455 engine hrs., 2660 sep. hrs., Gordon Harvesting Helical Concave
- **Case IH 1083 Cornhead**
- **25' Case IH 1010 Grain Table**
- **Brent 674 Grain Cart**, corner auger, adjustable spout, roll tarp, 1000 pto, auger light
- **John Deere 500 Grain Cart**, 1000 pto, tarp, center auger

### TILLAGE EQUIPMENT

- **9 Shank Deep Ripper**
- **7 Shank Big Ox Deep Ripper**, 3 pt., gauge wheels, new shovels
- **IH 4 Bottom Over Under Plow**
- **35' Quinstar Chisel**, 21 Shank, Hyd. Fold, (4) Quinstar bolt on Reel Baskets
- **33' John Deere 726 Finisher**, RockFlex, 7.5" spacing, Spring Reset, 5 bar tine harrow
- **22.5' John Deere 2720X Disc Ripper**, Rock Flex, Hyd. Rolling Basket, Rear Hitch and Hyd., -less than 200 acres
- **FarmHand 9 Shank Disc Chisel**, walking tandem
- **24' Unverferth 1245 Rolling Harrow**, Double Basket, Tine Harrow
- **35' Sunflower Flex-King Plow**, Spike Harrow, Double Fold
- **35' Sunflower 1435 RockFlex Disc**, 9" spacing, tandems on the wings, gauge wheels, hyd. angle adj.
- **28' CrustBuster Double Offset Wing Fold Disc**, 9" spacing
- **18' Miller Disc**, Offset, 8" Spacing

- **30' Great Plains Turbo-Max Vertical Till**, Rock Flex, Spike Harrow, Rolling Basket, new front blades, hyd. adjust gangs
- **28' Danish Tine Field Cultivator**, 3 Bar tine harrow, rear hitch and hyd.
- **25' Case IH Cultimulcher**, Rear Hitch, scrapers
- **John Deere 885 Cultivator**, 3 pt., wide shovel, spring reset
- **John Deere 825 Cultivator**, 3 pt.
- **20' John Deere 400 Rotary Hoe**
- **8 Row Muth Furrowing Bar**, 30" spacing, w/markers, 3 pt
- **14 Row Muth Furrow Bar**, 18" spacing, w/markers, 3 pt.

### HAY EQUIPMENT

- **Massey Ferguson WR9980 Swather**, 425 hrs., Twin Max Razor Bar Rotary Head, 16', Comfort Ride Cab
- **(2) H&S HD II 17 Wheel Hay Rake**, walking tandem, hyd. Adjustment
- **Massey Ferguson 2190 Big Square 4'x4' Baler**, Monitor, Accumulator (grey), 25219 bales, 957.4 hrs., new tires 2024
- **Massey Ferguson 2190 Big Square 4'x4' Baler**, Monitor, Accumulator (red), 27449 bales, 1025.8 hrs., tires are 2 years old

### SEMIS AND SEMI-TRAILERS

- **2010 Kenworth W900**, CAT C-15, 18 spd., 24.5 tires, shows 1,128,300 mi., less 100,000 mi. on overhaul
- **2006 Kenworth T800**, CAT C-13, 10 spd., Air Ride, Wet Kit, 22.5 front tires, 22.5 rears, 397958 mi.
- **2006 Kenworth T800**, CAT C-13, 10 spd., Wet Kit, 22.5 fronts, 22.5 rears, Air Ride, 478287 mi., (odometer has been changed at 328182)

- **1995 Kenworth T800**, Cummins M11-330E, 9 spd., Wet Kit, 22.5 steer tires, 24.5 rear tires, 750032 mi., 20,000 mi. on overhaul
- **1997 Ford Louisville Fertilizer Spreader Truck**, Auto. Trans. 44366 mi., 5714 hrs, Doyle bed and controller, twin spinner, 48-25.00-20 fronts, 66-43.00-25 rears
- **1974 Ford LNT880 Tandem Grain Truck**, 534 V8 Gas, 5+2 trans., 10.00-20 front and rears, 20' bed, shows 17510 mi.
- **2022 36' Hitchcock APL Silage Trailer**, 24.5 tires, Air Ride
- **2008 36' Hitchcock Semi Silage trailer**, 11R24.5 tires
- **42' 1987 Timpfe Hopper Bottom**, 2 compartment, Spring Ride
- **40' 1981 Timpfe Hopper Bottom**, 2 compartment, Spring Ride, 24.5 tires
- **2013 Transcraft Eagle II Flatbed Aluminum Semi Trailer**, Spreader Axle, Air Ride, Sliding Ratchets, 11R22.5 Tires, Outside Aluminum Rims
- **1998 Transcraft Eagle Flatbed Aluminum Semi Trailer**, Spread Axle, Air Ride, 8 Aluminum Rims, 24.5 tires

### TRAILERS

- **2013 7' x 22' PJ Tandem Axle Trailer**, 8 bolt rims, rear jacks
- **2011 Mission Ride on Ride off 4 Place Snowmobile Trailer**, 8' x 21.5' on the square, 26' overall at the V, Torsion Axles, 2 interior cabinets, roadside entrance door and gas door

### PLANTERS-DRILLS

- **John Deere 1770NT Planter**, 16 Row
- **(2) John Deere 7100 8 Row Planter**, Seed and insecticide boxes, 3 pt., markers

- **30' CrustBuster 4030 Drill**, 7.5" Spacing, markers
- **30' Great Plains Multi-Flex Hoe Drill**, markers, 12" spacing
- **20' Great Plains 2000 3 pt Drill**, 6" spacing, markers, only 1102 acres

### MISCELLANEOUS

- **10.5' John Deere 1018 Rotary Mower**, 1000 pto
- **10.5' John Deere 1008 Rotary Mower** (Parts only)
- **10' John Deere 165 Grader Blade**, hyd. angle and tilt, 3 pt.
- **12' Box Blade**, Hyd. Lift
- **(3) Ditch A**, 1 with cylinder, 1 for parts, pull type
- **3 pt. Track Closer w/ 24" rear drum**
- **(2) 30' Drag Harrow**
- **24' Schmeiser Land Plane**, 18" Steel Bogie Rollers
- **18' x 30' Land Plane**
- **13.5' Crowsfoot Packer**, 7.5' Crowsfoot & 6.5' Crowsfoot packers
- **2005 Ingersoll-Rand Air Source Plus Diesel Air Compressor**, 791 hrs
- **16' Brillion Flail Mower**, 1000 pto, hyd. raise
- **Shop Built Weed Burner**, tandem axle trailer, 500 gal. tank, hyd. pivot, hyd. raise on burner arm
- **Ren 30" Roller Mill**, 540 pto

### OFFLINE ITEMS

- **Massey Ferguson 588 6 Bar V Hay Rake**, Hyd. Drive
- **John Deere 700 6 Bar V Hay Rake**, Hyd. Drive
- **(44±) 10" Irrigation Pipe w/ Yellow Trailer**, (1) has elbow
- **(47±) 10" Irrigation Pipe w/ grey trailer**
- **Irrigation Pipe Trailer**
- **46' 500 Gal. Tandem Axle Sprayer**, 20' booms

**Retirement Note:** We are pleased to announce the upcoming retirement farm equipment sale of Jay and Maralyn Sneller. The Snellers have decided to retire after an illustrious 50-year career in farming.

Jay Sneller has been a pioneer in the agricultural community, being one of the first to implement center pivot irrigation. This innovative approach not only revolutionized his farming practices but also set a benchmark for others to follow.

Throughout their farming years, Jay and Maralyn took exceptional care of their equipment, with most of it being meticulously stored indoors. This attention to detail ensures that the equipment available for sale is in outstanding condition, promising reliability and longevity for the new owners.

Beyond their contributions to farming, the Snellers have been great members of the community, known for their dedication and support. Their retirement marks the end of an era, and this sale is a unique opportunity to acquire well-maintained equipment from a respected source.

We invite you to participate in this significant event and take advantage of the high-quality equipment on offer. Your involvement is much appreciated, and we look forward to your presence at the sale.



**Owner: Jay and Maralyn Sneller**

**Inspection Date:**  
**Thursday, February 20**  
**from 12:00 - 2:00pm**

**All Items Must Be Removed by March 15, 2025**

The "Auction Terms" and any other terms regarding bidding, inspections, buyer's premium, time and methods of payment, charges, pickup, loadout and/or other terms of sale set forth in the auction brochure and/or auction website for this particular auction, as updated by any official announcement made by the auctioneer prior to bidding and/or posted to the online bidding platform prior to bidding.

All items are sold "AS IS", without any warranty of any kind. Payment is due by the end of the (2nd) business day after the auction. Buyer is responsible for picking up, loading out and removing all purchased item(s), at Buyer's risk and expense, within the time specified above (but not before payment in full). If any purchased item is not paid for and removed (or paid for but not removed) within the time specified above, Buyer agrees to pay: (a) an administrative fee equal to the greater of \$100 or 25% of the winning bid price (up to \$1,000); plus (b) a storage

fee of \$25 per day until the item is paid for and removed, plus (c) any other damages and/or expenses (including attorney fees) incurred by Seller and/or Auction Company in connection with or resulting from Buyer's breach. Without limiting any other remedy, Buyer agrees that the purchased item may be resold due to Buyer's breach. As a pre-condition to bidding, you must provide your credit card information and authorization for a valid credit card with at least \$2,500 of available credit. By registering to bid and/or submitting a bid, you

authorize and agree to the following charges against your credit card (automatically and without further notice): (i) any unpaid balance due on your winning bid(s) if and to the extent the entire amount due on your winning bid(s) is not otherwise paid in full within the time specified above; and (ii) any administrative fee, storage fee, and/or other damages and/or expenses due in accordance with the foregoing provisions.

**Auction Manager:**  
**Jess Nighswonger**  
303.362.3285  
800.451.2709  
[SchraderAuction.com](http://SchraderAuction.com)

**SCHRADER**  
THE ORIGINAL MULTI-TRACT AUCTIONS

TIMED ONLINE ONLY  
VIRTUAL  
LIVE WITH ONLINE