

Elkhart County
Middlebury, IN

WEIRICH RETIREMENT AUCTION

Friday, December 13 • 9:30am



December	Su	M	Tu	W	Th	F	Sa
	1	2	3	4	5	6	7
	8	9	10	11	12	13	14
	15	16	17	18	19	20	21
	22	23	24	25	26	27	28
	29	30	31				



Corporate Headquarters:
950 N Liberty Dr, PO Box 508
Columbia City, IN 46725

AUCTION MANAGER:

Robert Mishler • 260.336.9750 #AU08701553
Schrader Real Estate and Auction Company, Inc. #AC63001504

Follow Us On: Get Our iOS App:



TERMS: Cash or Check, 3% on Credit Card. Announcements made the day of the auction take precedence over any printed material, & oral statements made. Lunch Available. Not Responsible for Accidents.



800.451.2709 • www.SchraderAuction.com

Elkhart County
Middlebury, IN

WEIRICH RETIREMENT AUCTION

Friday, December 13 • 9:30am



• TRACTORS • BOBCAT • COMBINE • HEADS • PLANTER • DRILL • TILLAGE EQUIP. • TRUCKS • HAY EQUIP.
• WAGONS • FARM EQUIP. • BROCK DRYER BIN • WIRE CORN CRIBS • SILO • CATTLE EQUIP. • MISC.



800.451.2709 • www.SchraderAuction.com



Elkhart County
Middlebury, IN

WEIRICH RETIREMENT AUCTION

Friday, December 13 • 9:30am

- TRACTORS
- BOBCAT
- COMBINE
- HEADS
- PLANTER
- DRILL
- TILLAGE EQUIP.
- TRUCKS
- HAY EQUIP.
- WAGONS
- FARM EQUIP.
- BROCK DRYER BIN
- WIRE CORN CRIBS
- SILO
- CATTLE EQUIP.
- MISC.



800.451.2709 • www.SchraderAuction.com



WEIRICH RETIREMENT AUCTION

Friday, December 13 • 9:30am

AUCTIONEER'S NOTE: Don't miss the opportunity to bid on this well-maintained line of equipment that is field ready!
SALE ORDER: Wagon of Misc. > Farm Misc. > Farm Equipment > Online

LOCATION: I3272 Co Rd 20, Middlebury, IN 46540 • 1 mile south of Middlebury, IN on SR 13 to CR 20 then west 1 mile to auction.

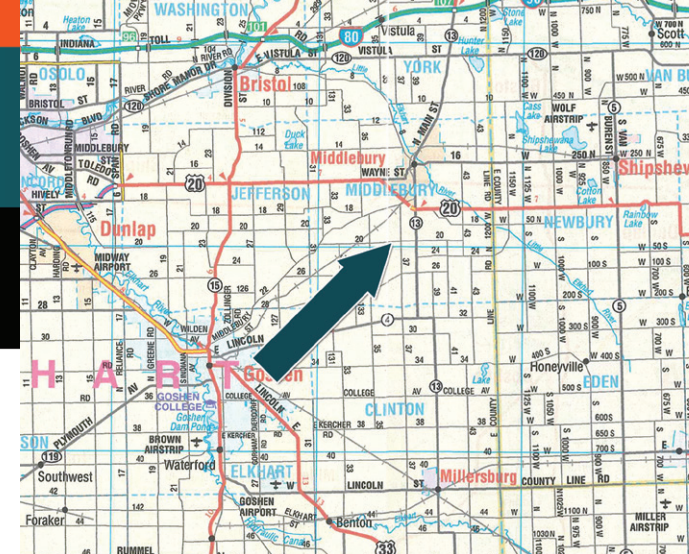

TRACTORS • BOBCAT

- 1996 AgCo Allis 9675 MFWD, 18 speed power shift, 3 remotes, 1000 pto, QH, 18.4-46 axle duals, 16.9-30 front, 4983 hours, #972396D
- 1975 White 2-105 cab, 2 remotes, 540 and 1000 pto, very good 18.4-38 radials, #264092
- Clark 742 Skid steer gas, quick tach, ax hydra #5018MI5165

COMBINE • HEADS

- Allis Chalmers M3 combine diesel, hydro, newer 23.1-30 BKT tires, 11:00-16SL, chopper, #MK 24738H-83
- Allis Chalmers 315 15' grain head, good poly fingers, quick cut sickle, head runs smooth
- Kory 5566 head cart
- Allis Chalmers 630A corn head 6 RN inter-meshing rolls, newer chains and sprockets, only ran approx 50 acres of corn each year, #11007
- Kory Head cart
- New Idea 844N 4 row 30" corn head

PLANTER • DRILL

- Deutz-Allis 385 Quadra Disc 6 RN planter, no-till frame, 2x2 in furrow pop up, no-till Yetter openers and row cleaners, iron is very good, low acres on planter, bought new,
- Noble 6 row Danish tine cultivator, 5 shank
- IH 10 grain drill 16 run 7" spacing double disc and chains with grass seeder, #10802

TILLAGE EQUIPMENT

- Glencoe Farmhand 1231 9 shank 4" twist shovels with hardened points, 5 bar spike harrow, walking tandem, hydra adjust disc
- Sunflower 1232-24 rock flex disc, 24', 21 1/2 front, 21 3/4 rear blades, duals wheels on main frame and wings, rear hitch & hydra
- Case IH 110 crumbler, 26', spring baskets
- Unverferth Zone Builder, 3pt, 4 shank, 30', spring reset, coulters, gauge wheels
- Brillion 10 1/2' solid packer with 4" axle

TRUCKS

- 2001 IH 4700 Lo Pro truck, DT444E diesel, auto trans, Omaha 12' bed hoist, 52" sides, cargo doors with grain doors, tarp, shows 104,000 miles
- 2001 GMC 2500 ext cab, 4x4, 6.0 V8 gas, auto trans, 6'6" bed, 221,000 miles

HAY EQUIPMENT

- New Holland 1465 9' haybine, very good rolls, #602384
- Pequea 7' pto hay fluffer
- Miller Pro 1100 rotary rake, 10', 540 pto, hydra lift walking tandems
- New Holland 273 Hayliner baler, super sweep 540 pto, very nice, #443509
- 14' hay rack wagon
- Kory 6072 7 1/2 x15' heavy wood bed

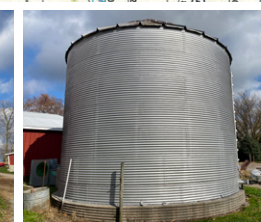
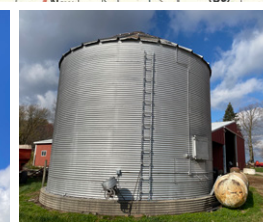
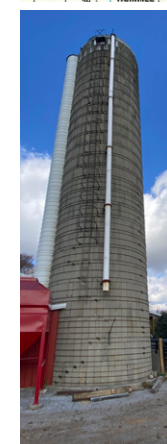
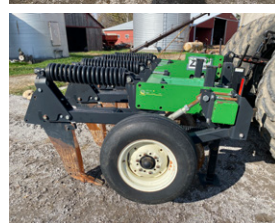

WAGONS

- Killbros 350 gravity wagon, on Farmers Pride 10 ton gear, 10:00-15 tires and extendable tongue
- McCurdy gravity wagon on Kory 6072 gear 10:00-15 tires and extendable tongue
- Farmers Pride 10 ton gear with extendable tongue, gear only
- Parker gravity wagon on Kory 6072 10 ton gear
- Small gravity wagon on Spreuer gear

FARM EQUIPMENT

- Brillion FS1445 12' flail mower, very nice, newer knives, original paint, always shedded
- Kewanee 500 dble 40' chain elevator
- Hutchinson 6"x48' pto auger
- Corn drag 10 flat
- 35' single chain elevator on transport with elec motor
- Bin Grain spreader

BROCK DRYER BIN • WIRE CORN CRIBS • SILO • CATTLE EQUIPMENT

- Brock 7000 bu. Grain bin, new Sukup 2 auger stirator, air floor, spreader with Sukup LP gas dryer 7 1/2 hp, 5,000 bu up to the stirator
- 3 Pioneer 1000 bu. Wire corn cribs
- Cement stave 16x70 silo, new chute
- Hanson radial drive silo unloader
- Cattle squeeze head chute
- Gehl 125 Mix All grinder mixer, 21" grinder, 19' folding auger, working scales, hydra augers, extra screens, #MX125 14185

MISCELLANEOUS

- L-110 gal. fuel tank with pump
- (2) 150 Desa kerosene heaters
- 105 gallon N tank
- Ground drive fertilizer unit
- 4" chisel points, new
- Cultivator points, new
- 2 shop lights
- Troy-Bilt walk behind tiller
- 500 gal. LP tank
- Stack of rough sawn lumber
- ATV sprayer
- Acid tank for baler
- LP cattle tank heater
- Fertilizer transfer pump
- Fertilizer mix tank
- 40' 1/2" grade 100 chain, new, never used, with 4 new hooks
- 20' grade 80 chain

ADDED EQUIPMENT

- Meyer Super Spreader Industrial 5570 V bottom Spreader, Vertical beaters, 1000 pto, 425/65R-22.5 tires, good condition
- H+S Hay Merger, 9' pickup belt, hydra swing hitch, #85M9
- Brillion 23' Crowfoot packer
- Killbros 350 gravity wagon on Killbros running gear
- Gehl 95 MixAll grinder/mixer

INSPECTION DATES:
Fri, Dec. 6 • 3-5pm &
Thu, Dec. 12 • 2-5pm