

# Crossley Farms LLC RETIREMENT AUCTION

**SCHRADER**  
Real Estate and Auction Company, Inc.

CORPORATE HEADQUARTERS:  
950 N. Liberty Dr., Columbia City, IN 46725  
CENTERVILLE, IN OFFICE:  
300 N. Morton Ave. Centerville, IN 47330

**AUCTION MANAGER:  
ANDY WALTHER,  
765-969-0401**

AC63001504, AU19400167



Follow us on:

**800-451-2709**

**SchraderAuction.com**

**LIVE INTERNET BIDDING**  
Visit [SchraderAuction.com](http://SchraderAuction.com) for Details  
or call 800-451-2709.

*Wayne County, IN*

DECEMBER 2024						
SUN	MON	TUE	WED	THU	FRI	SAT
1	2	3	4	5	6	7
8	9	10	11	12	13	14
15	16	17	18	19	20	21
22	23	24	25	26	27	28
29	30	31				

*Wayne County, IN*  
5225 Sugar Grove Rd., GREENS FORK, IN 47345



# Crossley Farms LLC RETIREMENT AUCTION

**WEDNESDAY, DECEMBER 4<sup>TH</sup> • 10:30 AM**



**PREVIEW:**  
10 AM - 1 PM  
Friday, November 29<sup>th</sup>  
Tuesday, December 3<sup>rd</sup>

TRACTORS • LOADER • COMBINE & AUGER CART  
KINZE PLANTER • SEED TENDER • APPLICATOR  
TILLAGE EQUIPMENT  
SEMI-TRACTOR • TANKER • STRAIGHT TRUCK  
SKID LOADER • MANURE SPREADER • ROTARY MOWER

**LIVE INTERNET BIDDING**  
Visit [SchraderAuction.com](http://SchraderAuction.com) for Details  
or call 800-451-2709.

Owner: Tim and Lisa Crossley (Crossley Farms LLC)  
Auction Manager: Andy Walther, 765-969-0401

**800-451-2709 | SchraderAuction.com**

**SCHRADER**  
Real Estate and Auction Company, Inc.



*Wayne County, IN*

TRACTORS • LOADER • COMBINE & AUGER CART  
KINZE PLANTER • SEED TENDER • APPLICATOR  
TILLAGE EQUIPMENT • SEMI-TRACTOR • TANKER • STRAIGHT TRUCK  
SKID LOADER • MANURE SPREADER • ROTARY MOWER

**LIVE INTERNET BIDDING**  
Visit [SchraderAuction.com](http://SchraderAuction.com) for Details  
or call 800-451-2709.

# Crossley Farms LLC RETIREMENT AUCTION

**WEDNESDAY, DECEMBER 4<sup>TH</sup> • 10:30 AM**

**800-451-2709 | SchraderAuction.com**

**SCHRADER**  
Real Estate and Auction Company, Inc.



# Crossley Farms LLC RETIREMENT AUCTION

WEDNESDAY, DECEMBER 4<sup>TH</sup> • 10:30 AM

Wayne County, IN – 5225 Sugar Grove Rd., GREENS FORK, IN 47345



PREVIEW:  
10 AM - 1 PM  
Friday, November 29<sup>th</sup>  
Tuesday, December 3<sup>rd</sup>



## TRACTORS • LOADER

- **2015 Case IH Magnum 340 Rowtrac**, only 4,738 hrs, 18 speed Powershift transmission, (90%) 24" tracks on 76" spacing and (85%) front 420/85R38, class 5 front axle, High capacity hydraulic pump, front weights, cab suspension, 4 SVC remotes, large 1000 PTO, heavy category 4 drawbar, 3pt, power beyond, mirrors, beacon light, HID/ LED light package, leather luxury cab interior, and Case guidance (Pro700 RTK, 372, Nav3). Tracks, and undercarriage (boggies, idlers, bearings and seals) were replaced about 300 hours ago at local dealership). The tractor has been well maintained been used for tillage and is field ready.
- **2016 Case IH Magnum 310 CVT**, with only 1,781 hrs. Tractor is immaculate and like new. CVT transmission, suspended front axle, high capacity hydraulic pump, front and rear weights, cab suspension, and like new Michelin tires all around with front and rear duals. (5) SVC remotes, changeable PTO, heavy drawbar, 3pt with quick hitch, power beyond, power mirrors, beacon light, HID/ LED light package, leather luxury cab interior, and Case guidance ready with a Pro700 waas and Case IH 372/Nav2 Receiver.
- **2016 Case IH Magnum 280**, with only 3,688 hrs., Powershift transmission, front and rear weights, cab suspension, and like NEW Mitas rear & front tires, (4) SVC remotes, 1000 PTO, heavy drawbar, 3pt with quick

hitch, power beyond, mirrors, beacon light, nice factory light package, deluxe cab interior, and full Case guidance ready with 262/Nav3 Receiver and Pro700 waas.

- **2015 Case IH Magnum 250** with 4,868 hrs, 18 speed Powershift transmission, front and rear weights, and like new 520/85R46 Michelin tires on the rear with duals, and like new 480/70R34 Continental tires on the front. (4) SVC remotes, changeable PTO, heavy drawbar, 3pt with quick hitch, power beyond, mirrors, beacon light, deluxe factory light package, deluxe cab interior with heated seat, and Case guidance (Pro700 Omnistar, 372, Nav3). Tractor has always been kept inside, always serviced and was our planter tractor. Field ready.
- **1977 International 1086**. Starts great, runs out great, shifts great, TA is strong with 6,715 original hrs. 18.4x38 Firestone 23 degree Radials, 40%, has good rear rims, 4 rib front tires, new cab kit. It was restored about 15 years ago and has always been shedded and maintained. \*weights sold separately. \*\*9 bolt hubs and Firestone 18.4x38 duals (hubs and duals) will sell separately.
- **Black Stripe 766 International**. Believed the tractor has original paint and decals. 18.4x38 BF Goodrich rear tires with 80% tread, rims are in great shape, differential lock. Starts, Shifts & runs great, strong TA. \*Loader will be sold separately.
- **1953 Farmall Super H**. Everything works terrific, is a beautiful collector tractor. It was a very high end restoration right down to the harness. Starts and drives great, no smoke. Rear wheels are excellent. Base coat/clear coat with the decals being under the clear coat. It is truly hard to find one this nicely restored. The hand crank is included and functions as it should.
- **1945 Farmall H**. Starts great, runs and shifts great, no smoke or knocks. Starts every time! Rear wheels are in great shape, front tires are new. Excellent restoration project or use as is.
- **Westendorf quick attach loader** with brackets to fit anything from 460-1086 per the manual. Comes with quick attach dirt bucket, pallet forks and owners man-

ual with mounting instructions. Always stored inside. This will be off of the tractor and ready to load on your trailer prior to the auction.

## COMBINE & AUGER CART

- **2013 7230 Combine** with 1,650 engine hrs and 1,195 separator hrs and has the 'new style cab' with stadium lighting and power mirrors. Front Firestone 1250 float-er tires with brand new rear BKT 28L-26 radials. 4wd with 2 speed powered rear axle. Combine has independent crops auger control, Rock Trap, extended wear large tube rotor, extended wear cone, extended wear unloader for 40ft head, self leveling grain pan with bearing updates, electric adjust concave and sieve, and dual disc rear spreader. Combine has a chopper, factory manual hopper extension, heavy duty feederhouse with header tilt, extended wear components, extended wear 2 speed elevator, extended wear top auger, round bar, and extended wear feederhouse chain. Interior is leather luxury cab with full Case guidance.
- **2013 Drago Series 2 Corn head** for Flagship Case IH combine. 8x30. Automatic adjusting stripper plates, knife rolls, great shape, always shedded.
- **Case IH 2162 35ft Draper head**. Like new side belts, poly skid pads, and center belt / guards / sections. Head has auto header height control / lateral tilt, full hydraulic reel adjustment, and head is single drive. Setup for flagship combine. The reel, center drum, plastic end covers, and reel fingers are excellent. Everything works just like new and has been very well maintained. This head is exceptionally nice and field ready.
- **1015 Unverferth auger cart**. New 900/60/32 Mitas tires, roll tarp, great paint, great flight, very little use always shedded. 1000+ bushel capacity, rotating spout, long reach unload, unloads at 620 bu per minute (per Unverferth).
- **KINZE PLANTER • SEED TENDER • APPLICATOR**
- **2013 Kinze 3600**, 16/31 ASD. This planter is very tight, very straight and in very good shape with bean meters only. 600 acres on new 60 cell discs and seed disc openers. KPM3 monitor, Kinze fold box. This planter is spring down pressure, and fully mechanical. It is also equipped with pneumatic down pressure if that's your preference (currently being used with spring down pressure).

- **2750 Unverferth Seed Runner**. Electric start, 2 bin, good roll tarp, remote control, tool box, scales work, brakes work, all lights work, pulls great, self loading, also has spout to fill box planters. Holds approx 275 seed units.
- **Ag Systems Model 6400**, 15 coulter, 16 row hydraulic drive fertilizer applicator. Raven 440 Controller. Always shedded and oiled when not in use. 1200 gallon tank, adjustable axles for 30" or 36" rows. 320/85/38 radial tires like new, high ground clearance with gauge wheels on wings and the wings are weighted for penetrating hard soils.

## TILLAGE EQUIPMENT

- **2015 30' Great Plains Turbo Max**. Adjustable gangs from 0-6 degrees, Model 3000TM, weight package, newer tires, wing down force, good blades, good star harrow, good rolling basket, rear hitch and auxiliary hydraulic for additional implement.
- **21' Landoll Tilloll 875-21 (later model)**. New shovels now, rebuilt all 4 wing cylinders in '23 as well as other wear parts. Very good condition. Disc blades, shanks, springs, reel and 3 bar spike tooth harrow all in good shape. Always shedded, tires and all bearings are in good shape. Field ready.
- **M&W SLR5 5 shank inline ripper** with spring reset shanks, coulters and gauge wheels. It's in great shape with like new coulters, shins and points.
- **5 shank V-ripper Landoll model 600**. Has gauge wheels, harrow and like new points. It works great!
- **SEMI-TRACTOR • TANKER • STRAIGHT TRUCK**
- **2014 Freightliner Cascadia**, 508k miles, DD13, 450HP, 10 speed automatic (NO clutch pedal), air ride suspension, air ride cab and seat, DISC brakes, sliding 5th wheel, differential lock, suspension dump, air, tilt cruise, power mirrors, newer virgin rubber all around, dual fuel tanks, 2nd Owner and the truck drives out great! All service records for the truck since it sold new are available.
- **1983 Brenner conical fertilizer tanker**. Holds 6,300 gallon, center 3" discharge (current pump and hoses are 2"), insulated with stainless skin, 304SS tank, virgin 455/50/22.5 Michelin radial super singles for reduced compaction (75% tread). Stainless front and rear sub-frames, leak/pressure tested a few years ago as preventive maintenance, good brakes, good fifth wheel plate, good spring suspension. We only used the trailer to pull from out tanks to the applicator however it would work well as a commercial hauler. The tank

is non-baffled however baffles can be easily added.

- **1995 Chevrolet Kodiak 6500**. 366, 5/2 speed with 163,xxx miles on it. The truck drives out really well. For the last 13+ years we've used the truck to haul fertilizer and seed to the planter and to tender the applicator on small fields. It sells with a 1600 gallon tank, 2" pump and plumbing that is attached. The cab and frame are in great shape, the tires and wheels are in great shape (no tire cupping and have great tread), the pump always starts. Always shedded, washed and oiled when not in use. The bed has rust on the outer sides however the bed frame is solid and works as it is (the rust on the bed was present when we bought it).

## SKID LOADER • MANURE SPREADER • ROTARY MOWER

- **New Holland LS125 Diesel**, water cooled, 700# lift capacity, block heater, 693 actual hours. it's always been shedded, well maintained and the lift arms are very tight. No welds or cracks.
- **NH Compatible Pallet forks** and manure bucket.
- **New Holland 145 Manure spreader** used very little since new. original poly floor, always shedded, cleaned and oiled after each use, like new.
- **Land Pride 5015**, 15' bat wing rotary mower, has newer airplane tires, chains front and rear, stump jumpers.

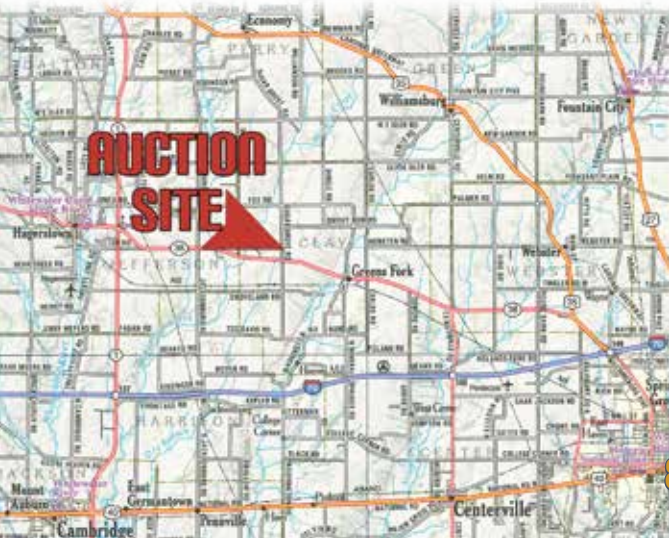

Owner: Tim and Lisa Crossley (Crossley Farms LLC)  
Auction Manager: Andy Walther, 765-969-0401

800-451-2709 | [SchraderAuction.com](http://SchraderAuction.com)

**SCHRADER**  
Real Estate and Auction Company, Inc.

**LIVE INTERNET BIDDING**  
Visit [SchraderAuction.com](http://SchraderAuction.com) for Details  
or call 800-451-2709.