

Soils Map

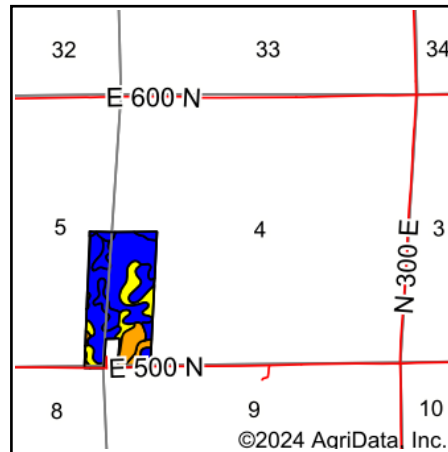

State: **Indiana**
 County: **Noble**
 Location: **4-34N-10E**
 Township: **Jefferson**
 Acres: **64.27**
 Date: **10/17/2024**

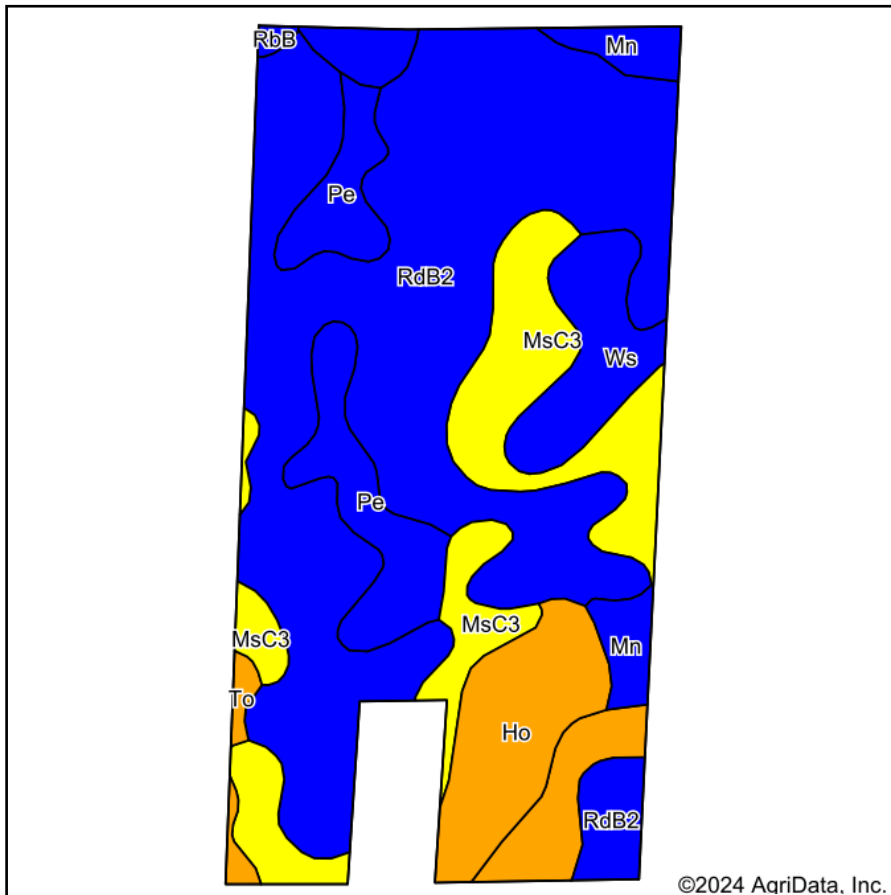

Soils data provided by USDA and NRCS.

Area Symbol: IN113, Soil Area Version: 29

Code	Soil Description	Acres	Percent of field	Non-Irr Class Legend	Non-Irr Class	Corn Bu	Corn silage Tons	Grass legume hay Tons	Grass legume pasture AUM	Pasture AUM	Soybeans Bu	Winter wheat Bu
RdB2	Rawson, Morley, and Miami loams, 2 to 6 percent slopes, eroded	34.42	53.5%		Ile	124	17	4		8	44	56
MsC3	Morley silty clay loam, 6 to 12 percent slopes, severely eroded	9.96	15.5%		IVe	105	15	4	7		37	47
Pe	Pewamo silty clay loam, 0 to 1 percent slopes	5.55	8.6%		IIw	157		5	11		47	64
Ho	Houghton muck, drained	5.00	7.8%		IIIw	159		5		11	42	64
Ws	Washtenaw silt loam	3.57	5.6%		IIw	170	22	6		11	51	68
Mn	Milford silty clay loam, 0 to 2 percent slopes	2.83	4.4%		IIw	154		5		11	43	62
MuC2	Morley, Miami, and Rawson loams, 6 to 12 percent slopes, eroded	2.18	3.4%		IIIe	126	17	4		9	44	57
To	Toledo silty clay loam	0.59	0.9%		IIIw	155	21	5		10	44	62
RbB	Rawson loam, 2 to 6 percent slopes	0.17	0.3%		Ile	143	20	5		10	50	65
Weighted Average					2.43	130.9	13.5	4.3	2	6.7	43.4	57

Soils data provided by USDA and NRCS.