

Soils Map

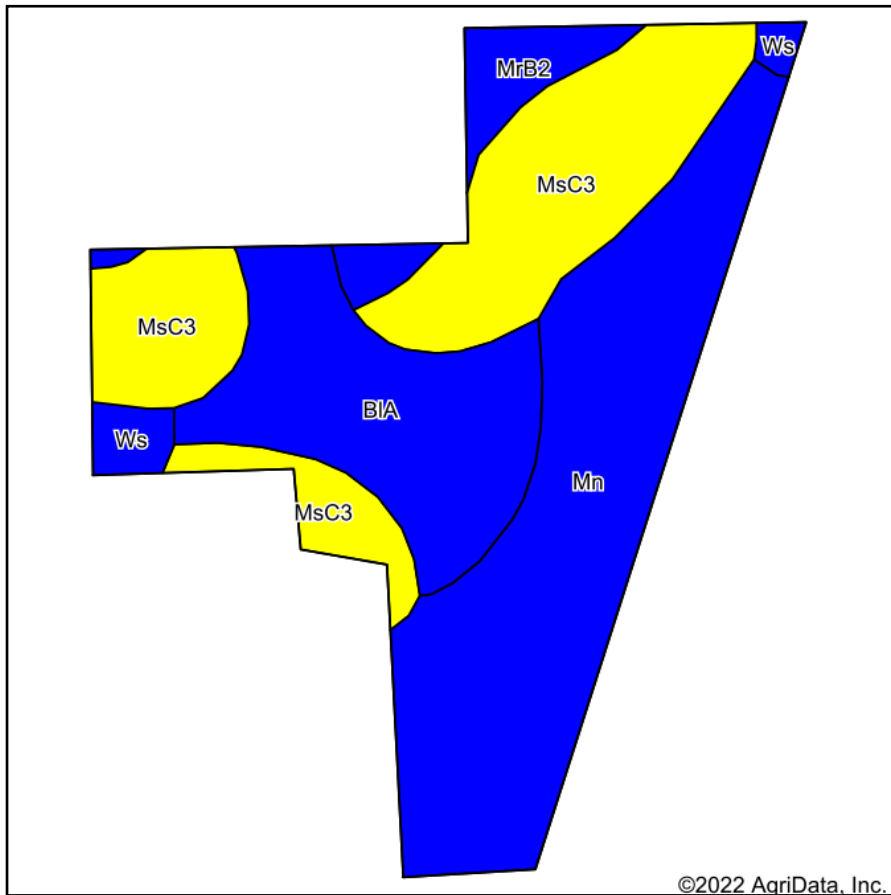

Soils data provided by USDA and NRCS.

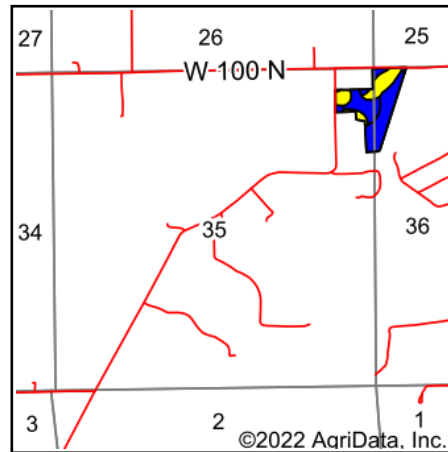

State: **Indiana**
 County: **Noble**
 Location: **35-34N-9E**
 Township: **York**
 Acres: **18.25**
 Date: **10/31/2022**



Area Symbol: IN113, Soil Area Version: 27

Code	Soil Description	Acres	Percent of field	Non-Irr Class Legend	Non-Irr Class	Corn Bu	Corn silage Tons	Grass legume hay Tons	Grass legume pasture AUM	Oats Bu	Pasture AUM	Soybeans Bu	Winter wheat Bu	
Mn	Milford silty clay loam, 0 to 2 percent slopes	7.22	39.6%		IIw	154		5			11	43	62	
MsC3	Morley silty clay loam, 6 to 12 percent slopes, severely eroded	5.65	31.0%		IVe	105	15	4	7			37	47	
BIA	Blount loam, interlobate moraines, 0 to 2 percent slopes	3.90	21.4%		IIw	142	17	5			9	52	56	
MrB2	Glynwood silt loam, 2 to 6 percent slopes, eroded	1.02	5.6%		Ile	128	1	4	8	5		44	57	
Ws	Washtenaw silt loam	0.46	2.5%		IIw	170	22	6			11	51	68	
Weighted Average						2.62	135.2	8.9	4.7	2.6	0.3	6.6	43.3	55.9

Soils data provided by USDA and NRCS.