

# For Sale

## BEAUTIFUL COUNTRY HOME

8717 COUNTY RD N, LANCASTER, WI 53813

2.75±  
ACRES



**Listing Price:** **\$339,500**

Beautiful country home located just 3 miles from Lancaster, WI. The single story, brick ranch house has 3 bedrooms, 2 full bathrooms and sits on 2.75 acres including an updated finished basement. Whether you are in the kitchen enjoying the granite countertops or gathering with family on the Trex back deck, this property feels like home. In addition to the attached one car, heated garage, you'll find a 3 car detached garage and a 40'x48' machine shed both with cement floors. The views from this property include the Mississippi bluffs to the south and the Platteville Mound to the east.

**LINK TO VIEW PROPERTY:**

<https://my.matterport.com/show/?m=6V4z12JXPG2>



*For Private Inspection, call Chris Hoffman • 608-885-0005*



*The information on this sheet is subject to verification and no liability for errors or omissions is assumed by the Schrader Agency.*

*Vogt • CH01G-WI • 11/30/21*

 **SCHRADER**  
Real Estate and Auction Company, Inc.

**800-451-2709**

*Listing Agent:*  
CHRIS HOFFMAN • [chris@schraderauction.com](mailto:chris@schraderauction.com)

**608-885-0005**

# For Sale

## BEAUTIFUL COUNTRY HOME

8717 COUNTY RD N, LANCASTER, WI 53813

2.75±  
ACRES

LOCATION MAP:  
8717 County Rd N, Lancaster, WI 53813

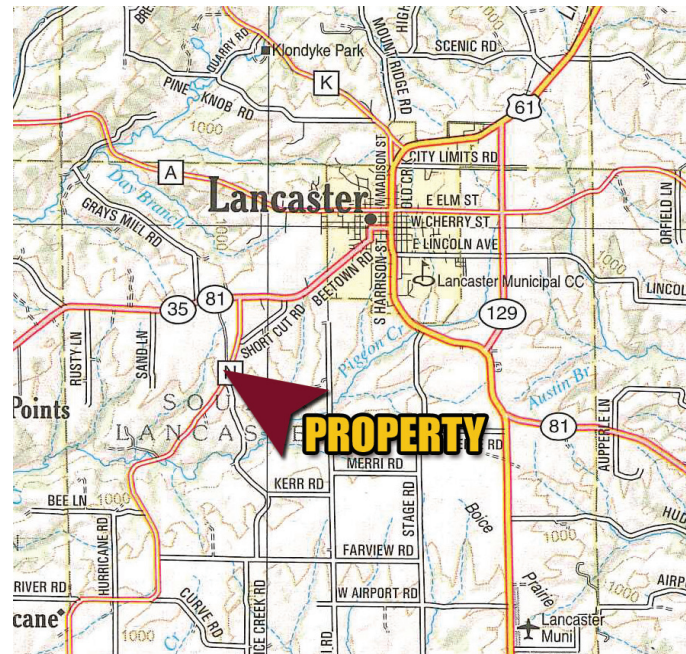

The information on this sheet is subject to verification and no liability for errors or omissions is assumed by the Schrader Agency.

Vogt • CH01G-WI • 11/30/21

**SCHRADER**  
Real Estate and Auction Company, Inc.

**800-451-2709**

Listing Agent:  
CHRIS HOFFMAN • [chris@schraderauction.com](mailto:chris@schraderauction.com)  
**608-885-0005**