

SIGNIFICANT LAND & PRODUCING MINERALS AUCTION

18 Mineral Packages
4 Surface Tracts

Quality Rush Creek Bottomland Farm

6-Month Avg. Cash Flow \$196,376/Mo.

Producing SCOOP (Oil Window) Mineral Interests

Select Operators Include:

- Newfield Mid-Continent
- Sheridan Production Company
- Apache Corporation
- Merit Energy
- Casillas Operating
- Jones Energy



MINERAL PACKAGE 17 INFORMATION BOOKLET

THURSDAY, JANUARY 31 • 1:00 PM

800.451.2709

SchraderAuction.com

at The Springs Event Venue, Blanchard, OK • Online Bidding Available

DISCLAIMER

This Information Booklet has been assembled for purposes of the auction to be conducted on January 31, 2019 by Schrader Real Estate and Auction Company, Inc. ("Auction Company"). The information in this booklet includes information and materials obtained and/or derived from various sources, including Owner and third parties, regarding the minerals and/or mineral rights to be offered at the auction (the "Property").

The Auction Company and its agents and representatives have not undertaken to evaluate, verify or vouch for any information, records or reports regarding any purported legal, title, geological, production and/or income information regarding any minerals and/or mineral rights. If there is any question regarding the source of any information, please contact the Auction Company for clarification.

The marketing materials prepared for this auction, including this Information Booklet, have been designed for prospective bidders who have (or have access to) the expertise necessary to independently evaluate any purported legal, title, geological, production and/or income information regarding the Property. The marketing materials are not intended as a complete record of information pertaining to the Property, nor are they intended as a substitute for a complete and independent investigation and evaluation by a prospective bidder and its qualified advisers. All prospective bidders are responsible for obtaining their own independent technical and legal advice and for conducting their own independent investigation and evaluation of the Property and the information and materials provided with respect thereto.

AUCTION COMPANY AND ITS AGENTS AND REPRESENTATIVES MAKE NO REPRESENTATION OR WARRANTY REGARDING THE PROPERTY. WITHOUT LIMITING THE FOREGOING DISCLAIMER, AUCTION COMPANY AND ITS AGENTS AND REPRESENTATIVES DISCLAIM ANY REPRESENTATION OR WARRANTY AS TO THE NATURE, QUALITY, QUANTITY, USABILITY, SUITABILITY, MINEABILITY, VALUE OR CONDITION OF ANY MINERALS AND/OR MINERAL RIGHTS WHICH MAY OR MAY NOT BE INCLUDED WITH THE PROPERTY OR AS TO THE ACCURACY OF ANY INFORMATION, MATERIALS AND/OR REPORTS PROVIDED IN CONNECTION WITH THIS AUCTION FROM ANY SOURCE.

Auction Company: Schrader Real Estate and Auction Company, Inc.

4% Buyer's Premium

AUCTION
MANAGER

BRENT WELLINGS • 972-768-5165 • brent@schraderauction.com

Summary of Terms:

BIDDING PROCEDURE: All tracts will be offered individually, in any combination and as a whole unit. Bidding on individual tracts and all combinations will compete until the end of the auction. The final bids are subject to Seller's acceptance or rejection.

PURCHASE CONTRACT: Immediately following the close of bidding, each high bidder will sign purchase contract documents in the forms provided in the bidder packets. All statements and information in the marketing materials are subject to the terms and conditions of the purchase contract documents. Seller shall not be bound by any statement, promise or inducement that is not contained in the purchase contract documents.

BUYER'S PREMIUM: The purchase price will be the bid amount plus a 4% buyer's premium.

PAYMENT: 10% of the purchase price will be due as a down payment on the day of auction, with the balance due at closing. The down payment may be made in the form of cashier's check, personal check or corporate check. YOUR BIDDING IS NOT CONDITIONAL UPON FINANCING, so be sure you have arranged financing, if needed, and are capable of paying cash at closing.

CLOSING: The targeted closing period is on or before March 4, 2019.

Surface Tracts:

POSSESSION: Possession will be delivered at closing except that possession of the cropland will be delivered subject to harvest of the existing wheat crop.

REAL ESTATE TAXES: Real estate taxes will be prorated to the date of closing.

DEED: The Surface Tracts will be conveyed by a deed without warranty, excluding all minerals. (Any purchased Mineral Tracts will be

conveyed by a separate mineral deed.)

EVIDENCE OF TITLE: Seller will furnish preliminary title insurance schedules before the auction and an updated title insurance commitment before closing. Buyer will pay for the issuance of any title insurance policy.

SURVEY: A new survey will be obtained only if necessary to record the conveyance or if otherwise deemed appropriate in Seller's sole discretion. If a new survey is obtained, the survey cost will be shared equally by Seller and Buyer and, unless otherwise provide in the purchase contract documents, the purchase price will be adjusted proportionately to reflect any difference between advertised and surveyed acres.

TRACT MAPS; ACRES: Tract maps and advertised acres are approximations based on existing tax parcel data, legal descriptions &/or aerial mapping data and are not provided as survey products.

Mineral Tracts:

DEED: The Mineral Tracts will be conveyed by a mineral deed without warranty. With respect to any particular Mineral Tract, the Buyer will acquire all of Seller's right, title and interest with respect to the minerals in and under and that may be produced from the particular land identified with such Mineral Tract. The form of mineral deed will be available to review prior to the auction.

EVIDENCE OF TITLE: Seller has no obligation to provide a mineral title search report or opinion before or after the auction. A prospective bidder is responsible for examining the title prior to the auction. In any event, Buyer agrees to accept title in its current condition and accept the deed without any warranty of title, express or implied.

AS IS: Mineral Tracts are offered on an as-is, where-is basis. No representation or warranty is or will be made for any purpose whatsoever

as to the quality, quantity, usability, suitability, mineability, value or condition of any minerals which may or may not be included with the purchased Minerals Tract(s).

All Tracts:

ALL PROPERTY IS OFFERED "AS IS, WHERE IS". NO WARRANTY OR REPRESENTATION, STATED OR IMPLIED, IS MADE BY SELLER OR AUCTION COMPANY CONCERNING THE PROPERTY. Prospective bidders are responsible for conducting their own independent inspections, investigations, inquiries and due diligence concerning the property. The information contained in the marketing materials is provided in order to facilitate (and not as a substitute for) a prospective bidder's pre-auction due diligence. All marketing materials are subject to a prospective bidder's independent verification. Seller and Auction Company assume no liability for any inaccuracies, errors or omissions in such materials. All sketches and dimensions are approximate.

AGENCY: Schrader Real Estate and Auction Company, Inc. and its representatives are exclusively the agents of Seller.

CONDUCT OF AUCTION: The conduct of the auction and increments of bidding will be at the direction and discretion of the auctioneer. Seller and its agents reserve the right to preclude any person from bidding if there is any question as to the person's identity, credentials, fitness, etc. All decisions of the auctioneer at the auction are final.

CHANGES: Please arrive prior to scheduled auction time to review any changes and/or additional information. **THE PURCHASE CONTRACT DOCUMENTS (INCLUDING THE FINAL AUCTION DAY ANNOUNCEMENTS) WILL SUPERSEDE THE MARKETING MATERIALS AND ANY OTHER PRIOR STATEMENTS.**



950 N. Liberty Dr., Columbia City, IN 46725
800.451.2709 | 260.244.7606
www.schraderauction.com

Follow us and download our new Schrader iOS app



BOOKLET INDEX

Real Estate Auction Registration Forms

Rig/Plat Map

Lot Description

Well List

Area Activity Map

Historical Production Curve

Well Data Card

Division Orders

Source Title Documents

Oil & Gas Lease

Conveying Mineral Deed



BIDDER PRE-REGISTRATION FORM

**THURSDAY, JANUARY 31, 2019
237 ACRES – LINDSAY, OKLAHOMA**

For pre-registration, this form must be received at Schrader Real Estate and Auction Company, Inc.,
P.O. Box 508, Columbia City, IN, 46725,
Fax # 260-244-4431, no later than Thursday, January 24, 2019.
Otherwise, registration available onsite prior to the auction.

BIDDER INFORMATION

(FOR OFFICE USE ONLY)

Name _____

Bidder # _____

Address _____

City/State/Zip _____

Telephone: (Res) _____ (Office) _____

My Interest is in Tract or Tracts # _____

BANKING INFORMATION

Check to be drawn on: (Bank Name) _____

City, State, Zip: _____

Contact: _____ Phone No: _____

HOW DID YOU HEAR ABOUT THIS AUCTION?

Brochure Newspaper Signs Internet Radio TV Friend

Other _____

WOULD YOU LIKE TO BE NOTIFIED OF FUTURE AUCTIONS?

Regular Mail E-Mail E-Mail address: _____

Tillable Pasture Ranch Timber Recreational Building Sites

What states are you interested in? _____

Note: If you will be bidding for a partnership, corporation or other entity, you must bring documentation with you to the auction which authorizes you to bid and sign a Purchase Agreement on behalf of that entity.

I hereby agree to comply with terms of this sale including, but not limited to, paying all applicable buyer's premiums, and signing and performing in accordance with the contract if I am the successful bidder. Schrader Real Estate and Auction Company, Inc. represents the Seller in this transaction.

Signature: _____ Date: _____

Online Auction Bidder Registration
237± Acres • Lindsay, Oklahoma
Thursday, January 31, 2019

This form and deposit are only required if you cannot attend the auction and wish to bid remotely through our online bidding system.

This registration form is for the auction listed above only. The person signing this form is personally responsible for any bids placed on the auction site, whether bidding on behalf of their personal account or on behalf of a corporation or other third party. If you are bidding on behalf of a third party, you are responsible for obtaining the necessary documentation authorizing you to bid on behalf of the third party. Schrader Real Estate and Auction Co., Inc. will look to the herein registered bidder for performance on any bid placed on this auction if you are the successful high bidder.

As the registered bidder, I hereby agree to the following statements:

1. My name and physical address is as follows:

My phone number is: _____

2. I have received the Real Estate Bidder's Package for the auction being held on Thursday, January 31, 2019 at 1:00 PM.
3. I have read the information contained in the Real Estate Bidder's Package as mailed to me or by reading the documents on the website (www.schraderauction.com) and understand what I have read.
4. I hereby agree to comply with all terms of this sale, including paying all applicable buyer's premiums, and signing and performing in accordance with the Real Estate Purchase Agreement if I am the successful bidder.
5. I understand that Schrader Real Estate and Auction Co., Inc. represent the Seller in this transaction.
6. I am placing a deposit with Schrader Real Estate and Auction Co., Inc. Escrow in the amount of \$_____. I understand that the maximum bid or combination of bids I place may not exceed an amount equal to ten times the amount of my deposit. My deposit is being conveyed herewith in the form of a cashier's check payable to Schrader Real Estate and Auction, Co., Inc. Escrow or via wire transfer to the escrow account of Schrader Real Estate and Auction, Co., Inc. per the instructions below. I understand that my deposit money will be returned in full via wire transfer on the next business day if I am not the successful high bidder on any tract or combination of tracts.

Schrader Real Estate & Auction Company, Inc.
950 North Liberty Drive / P.O. Box 508, Columbia City, IN 46725
Phone 260-244-7606; Fax 260-244-4431

For wire instructions please call 1-800-451-2709.

7. My bank routing number is _____ and bank account number is _____.
(This for return of your deposit money). My bank name, address and phone number is:

8. **TECHNOLOGY DISCLAIMER:** Schrader Real Estate and Auction Co., Inc., its affiliates, partners and vendors, make no warranty or guarantee that the online bidding system will function as designed on the day of sale. Technical problems can and sometimes do occur. If a technical problem occurs and you are not able to place your bid during the live auction, Schrader Real Estate and Auction Co., Inc., its affiliates, partners and vendors will not be held liable or responsible for any claim of loss, whether actual or potential, as a result of the technical failure. I acknowledge that I am accepting this offer to place bids during a live outcry auction over the Internet *in lieu of actually attending the auction* as a personal convenience to me.

9. This document and your deposit money must be received in the office of Schrader Real Estate & Auction Co., Inc. by **4:00 PM, Thursday, January 24, 2019**. Send your deposit and return this form via fax to: **260-244-4431**.

I understand and agree to the above statements.

Registered Bidder's signature

Date

Printed Name

This document must be completed in full.

Upon receipt of this completed form and your deposit money, you will be sent a bidder number and password via e-mail. Please confirm your e-mail address below:

E-mail address of registered bidder: _____

Thank you for your cooperation. We hope your online bidding experience is satisfying and convenient. If you have any comments or suggestions, please send them to:
kevin@schraderauction.com or call Kevin Jordan at 260-229-1904.

THURSDAY, JANUARY 31 • 1:00 PM

RIG/PLAT MAP



800.451.2709
SchraderAuction.com

SCHRADER
Real Estate and Auction Company, Inc.

RIG/PLAT MAP

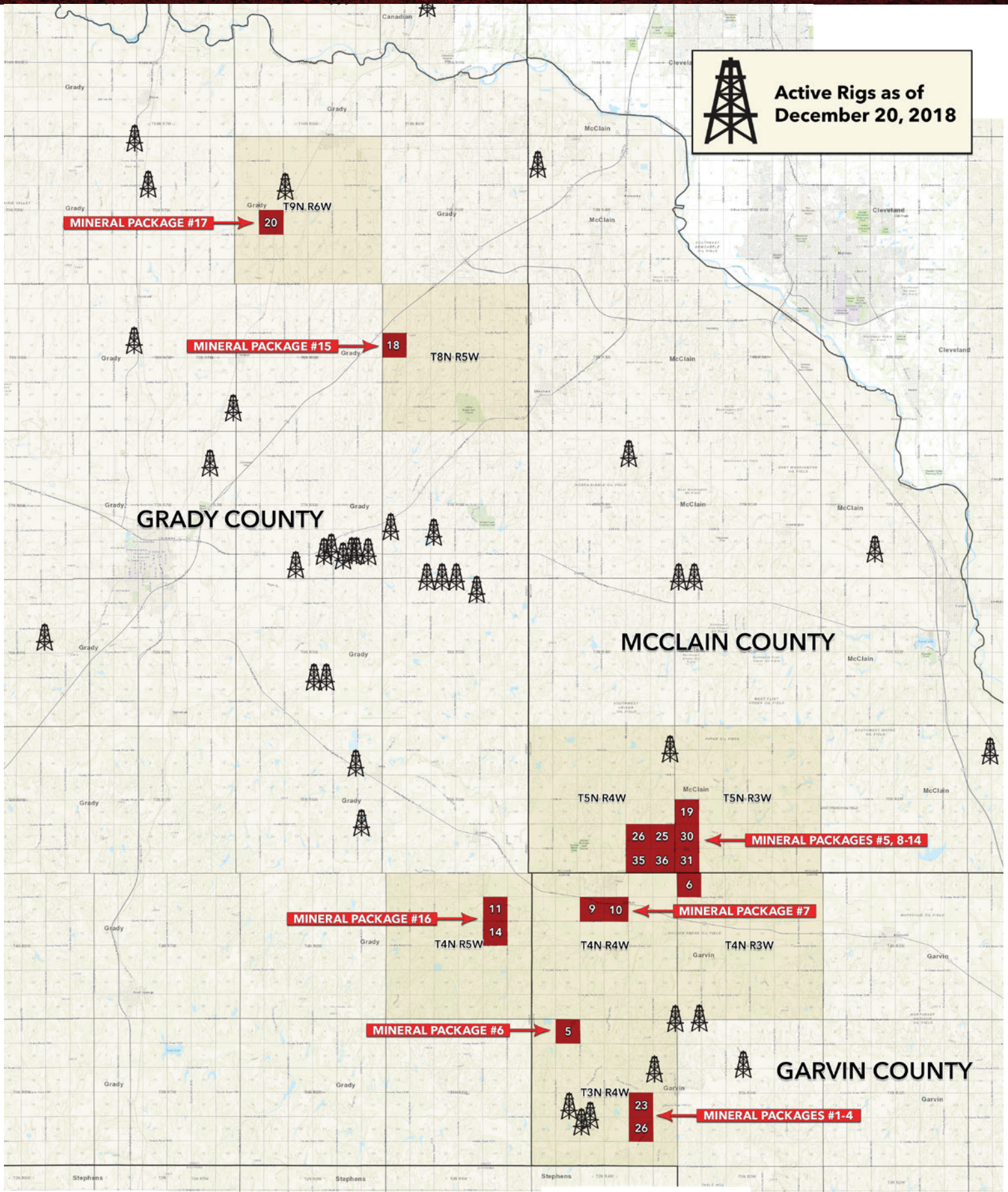

“Data provided by and used with permission from Drillinginfo.”

THURSDAY, JANUARY 31 • 1:00 PM

LOT DESCRIPTION



800.451.2709
SchraderAuction.com

SCHRADER
Real Estate and Auction Company, Inc.

LOT DESCRIPTION

Package Description

Mineral Package 17

Property Highlights:

- 6-Month Average 8/8ths Production: 250.65 BOPD and 1,394.39 MCFPD
- 6 Month Average Net Income: \$0.00/Month – SELLER HAS NOT RECEIVED 1st PAYMENT AS OF DATE OF PUBLISHING. UPDATED INCOME INFORMATION WILL BE PROVIDED UPON RECEIPT.
- Operators:
 - Jones Energy
- 2 Producing Wells
- Decimal Interest: 0.00195313

Seller is offering all its right, title and interest in this property that includes 2 wells currently being operated by Jones Energy Inc of Austin, TX in Section 20, T9N, R6W Grady County, OK. Combined these wells are currently producing approximately 250.65 BOPD and 1,394.39 MCFPD.

Legal Description:

The North Half of Section 20, T9N, R6W – Grady County, OK

MONTHLY REVENUES – Package 17 Summary

Accounting Month	Net Revenue
November 2018	\$0.00
October 2018	\$0.00
September 2018	\$0.00
August 2018	\$0.00
July 2018	\$0.00
June 2018	\$0.00

“Reference source deed for full legal description.”

THURSDAY, JANUARY 31 • 1:00 PM

WELL LIST



800.451.2709
SchraderAuction.com

SCHRADER
Real Estate and Auction Company, Inc.

WELL LIST

Well List – Package 17

Well Name	API #	Decimal Interest	Completion Date	Avg. Daily Production Last 6 Months Oil - BBL	Avg. Daily Production Last 6 Months Gas - MCF
EATON FARMS 1H	35-051-24212	-	01/17/18	124.26	633.61
EATON FARMS 2H	35-051-24213	-	01/30/18	126.39	760.79

* Numbers represented above are estimates, based on information provided by third party sources. Buyers are responsible for verifying all information provided and conducting their own due diligence.

THURSDAY, JANUARY 31 • 1:00 PM

AREA ACTIVITY MAP & HISTORICAL PRODUCTION CURVE



800.451.2709
SchraderAuction.com

SCHRADER
Real Estate and Auction Company, Inc.

AREA ACTIVITY MAP & HISTORICAL PRODUCTION CURVE

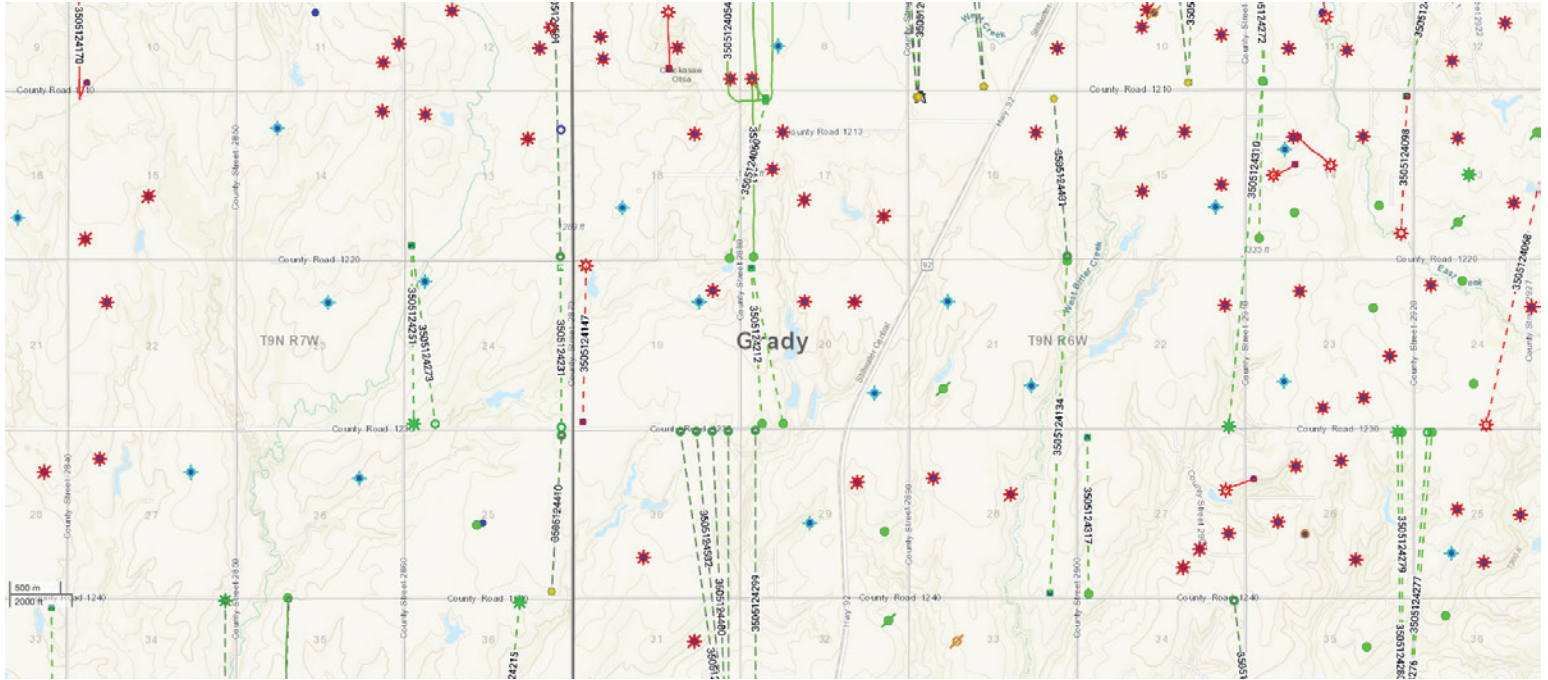

Historical Production
Click and drag in the plot area to zoom in

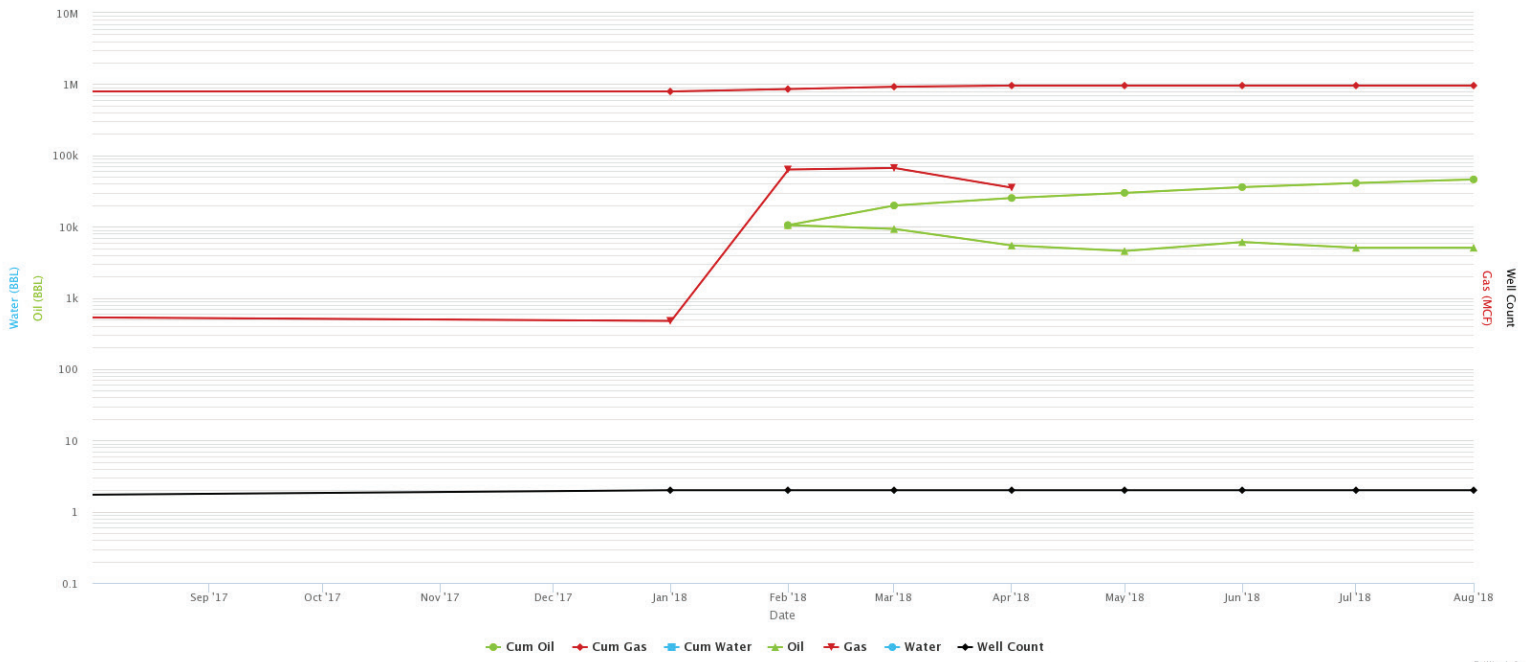

“Data provided by and used with permission from Drillinginfo.”

THURSDAY, JANUARY 31 • 1:00 PM

WELL DATA CARDS



800.451.2709
SchraderAuction.com

 **SCHRADER**
Real Estate and Auction Company, Inc.

WELL DATA CARDS - EATON FARMS 20-9-6 1H



Well Card Details

2018-12-11

EATON FARMS 20-9-6 1H							
API #:	3505124212	County:	GRADY (OK)	Township:	09N	Last Completion Date:	01-17-2018
Operator:	JONES ENERGY	Lat, Lon:	35.2464841, -97.8641221	Range:	06W	Wellbore Count:	1
Status:	ACTIVE	Field:	MINCO	Q/Q:	NW NW NW		
Completion Type:	OIL	Survey:		Spud Date:	10-30-2017		
GL:	1320 ft	Section:	20	First Completion Date:	01-17-2018		

PERMITS

PERMIT # TEMP637021546

GENERAL

Operator:	JONES ENERGY	Lease Name:	EATON FARMS 20-9-6	Address:	ANNE MANESS 807 LAS CIMAS PKWY STE 350 AUSTIN, TX 78746	Filing Purpose:	NewDrill
TD:	15855 ft	Received:	11-01-2017	Issued:	11-01-2017	RRC Lease ID #:	0
Phone:	5123282953	Type:	H				

SURFACE LOCATION & ACREAGE

District:		Section:	20	Survey:		County:	GRADY
Block:		Abstract:					

FIELD

Field Name:	MINCO	Permit Type:	OIL
--------------------	-------	---------------------	-----

No permit data available for this well.

WELLBORES

API # 350512421200

WELLBORE

API #:	350512421200	Formation:	MISSISSIPPIAN	True Vert. Depth:		Horizontal Length:	4859.61 ft
Trajectory:	H	Total Depth:	16047 ft	Lateral Length:		Elevation:	1320 ft

WELLBORE TRAJECTORY

No trajectory data available for this well.

WELL DESIGN

CASING

No casing data available for this well.

LINER

No liner data available for this well.

TUBING

No tubing data available for this well.

WELL LOGS

LAS LOGS

No LAS logs available for this well.

RASTER LOGS

No raster logs available for this well.

COMPLETION

API # 35051242120000

COMPLETION SUMMARY

API #:	35051242120000	Completion Date:	01-17-2018	Upper Perf:	11554 ft	Lower Perf:	15483 ft
TREATMENT JOB #1 - 35051242120000							
Source:	Additive Summary	Job Start Date:	01-24-2018	Job End Date:	01-24-2018	Treatment Top:	
Treatment Bottom:		Treatment Formation:		Stage Count:		Total Proppant:	10304494 lbs
Total Fluid:		Total Water:	306819 bbl	Total Additive:	562928 lbs	Max Treatment Rate:	
Max Treatment Pressure:		Frac Vendor:	HALLIBURTON	Treatment Type:	LINEAR GEL HC	Remarks:	

TREATMENT DETAIL FOR JOB #1 - 35051242120000

WELL DATA CARDS - EATON FARMS 20-9-6 1H



Well Card Details

2018-12-11

API #	Source	Purpose	Material Name	Trade Name	Material Amount	Material Unit	Material Mass Concentration (%)	Supplier Name	Proppant Type	Proppant Mesh Size	Sand Quality	Cement Class
35051242120000	Additive Summary	ACIDS	Hydrochloric acid		57235.07914	lbs	0.05					
35051242120000	Additive Summary	BASE FLUID	Water	FRESH WATER	107343786.97	lbs	90.94	JONES ENERGY				
35051242120000	Additive Summary	BIOCIDES	Fatty acids, coco, ethoxylated		482.754	lbs	0	HALLIBURTON				
35051242120000	Additive Summary	BIOCIDES	Pentanedial		16652.63495	lbs	0.01					
35051242120000	Additive Summary	BIOCIDES		MC B 8614	0	lbs		HALLIBURTON				
35051242120000	Additive Summary	BREAKERS AND BREAKER CATALYSTS	Peroxydisulfuric acid ((HO)S(O)2J2O2), ammonium salt (1:2)		3280.0108	lbs	0					
35051242120000	Additive Summary	BREAKERS AND BREAKER CATALYSTS		RELEASE BREAKER	0	lbs		HALLIBURTON				
35051242120000	Additive Summary	BUFFER		BA20	0	lbs		HALLIBURTON				
35051242120000	Additive Summary	CLAY CONTROL	Methanaminium, N,N,N-trimethyl-, chloride (1:1)		604.37478	lbs	0	HALLIBURTON				
35051242120000	Additive Summary	CLAY CONTROL		CLA-WEB II	0	lbs		HALLIBURTON				
35051242120000	Additive Summary	CORROSION INHIBITORS	2-Propyn-1-ol		74.10025	lbs	0					
35051242120000	Additive Summary	CORROSION INHIBITORS		HAIOS	0	lbs		HALLIBURTON				
35051242120000	Additive Summary	FLUID LOSS/DIVERTERS	Benzoic acid		1100.00364	lbs	0					
35051242120000	Additive Summary	FLUID LOSS/DIVERTERS		ACCESSFRAC MATERIAL	0	lbs		HALLIBURTON				
35051242120000	Additive Summary	FLUID LOSS/DIVERTERS		TLC-80	0	lbs		HALLIBURTON				
35051242120000	Additive Summary	FRICITION REDUCERS		FDP-S12045-16	0	lbs		HALLIBURTON				
35051242120000	Additive Summary	GELLING AGENTS	Guar gum		56801.18785	lbs	0.05					
35051242120000	Additive Summary	GELLING AGENTS		WG-35 GELLING AGENT	0	lbs		HALLIBURTON				
35051242120000	Additive Summary	OTHER ADDTTIVES		OptiKleen-WF(TM)	0	lbs		HALLIBURTON				
35051242120000	Additive Summary	PROPPANTS	Formaldehyde, polymer with 4-(1,1-dimethylethyl)phenol and 2-methyloxirane		38345.8997	lbs	0.03	HALLIBURTON	SAND			
35051242120000	Additive Summary	PROPPANTS	Quartz (SiO2)		10266148.11656	lbs	8.7		SAND			
35051242120000	Additive Summary	PROPPANTS			0	lbs		HALLIBURTON		30/50	WHITE	
35051242120000	Additive Summary	PROPPANTS			0	lbs		HALLIBURTON		100	WHITE	
35051242120000	Additive Summary	SCALE INHIBITORS		SCALECHEK LP-50	0	lbs		HALLIBURTON				
35051242120000	Additive Summary	SURFACTANTS		HCL	0	lbs		HALLIBURTON				
35051242120000	Additive Summary	SURFACTANTS		OILPERM A	0	lbs		HALLIBURTON				
35051242120000	Additive Summary	UNKNOWN	1,4-Dioxane-2,5-dione, 3,6-dimethyl-, (3R,6R)-, polymer with rel-(3R,6S)-3,6-dimethyl-1,4-dioxane-2,5-dione and (3S,6S)-3,6-dimethyl-1,4-dioxane-2,5-dione		645.00215	lbs	0	HALLIBURTON				
35051242120000	Additive Summary	UNKNOWN	1,4-Dioxane-2,5-dione, 3,6-dimethyl-, (3R,6R)-, polymer with rel-(3R,6S)-3,6-dimethyl-1,4-dioxane-2,5-dione and (3S,6S)-3,6-dimethyl-1,4-dioxane-2,5-dione		645.00215	lbs	0	HALLIBURTON				
35051242120000	Additive Summary	UNKNOWN	1-Octadecene		88.9203	lbs	0	HALLIBURTON				

WELL DATA CARDS - EATON FARMS 20-9-6 1H



Well Card Details

2018-12-11

API #	Source	Purpose	Material Name	Trade Name	Material Amount	Material Unit	Material Mass Concentration (%)	Supplier Name	Proppant Type	Proppant Mesh Size	Sand Quality	Cement Class
35051242120000	Additive Summary	UNKNOWN	2-Propenoic acid, polymer with ethenylbenzene and 2-ethylhexyl 2-propenoate		984.00328	lbs	0	HALLIBURTON				
35051242120000	Additive Summary	UNKNOWN	2-Propenoic acid, sodium salt (1:1), polymer with 2-propenamamide		14482.62005	lbs	0.01					
35051242120000	Additive Summary	UNKNOWN	Acetic acid		13.77005	lbs	0					
35051242120000	Additive Summary	UNKNOWN	Acetic acid, ammonium salt (1:1)		45.90015	lbs	0					
35051242120000	Additive Summary	UNKNOWN	Alcohols, C10-16, ethoxylated		222.30073	lbs	0	HALLIBURTON				
35051242120000	Additive Summary	UNKNOWN	Benzene, 1,2,4-trimethyl-		958.64751	lbs	0					
35051242120000	Additive Summary	UNKNOWN	Distillates (petroleum), hydrotreated light		14482.62005	lbs	0.01					
35051242120000	Additive Summary	UNKNOWN	Ethanol		58073.93686	lbs	0.05					
35051242120000	Additive Summary	UNKNOWN	Ethanol, 2,2',2''-nitrioltris-		54.94316	lbs	0	HALLIBURTON				
35051242120000	Additive Summary	UNKNOWN	Fatty acids, tall-oil		222.30073	lbs	0	HALLIBURTON				
35051242120000	Additive Summary	UNKNOWN	Methanol		5589.52253	lbs	0					
35051242120000	Additive Summary	UNKNOWN	Methanol		5067.20876	lbs	0	HALLIBURTON				
35051242120000	Additive Summary	UNKNOWN	Naphthalene		4793.2376	lbs	0					
35051242120000	Additive Summary	UNKNOWN	Phosphoric acid		55.50878	lbs	0					
35051242120000	Additive Summary	UNKNOWN	Poly(oxy-1,2-ethanediyl), .alpha.-(4-nonylphenyl)-.omega.-hydroxy-, branched		5275.9916	lbs	0					
35051242120000	Additive Summary	UNKNOWN	Poly(oxy-1,2-ethanediyl), .alpha.-(dinonylphenyl)-.omega.-hydroxy-		48.2754	lbs	0					
35051242120000	Additive Summary	UNKNOWN	Poly(oxy-1,2-ethanediyl), .alpha.-hydro-.omega.-hydroxy-		48.2754	lbs	0					
35051242120000	Additive Summary	UNKNOWN	Pyridinium, 1-(phenylmethyl)-, Et Me derivs., chlorides		1098.86325	lbs	0	HALLIBURTON				
35051242120000	Additive Summary	UNKNOWN	Quaternary ammonium compounds, benzyl-C12-16-alkyldimethyl, chlorides		16482.94911	lbs	0.01	HALLIBURTON				
35051242120000	Additive Summary	UNKNOWN	Quaternary ammonium compounds, benzyl-C12-16-alkyldimethyl, chlorides		2775.43925	lbs	0					
35051242120000	Additive Summary	UNKNOWN	Sodium chloride (NaCl)		5376.97182	lbs	0					
35051242120000	Additive Summary	UNKNOWN	Sodium perborate tetrahydrate		5284.01753	lbs	0					
35051242120000	Additive Summary	UNKNOWN	Solvent naphtha (petroleum), heavy arom.		28759.4245	lbs	0.02					
35051242120000	Additive Summary	UNKNOWN	Sorbitan, mono-(9Z)-9-octadecenoate, poly(oxy-1,2-ethanediyl) derivs.		2413.7701	lbs	0					
35051242120000	Additive Summary	UNKNOWN	Thiourea, polymer with formaldehyde and 1-phenylethanone		222.30073	lbs	0	HALLIBURTON				
35051242120000	Additive Summary	UNKNOWN	Water	Ingredients	235520.67969	lbs	0.2	HALLIBURTON				

WELL DATA CARDS - EATON FARMS 20-9-6 1H

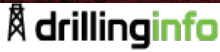

Well Card Details

2018-12-11

API #	Source	Purpose	Material Name	Trade Name	Material Amount	Material Unit	Material Mass Concentration (%)	Supplier Name	Proppant Type	Proppant Mesh Size	Sand Quality	Cement Class
35051242120000	Additive Summary	UNKNOWN			482.754	lbs	0	HALLIBURTON				
35051242120000	Additive Summary	UNKNOWN			16482.94911	lbs	0.01	HALLIBURTON				

No treatment detail data available for this treatment job.

TREATMENT JOB #2 - 35051242120000												
Source:	State Agency		Job Start Date:			Job End Date:	01-17-2018		Treatment Top:	11554 ft		
Treatment Bottom:	15483 ft		Treatment Formation:	MISSISSIPPIAN		Stage Count:			Total Proppant:	10271430 lbs		
Total Fluid:	307422 bbl		Total Water:			Total Additive:			Max Treatment Rate:			
Max Treatment Pressure:			Frac Vendor:			Treatment Type:			Remarks:	Acid Type: 1200 BBLs, Frac Type: 10.271.430 LBS PROPPANT; 306.222 BBLs FLUID		

TREATMENT DETAIL FOR JOB #2 - 35051242120000												
API #	Source	Purpose	Material Name	Trade Name	Material Amount	Material Unit	Material Mass Concentration (%)	Supplier Name	Proppant Type	Proppant Mesh Size	Sand Quality	Cement Class
35051242120000	State Agency	ACID	acid type :		50400	GALS						
35051242120000	State Agency	FLUID	fluid		12861324	GALS						
35051242120000	State Agency	PROPPANT	proppant		10271430	LBS			SAND			

No treatment detail data available for this treatment job.

No treatment job data available for this well.

No completion data available for this well.

FORMATIONS

FORMATIONS

No formation data available for this well.

WELL TESTS

PRODUCTION

Test Date	Hours Tested	GOR	Casing Pressure (psi)	Flowing Tubing Pressure (psi)	Initial Shut In Pressure (psi)	Choke Size	Oil/Liquid Gravity	Gas Gravity	Oil Volume (bbl)	Gas Volume (Mcf)	Water Volume (bbl)	Test Type	Production Method
02-17-2018		4588			7730	0.688	48		270	1239	87	InitialPotentialTest	

No production test data available for this well.

DRILL STEM TESTS

No drill stem test data available for this well.

DRILL STEM TEST PIPE RECOVERY

No pipe recovery data data available for this well.

DRILL STEM TEST FLOW PERIODS

No flow period data available for this well.

PRODUCTION

API # 35051242120000

SUMMARY

Producing Entity:	WELL	Max Active Wells:	1	Cumulative Gas:	75186	Oil EUR:	
Reservoir:	MISSISSIPPIAN	First Prod Date:	01-01-2018	Peak Oil:	4773	Gas EUR:	
District:	(N/A)	Last Prod Date:	05-01-2018	Peak Gas:	30481	Oil Gatherer:	COFFEYVILLE RESOURCES REFINING & MARKETING LLC
Lease:	EATON FARMS 20-9-6	Months Producing:	5	Daily Oil:	98	Gas Gatherer:	ENLINK OKLAHOMA GAS PROCESSING LP
Latest Well Count:	1	Cumulative Oil:	14800	Daily Gas:	498		

PRODUCTION

Date	Monthly Oil (bbl)	Monthly Gas (Mcf)	Monthly Water (bbl)	Avg Daily Oil (bbl)	Avg Daily Gas (Mcf)	Avg Daily Water (bbl)	Wells	Days
01-01-2018	0	34	0	0	1.1	0	1	
02-01-2018	4724	26092	0	168.71	931.86	0	1	
03-01-2018	4773	30481	0	153.97	983.26	0	1	
04-01-2018	3078	18579	0	102.6	619.3	0	1	

WELL DATA CARDS - EATON FARMS 20-9-6 1H



Well Card Details

2018-12-11

Date	Monthly Oil (bbl)	Monthly Gas (Mcf)	Monthly Water (bbl)	Avg Daily Oil (bbl)	Avg Daily Gas (Mcf)	Avg Daily Water (bbl)	Wells	Days
05-01-2018	2225	0	0	71.77	0	0	1	

No production data available for this well.

CHART

Monthly Production

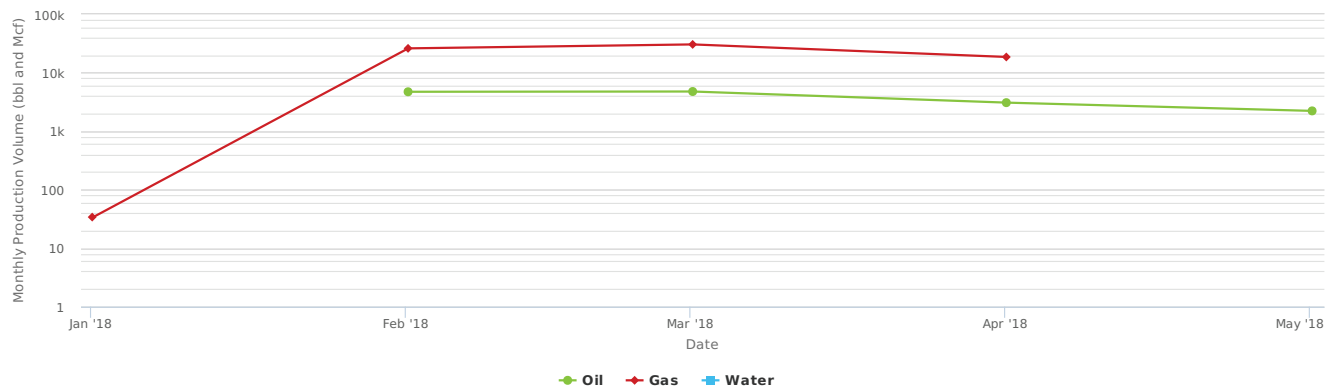

No production time series data available for this well.

No production data available for this well.

HISTORY

Effective Date	Operator	Activity
02-17-2018		Well Test
01-17-2018	JONES ENERGY	Completion
01-17-2018	JONES ENERGY, LTD.	Production
01-01-2018	JONES ENERGY, LTD.	Production
11-01-2017	JONES ENERGY	Permit
10-30-2017	JONES ENERGY	Spud

No history data available for this well.

WELL DATA CARDS - EATON FARMS 20-9-6 2H



Well Card Details

2018-12-11

EATON FARMS 20-9-6 2H							
API #:	3505124213	County:	GRADY (OK)	Township:	09N	Last Completion Date:	01-30-2018
Operator:	JONES ENERGY	Lat, Lon:	35.2464841, -97.8640611	Range:	06W	Wellbore Count:	1
Status:	ACTIVE	Field:	MINCO	Q/Q:	NW NW NW		
Completion Type:	OIL	Survey:		Spud Date:	10-29-2017		
GL:	1319 ft	Section:	20	First Completion Date:	01-30-2018		

PERMITS

PERMIT # TEMP735842361

GENERAL

Operator:	JONES ENERGY	Lease Name:	EATON FARMS 20-9-6	Address:	ANNE MANESS 807 LAS CIMAS PKWY STE 350 AUSTIN, TX 78746	Filing Purpose:	NewDrill
TD:	15925 ft	Received:	11-01-2017	Issued:	11-01-2017	RRC Lease ID #:	0
Phone:	5123282953	Type:	H				

SURFACE LOCATION & ACREAGE

District:		Section:	20	Survey:		County:	GRADY
Block:		Abstract:					

FIELD

Field Name:	MINCO	Permit Type:	OIL
--------------------	-------	---------------------	-----

WELLBORES

API # 350512421300

WELLBORE

API #:	350512421300	Formation:	WOODFORD	True Vert. Depth:		Horizontal Length:	4947.09 ft
Trajectory:	H	Total Depth:	16225 ft	Lateral Length:		Elevation:	1319 ft

WELLBORE TRAJECTORY

No trajectory data available for this well.

No wellbore data available for this well.

WELL DESIGN

CASING

No casing data available for this well.

LINER

No liner data available for this well.

TUBING

No tubing data available for this well.

WELL LOGS

LAS LOGS

No LAS logs available for this well.

RASTER LOGS

No raster logs available for this well.

COMPLETION

API # 35051242130000

COMPLETION SUMMARY

API #:	35051242130000	Completion Date:	01-30-2018	Upper Perf:	11578 ft	Lower Perf:	16130 ft
TREATMENT JOB #1 - 35051242130000							
Source:	Additive Summary	Job Start Date:	01-24-2018	Job End Date:	01-24-2018	Treatment Top:	
Treatment Bottom:		Treatment Formation:		Stage Count:		Total Proppant:	9076463 lbs
Total Fluid:		Total Water:	337324 bbl	Total Additive:	510616 lbs	Max Treatment Rate:	
Max Treatment Pressure:		Frac Vendor:	HALLIBURTON	Treatment Type:	SLICKWATER HC	Remarks:	

TREATMENT DETAIL FOR JOB #1 - 35051242130000

WELL DATA CARDS - EATON FARMS 20-9-6 2H



Well Card Details

2018-12-11

API #	Source	Purpose	Material Name	Trade Name	Material Amount	Material Unit	Material Mass Concentration (%)	Supplier Name	Proppant Type	Proppant Mesh Size	Sand Quality	Cement Class
35051242130000	Additive Summary	ACIDS	Hydrochloric acid		32052.58689	lbs	0.03					
35051242130000	Additive Summary	BASE FLUID	Water	FRESH WATER	118016424.54	lbs	92.62	JONES ENERGY				
35051242130000	Additive Summary	BIOCIDES	Fatty acids, coco, ethoxylated		619.24405	lbs	0	HALLIBURTON				
35051242130000	Additive Summary	BIOCIDES	Pentanedial		19831.90586	lbs	0.02					
35051242130000	Additive Summary	BIOCIDES		MC B 8614	0	lbs		HALLIBURTON				
35051242130000	Additive Summary	BREAKERS AND BREAKER CATALYSTS	Peroxydisulfuric acid (((HO)S(O)2)2O2), ammonium salt (1:2)		1020.00338	lbs	0					
35051242130000	Additive Summary	BREAKERS AND BREAKER CATALYSTS		RELEASE BREAKER	0	lbs		HALLIBURTON				
35051242130000	Additive Summary	BUFFER		BA20	0	lbs		HALLIBURTON				
35051242130000	Additive Summary	CLAY CONTROL	Methanaminium, N,N,N-trimethyl-, chloride (1:1)		116.58887	lbs	0	HALLIBURTON				
35051242130000	Additive Summary	CORROSION INHIBITORS	2-Propyn-1-ol		35.56812	lbs	0					
35051242130000	Additive Summary	CORROSION INHIBITORS		HAIOS	0	lbs		HALLIBURTON				
35051242130000	Additive Summary	FRICITION REDUCERS		FDP-S12045-16	0	lbs		HALLIBURTON				
35051242130000	Additive Summary	GELLING AGENTS	Guar gum		20622.06819	lbs	0.02					
35051242130000	Additive Summary	GELLING AGENTS		WG-35 GELLING AGENT	0	lbs		HALLIBURTON				
35051242130000	Additive Summary	OTHER ADDTTIVES		Claweb(TM)	0	lbs		HALLIBURTON				
35051242130000	Additive Summary	OTHER ADDTTIVES		FDP-S1267-16	0	lbs		HALLIBURTON				
35051242130000	Additive Summary	OTHER ADDTTIVES		OptiKleen-WF(TM)	0	lbs		HALLIBURTON				
35051242130000	Additive Summary	PROPPANTS	Formaldehyde, polymer with 4-(1,1-dimethylethyl)phenol and 2-methyloxirane		42981.38311	lbs	0.03	HALLIBURTON	SAND			
35051242130000	Additive Summary	PROPPANTS	Iron oxide (Fe2O3)		117.67879	lbs	0		SAND			
35051242130000	Additive Summary	PROPPANTS	Quartz (SiO2)		9033364.44651	lbs	7.09		SAND			
35051242130000	Additive Summary	PROPPANTS			0	lbs		HALLIBURTON		40/70	WHITE	
35051242130000	Additive Summary	PROPPANTS			0	lbs		HALLIBURTON		100	WHITE	
35051242130000	Additive Summary	SURFACTANTS		OILPERM A	0	lbs		HALLIBURTON				
35051242130000	Additive Summary	SURFACTANTS		HCL	0	lbs		HALLIBURTON				
35051242130000	Additive Summary	UNKNOWN	1,4-Dioxane-2,5-dione, 3,6-dimethyl-, (3R,6R)-, polymer with rel-(3R,6S)-3,6-dimethyl-1,4-dioxane-2,5-dione and (3S,6S)-3,6-dimethyl-1,4-dioxane-2,5-dione		1176.78788	lbs	0	HALLIBURTON				
35051242130000	Additive Summary	UNKNOWN	1-Octadecene		42.68174	lbs	0	HALLIBURTON				
35051242130000	Additive Summary	UNKNOWN	2-Propenoic acid, polymer with ethenylbenzene and 2-ethylhexyl 2-propenoate		306.00102	lbs	0	HALLIBURTON				
35051242130000	Additive Summary	UNKNOWN	2-Propenoic acid, sodium salt (1:1), polymer with 2-propenamamide		18577.32232	lbs	0.01					
35051242130000	Additive Summary	UNKNOWN	Acetic acid		137.70045	lbs	0					
35051242130000	Additive Summary	UNKNOWN	Acetic acid, ammonium salt (1:1)		459.00154	lbs	0					
35051242130000	Additive Summary	UNKNOWN	Alcohols, C10-16, ethoxylated		106.70435	lbs	0	HALLIBURTON				

WELL DATA CARDS - EATON FARMS 20-9-6 2H

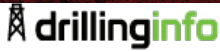

Well Card Details

2018-12-11

API #	Source	Purpose	Material Name	Trade Name	Material Amount	Material Unit	Material Mass Concentration (%)	Supplier Name	Proppant Type	Proppant Mesh Size	Sand Quality	Cement Class
35051242130000	Additive Summary	UNKNOWN	Aluminum oxide (Al2O3)		1176.78788	lbs	0					
35051242130000	Additive Summary	UNKNOWN	Benzene, 1,2,4-trimethyl-		1074.53458	lbs	0					
35051242130000	Additive Summary	UNKNOWN	Distillates (petroleum), hydrotreated light		18577.32232	lbs	0.01					
35051242130000	Additive Summary	UNKNOWN	Ethanol		65093.91193	lbs	0.05					
35051242130000	Additive Summary	UNKNOWN	Fatty acids, tall-oil		106.70435	lbs	0	HALLIBURTON				
35051242130000	Additive Summary	UNKNOWN	Methanol		312.23381	lbs	0					
35051242130000	Additive Summary	UNKNOWN	Naphthalene		5372.67289	lbs	0					
35051242130000	Additive Summary	UNKNOWN	Phosphoric acid		62.18373	lbs	0					
35051242130000	Additive Summary	UNKNOWN	Poly(oxy-1,2-ethanediyl), .alpha.-(4-nonylphenyl)-.omega.-hydroxy-, branched		5991.91694	lbs	0					
35051242130000	Additive Summary	UNKNOWN	Poly(oxy-1,2-ethanediyl), .alpha.-(dinonylphenyl)-.omega.-hydroxy-		61.9244	lbs	0					
35051242130000	Additive Summary	UNKNOWN	Poly(oxy-1,2-ethanediyl), .alpha.-hydro-.omega.-hydroxy-		61.9244	lbs	0					
35051242130000	Additive Summary	UNKNOWN	Potassium chloride (KCl)		11767.87892	lbs	0.01					
35051242130000	Additive Summary	UNKNOWN	Pyridinium, 1-(phenylmethyl)-, Et Me derivs., chlorides		3555.96054	lbs	0	HALLIBURTON				
35051242130000	Additive Summary	UNKNOWN	Quaternary ammonium compounds, benzyl-C12-16-alkyldimethyl, chlorides		3109.18633	lbs	0					
35051242130000	Additive Summary	UNKNOWN	Sodium chloride (NaCl)		9107.16256	lbs	0.01					
35051242130000	Additive Summary	UNKNOWN	Sodium perborate tetrahydrate		6321.02091	lbs	0					
35051242130000	Additive Summary	UNKNOWN	Solvent naphtha (petroleum), heavy arom.		32236.03733	lbs	0.03					
35051242130000	Additive Summary	UNKNOWN	Sorbitan, mono-(9Z)-9-octadecenoate, poly(oxy-1,2-ethanediyl) derivs.		3096.22039	lbs	0					
35051242130000	Additive Summary	UNKNOWN	Thiourea, polymer with formaldehyde and 1-phenylethanone		106.70435	lbs	0	HALLIBURTON				
35051242130000	Additive Summary	UNKNOWN	Titanium oxide (TiO2)		117.67879	lbs	0					
35051242130000	Additive Summary	UNKNOWN	Water	Ingredients	212606.11409	lbs	0.17	HALLIBURTON				
35051242130000	Additive Summary	UNKNOWN			619.24405	lbs	0	HALLIBURTON				
35051242130000	Additive Summary	UNKNOWN			34976.66021	lbs	0.03	HALLIBURTON				

No treatment detail data available for this treatment job.

TREATMENT JOB #2 - 35051242130000												
Source:	State Agency	Job Start Date:		Job End Date:	01-30-2018	Treatment Top:	11578 ft					
Treatment Bottom:	16130 ft	Treatment Formation:	WOODFORD	Stage Count:		Total Proppant:	8915350 lbs					
Total Fluid:	336131 bbl	Total Water:		Total Additive:		Max Treatment Rate:						
Max Treatment Pressure:		Frac Vendor:		Treatment Type:		Remarks:	Acid Type: 576 BBLS, Frac Type: 8.915.350 LBS PROPPANT; 335.555 BBLS FLUID					

TREATMENT DETAIL FOR JOB #2 - 35051242130000												
API #	Source	Purpose	Material Name	Trade Name	Material Amount	Material Unit	Material Mass Concentration (%)	Supplier Name	Proppant Type	Proppant Mesh Size	Sand Quality	Cement Class
35051242130000	State Agency	ACID	acid type :		24192	GALS						
35051242130000	State Agency	FLUID	fluid		14093310	GALS						

WELL DATA CARDS - EATON FARMS 20-9-6 2H



Well Card Details

2018-12-11

API #	Source	Purpose	Material Name	Trade Name	Material Amount	Material Unit	Material Mass Concentration (%)	Supplier Name	Proppant Type	Proppant Mesh Size	Sand Quality	Cement Class
35051242130000	State Agency	PROPPANT	proppant		8915350	LBS			SAND			

No treatment detail data available for this treatment job.

No treatment job data available for this well.

No completion data available for this well.

FORMATIONS

FORMATIONS

No formation data available for this well.

WELL TESTS

PRODUCTION

Test Date	Hours Tested	GOR	Casing Pressure (psi)	Flowing Tubing Pressure (psi)	Initial Shut In Pressure (psi)	Choke Size	Oil/Liquid Gravity	Gas Gravity	Oil Volume (bbl)	Gas Volume (Mcf)	Water Volume (bbl)	Test Type	Production Method
03-09-2018		2656			4823	0.750	46		494	1312	52	InitialPotentialTest	

No production test data available for this well.

DRILL STEM TESTS

No drill stem test data available for this well.

DRILL STEM TEST PIPE RECOVERY

No pipe recovery data data available for this well.

DRILL STEM TEST FLOW PERIODS

No flow period data available for this well.

PRODUCTION

API # 35051242130000

SUMMARY

Producing Entity:	WELL	Max Active Wells:	1	Cumulative Gas:	90241	Oil EUR:	
Reservoir:	WOODFORD	First Prod Date:	01-01-2018	Peak Oil:	5780	Gas EUR:	
District:	(NA)	Last Prod Date:	05-01-2018	Peak Gas:	37182	Oil Gatherer:	COFFEYVILLE RESOURCES REFINING & MARKETING LLC
Lease:	EATON FARMS 20-9-6	Months Producing:	5	Daily Oil:	99	Gas Gatherer:	ENLINK OKLAHOMA GAS PROCESSING LP
Latest Well Count:	1	Cumulative Oil:	14974	Daily Gas:	598		

PRODUCTION

Date	Monthly Oil (bbl)	Monthly Gas (Mcf)	Monthly Water (bbl)	Avg Daily Oil (bbl)	Avg Daily Gas (Mcf)	Avg Daily Water (bbl)	Wells	Days
01-01-2018	0	441	0	0	14.23	0	1	
02-01-2018	5780	37182	0	206.43	1327.93	0	1	
03-01-2018	4504	36004	0	145.29	1161.42	0	1	
04-01-2018	2362	16614	0	78.73	553.8	0	1	
05-01-2018	2328	0	0	75.1	0	0	1	

No production data available for this well.

CHART

Monthly Production

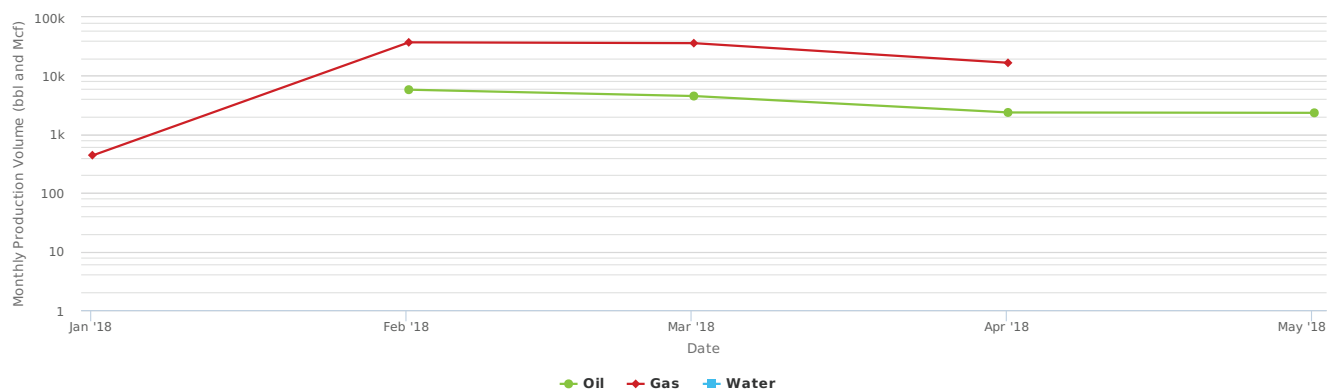

No production time series data available for this well.

WELL DATA CARDS - EATON FARMS 20-9-6 2H



No production data available for this well.

Well Card Details

2018-12-11

HISTORY

HISTORY		
Effective Date	Operator	Activity
03-09-2018		Well Test
01-30-2018	JONES ENERGY	Completion
01-30-2018	JONES ENERGY, LTD.	Production
01-01-2018	JONES ENERGY, LTD.	Production
11-01-2017	JONES ENERGY	Permit
10-29-2017	JONES ENERGY	Spud

No history data available for this well.

THURSDAY, JANUARY 31 • 1:00 PM

DIVISION ORDERS



800.451.2709
SchraderAuction.com

 **SCHRADER**
Real Estate and Auction Company, Inc.

DIVISION ORDERS

NADOA Model Form Division Order (Adopted 9/95)

DIVISION ORDER

To: **Jones Energy, LLC**
807 Las Cimas Parkway, Suite 350
Austin, TX 78746
Attn: Division Order Analyst

Date: January 7, 2019

Property Number: 565009
Property Name: Eaton Farms 20-9-6 1H
Operator: Jones Energy, LLC
County and State: Grady, Oklahoma
Property Description: No legal description on file

Effective Date: Date of First Sales

Production: Oil Gas

Owner Name and Address:

OWNER NUMBER: 20077

MARY AND JAMES HARRISON FOUNDATION BOKF, NA,
PO BOX 1588
TULSA, OK 74101

Type of Interest: RI
Decimal Interest: 0.00195313

The undersigned certifies the ownership of their decimal interest in production or proceeds as described above payable by **Jones Energy, LLC (Payor)**.

Payor shall be notified, in writing, of any change in ownership, decimal interest, or payment address. All such changes shall be effective the first day of the month following receipt of such notice.

Payor is authorized to withhold payment pending resolution of a title dispute or adverse claim asserted regarding the interest in production claimed herein by the undersigned. The undersigned agrees to indemnify and reimburse Payor any amount attributable to an interest to which the undersigned is not entitled.

Payor may accrue proceeds until the total amount equals \$100.00 or more, or until twelve months' proceeds accumulate, whichever occurs first, or as required by applicable state statute.

This Division Order **does not amend** any lease or operating agreement between the undersigned and the lessee or operator or any other contracts for the purchase of oil or gas.

In addition to the terms and conditions of this Division Order, the undersigned and Payor may have certain statutory rights under the laws of the state in which the property is located.

Special Clauses: *(None or See Attached Exhibit)*

Owner(s) Signature(s):

MARY AND JAMES HARRISON

Owner(s) Tax I.D. Number(s): _____

Owner Daytime Telephone _____

Owner FAX Telephone #: _____

Email address: _____

Federal Law requires you to furnish your Social Security or Taxpayer Identification Number.
Failure to comply will result in 24% tax withholding and will not be refundable by Payor.

cb

Sign and return this original

RET'D JAN 18 2019

DIVISION ORDERS

NADOA Model Form Division Order (Adopted 9/95)

DIVISION ORDER

To: **Jones Energy, LLC**
807 Las Cimas Parkway, Suite 350
Austin, TX 78746
Attn: Division Order Analyst

Date: January 7, 2019

Property Number: 565189
Property Name: Eaton Farms 20-9-6 2H
Operator: Jones Energy, LLC
County and State: Grady, Oklahoma
Property Description: No legal description on file

Effective Date: Date of First Sales

Production: Oil Gas

Owner Name and Address:	OWNER NUMBER:	20077
MARY AND JAMES HARRISON FOUNDATION BOKF, NA, PO BOX 1588 TULSA, OK 74101	Type of Interest:	RI
	Decimal Interest:	0.00195313

The undersigned certifies the ownership of their decimal interest in production or proceeds as described above payable by **Jones Energy, LLC (Payor)**.

Payor shall be notified, in writing, of any change in ownership, decimal interest, or payment address. All such changes shall be effective the first day of the month following receipt of such notice.

Payor is authorized to withhold payment pending resolution of a title dispute or adverse claim asserted regarding the interest in production claimed herein by the undersigned. The undersigned agrees to indemnify and reimburse Payor any amount attributable to an interest to which the undersigned is not entitled.

Payor may accrue proceeds until the total amount equals \$100.00 or more, or until twelve months' proceeds accumulate, whichever occurs first, or as required by applicable state statute.

This Division Order **does not amend** any lease or operating agreement between the undersigned and the lessee or operator or any other contracts for the purchase of oil or gas.

In addition to the terms and conditions of this Division Order, the undersigned and Payor may have certain statutory rights under the laws of the state in which the property is located.

Special Clauses: *(None or See Attached Exhibit)*

Owner(s) Signature(s): _____
MARY AND JAMES HARRISON

Owner(s) Tax I.D. Number(s): _____

Owner Daytime Telephone: _____

Owner FAX Telephone #: _____ Email address: _____

Federal Law requires you to furnish your Social Security or Taxpayer Identification Number.
Failure to comply will result in 24% tax withholding and will not be refundable by Payor.

cb

Sign and return this original

RET'D JAN 18 2019

DIVISION ORDERS



RECEIVED DIVISION ORDER

110 N. Robinson, Suite 400
Oklahoma City, OK 73102 USA
Tel: 405/236-3046 Fax: 405/232-4818

JUN 09 2011

Date: 6/01/11

by _____

Property Number: 154700
Property Name: STANLEY #1-20
Operator: Okland Oil Company
County and State: GRADY OK
Property Description: SEC. 020-009N-006W

Effective Date: 4/01/11

Acct. # 19882012
Adm/BK CMT-BOX-20
Asset E 4112777
Date Mailed JUN 21 2011

Production: Oil Gas Other

Owner Name: MARY AND JAMES HARRISON FOUNDATION
Address: C/O BANK OF OKLAHOMA, N.A., AGENT
PO BOX 3499
TULSA OK 74101

Owner Number: HAR183
Decimal Interest/ Type of Interest: 0.00146484/ROY

The undersigned certifies the ownership of their decimal interest in production or proceeds as described above payable by Okland Oil Company.

Okland Oil Company shall be notified in writing, of any change in ownership, decimal interest, or payment address. All such changes shall be effective the first day of the month following receipt of such notice.

Okland Oil Company is authorized to withhold payment pending resolution of a title dispute or adverse claim asserted regarding interest in production claimed herein by the undersigned. The undersigned agrees to indemnify and reimburse Okland Oil Company any amount attributable to an interest the undersigned does not own.

Okland Oil Company may accrue proceeds until the total amount equals ~~\$100.00~~ \$25.00, or pay annually, whichever occurs first, or as required by applicable state statute.

This Division Order does not amend any lease or operating agreement between the undersigned and the lessee or operator or any other contract for the purchase of oil or gas.

In addition to the terms and conditions of this Division Order, the undersigned and Okland Oil Company may have certain statutory rights under the laws of the state in which the property is located.

Special Clauses: _____

Tax ID: 27-4461173

Owner(s) Signature(s): _____

MARY & JAMES HARRISON FOUNDATION
BOKF, NA, Agent
P. O. Box 1588
Tulsa, OK 74101

Owner(s) Tax I.D. Number(s): _____

By: Trent A. Baulch

Owner Home Telephone #: _____

Trent A. Baulch
Senior Vice President
Managing Director, Mineral Management

Owner Work Telephone #: _____

If any provisions contained herein conflict with any provisions in the lease, the provisions in the lease shall prevail. Only such deductions as stipulated in Federal Law Requires you to furnish your Social Security or Taxpayer Identification Number. Failure to comply will result in 31% tax withholding and will not be refundable by Okland Oil Company.

Please pay monthly when any payable amount is \$5.00 or more not less than one annual report amount due.

THURSDAY, JANUARY 31 • 1:00 PM

SOURCE TITLE DOCUMENTS



800.451.2709
SchraderAuction.com

 **SCHRADER**
Real Estate and Auction Company, Inc.

SOURCE TITLE DOCUMENTS

GRADY COUNTY, OKLAHOMA
PREPARED BY & RETURN TO:
Bank of Oklahoma, N. A.
Attn: Stephanie Johnson
P. O. Box 2300
Tulsa, OK 74102-9904

I-2011-005793 Book 4369 Pg: 329
.04/20/2011 10:21 am Pg 0328-0331
Fee: \$ 17.00 Doc: \$ 0.00
Sharon Shoemaker - Grady County Clerk
State of Oklahoma

QUITCLAIM MINERAL DEED



KNOW ALL MEN BY THESE PRESENTS:

THAT **BOKF, NA, FORMERLY BANK OF OKLAHOMA, N.A., TRUSTEE OF THE J. JAMES HARRISON MARITAL TRUST**, hereinafter called GRANTOR, for and in consideration of the sum of Ten Dollars (\$10.00), cash in hand paid and other good and valuable considerations, the receipt and sufficiency of which is hereby acknowledged, do hereby grant, bargain, sell, convey, transfer, assign, deliver and quitclaim unto:

**Mary and James Harrison Foundation
Charles William Harrison, Jr., Robert Theodore Harrison,
David Bishop Harrison, and John Josiah Harrison, Trustees
BOKF, NA, formerly Bank of Oklahoma, N.A., Agent
P.O. Box 1588
Tulsa, OK 74101**

hereinafter called GRANTEE, all of Grantor's right, title and interest in and to all of the oil, gas and other minerals in and under and that may be produced from the lands described in Exhibit "A", attached hereto and made a part of, situated in **Grady County, State of Oklahoma**, and including but not limited to any and all after-discovered mineral interests situated in said County and State, whether or not said lands and/or interests be omitted from or incorrectly described; together with the right of ingress and egress at all times for the purpose of mining, drilling, exploring, operating and developing said lands for oil, gas and other minerals, storing, handling, transporting and marketing the same therefrom with the right to remove from said land all of Grantee's property and improvements.

EXEMPT DOCUMENTARY STAMP TAX OS TITLE 68, ARTICLE 32, SECTION 3202, PARAGRAPH 4.

THIS transfer and conveyance is made subject to all valid subsisting oil and gas lease(s) of record heretofore executed; it being understood and agreed that said Grantee shall have, receive and enjoy the herein granted undivided interest in and to all bonuses, rents, royalties and other benefits which may accrue under the terms of said lease(s) insofar as it covers the herein described property.

GRANTOR MAKES NO REPRESENTATIONS OR WARRANTIES FOR ANY PURPOSE WHATSOEVER AS TO THE QUALITY, QUANTITY, USABILITY, SUITABILITY, MINEABILITY, VALUE OR CONDITION OF THE HERETO DESCRIBED PROPERTY, INCLUDING THE OIL, GAS AND ALL OTHER MINERALS WHICH MAY OR MAY NOT BE PRESENT THEREIN, AND SAID PROPERTY TOGETHER WITH ITS ENVIRONMENTAL CONDITION IS HEREBY SOLD, CONVEYED, TRANSFERRED, ASSIGNED AND DELIVERED TO GRANTEE ON AN "AS-IS AND WHERE-IS" BASIS.

SOURCE TITLE DOCUMENTS

THIS TRANSFER AND CONVEYANCE IS MADE WITHOUT ANY WARRANTY OF TITLE, EXPRESS OR IMPLIED.

IT IS Grantor's intent to convey all of its right, title and interest in the property described herein to Grantee.

GRANTOR agrees to execute such further assurances as may be requisite for the full and complete enjoyment of the rights herein granted and likewise agrees that Grantee herein shall have the right at any time to redeem for said Grantor by payment, any mortgage, taxes, or other liens on the above described property, upon default in payment by the Grantor, and be subrogated to the rights of the holder thereof.

TO HAVE AND TO HOLD the property described above with all and singular the rights, privileges and appurtenances thereunto or in any wise belonging to Grantee, their heirs, successors, personal representatives, administrators, executors and assigns forever.

WITNESS Grantor's hand this 14th day of April, 2011.

1-2011-005793 Book 4389 Pg: 330
04/20/2011 10:21 am Pg 0328-0331
Fee: \$ 17.00 Doc: \$ 0.00
Sharon Sheemake - Grady County Clerk
State of Oklahoma

BOKF, NA, FORMERLY BANK OF OKLAHOMA, N.A., TRUSTEE OF THE J. JAMES HARRISON MARITAL TRUST

WITNESS:

Karen L. Holestine, Assistant Cashier





By: 
Trent A. Baulch,
Senior Vice President
Managing Director, Mineral Management
BOKF, NA, Trustee

STATE OF OKLAHOMA }
 } § **CORPORATE ACKNOWLEDGMENT**
COUNTY OF TULSA }

Before me, the undersigned authority, on this 14th day of April, 2011, personally appeared Trent A. Baulch and Karen L. Holestine, known to me to be the identical persons who subscribed the name of BOKF, NA, formerly Bank of Oklahoma, N.A., Trustee of the J. James Harrison Marital Trust, to the foregoing instrument as its Senior Vice President & Managing Director and Assistant Cashier, respectively, and acknowledged to me that they had willingly made and executed it as their free and voluntary act and deed and as the free and voluntary act and deed of such national banking association, as such Trustee, for the uses and purposes therein expressed.

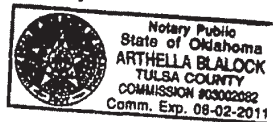
WITNESS my hand and official seal the day and year last above written.



Notary Public

SOURCE TITLE DOCUMENTS

EXHIBIT "A"

This Exhibit "A" is attached to and made a part of that certain Quitclaim Mineral Deed, dated April 14, 2011, between BOKF, NA, formerly Bank of Oklahoma, N.A., Trustee of the J. James Harrison Marital Trust, as GRANTOR, and Mary and James Harrison Foundation, as GRANTEE.

GRADY COUNTY, OKLAHOMA

S/2 SW/4, S/2 NW/4 SW/4, SE/4 NE/4 SW/4 and S/2 SW/4 NE/4 SW/4 ✓
In Section 11, Township 4 North, Range 5 West;

NW/4 SW/4, W/2 NW/4 in Section 14, Township 4 North, Range 5 West; ✓

NW/4 NW/4 NE/4; N/2 NE/4 NW/4; Lot 1, and West 17.44 acres, and North 10 acres, NE 10 acres of Lot 2; and NW 8.77 acres of Lot 3 in Section 18, Township 8 North, Range 5 West; ✓

N/2 in Section 20, Township 9 North, Range 6 West. ✓

1-2011-005793 Book 4369 Pg: 331
04/20/2011 10:21 am Pg 0328-0331
Fee: \$ 17.00 Doc: \$ 0.00
Sharon Shoemaker - Grady County Clerk
State of Oklahoma

THURSDAY, JANUARY 31 • 1:00 PM

OIL & GAS LEASE



800.451.2709
SchraderAuction.com

SCHRADER
Real Estate and Auction Company, Inc.

OIL & GAS LEASE



2017-010220 Book 5216 Page 153
5/4/2017 3:33 PM Pg 153-156
Fee: \$19.00 Doc: \$0.00
Sharon Shoemake- Grady County Clerk
State of Oklahoma Page 1 of 4



TR

OIL AND GAS LEASE (PAID-UP)

THIS LEASE is made effective the 7th day of March, 2017, by and between BOKF, NA, as Agent for Charles Harrison, Robert Harrison, David Harrison and James Harrison, Co-Trustees of the Mary and James Harrison Foundation, whose address is P.O. Box 3499, Tulsa, Oklahoma 74101, Party of the first part, hereinafter called Lessor (whether one or more), and TPR Mid-Continent, LLC, a Delaware limited liability company, whose address is 9020 Capital of Texas Hwy N., Building 1, Suite 170, Austin, Texas 78759, Party of the second part, hereinafter called Lessee.

1. That Lessor, for and in consideration of the cash bonus in hand paid, the receipt and sufficiency of which is hereby acknowledged, and of the covenants and agreements hereinafter contained on the part of Lessee to be paid, kept and performed, hereby grants, leases and lets unto Lessee, for the sole and only purpose of exploring by geophysical and other methods, mining and operating for oil (including but not limited to distillate and condensate), gas (including casinghead gas and helium and all other constituents), and for laying pipe lines, and building tanks, power stations and structures thereon, to produce, save and take care of said products, all that certain tract of land, together with any reversionary rights therein, situated in the County of Grady, State of Oklahoma, described as follows, to-wit:

The N/2 NW/4 and the N/2 S/2 NW/4

of Section 20, Township 9N, Range 6W, and containing 120.0 acres, more or less (herein called "leased premises").

2. This lease is a "paid-up" lease requiring no rentals, and shall remain in force for a term of three (3) years from the above date (herein called primary term) and as long thereafter as oil or gas, or either of them, is produced from the leased premises by the Lessee.

3. The rights granted in this lease are limited to those of the mineral estate. No rights of a surface owner, including Lessor, are granted or conveyed by this lease.

4. Lessee shall deliver to the credit of Lessor, free of cost, in the pipe line to which it may connect its well, the one-fourth (1/4) part of all oil (including but not limited to condensate and distillate) produced and saved from the leased premises.

5. Lessee shall pay Lessor for gas of whatsoever nature or kind (with all of its constituents) produced and sold or used off the leased premises, or used in the manufacture of products therefrom, one-fourth (1/4) of the gross proceeds received, said payments to be made monthly.

6. During any period after expiration of the primary term when gas is not being sold or used and the well or wells are shut in and there is no current production of oil or operations on the leased premises sufficient to keep this lease in force, Lessee shall pay to Lessor a royalty of five dollars (\$5.00) per year per net mineral acre retained hereunder, such payment to be made on or before the anniversary date of this lease next ensuing after the expiration of ninety (90) days from the date such well is shut in and thereafter on the anniversary date of this lease during the period such well is shut in. When such payment is made it will be considered that gas is being produced within

OIL & GAS LEASE



2017-010220 Book 5216 Page 154
5/4/2017 3:33 PM Pg 153-156
Fee: \$19.00 Doc: \$0.00
Sharon Shoemake- Grady County Clerk
State of Oklahoma Page 2 of 4

the meaning of the entire lease. This lease may not be maintained for a period of time longer than twenty-four (24) consecutive months solely by this provision.

7. Lessee shall pay Lessor for gas produced from any oil well and used off the leased premises, or for the manufacture of casing-head gasoline or dry commercial gas, **one-fourth (1/4)** of the gross proceeds, calculated at the wellhead, received by Lessee for the gas during the time such gas is used, said payments to be made monthly.

8. For the purpose of calculating royalty payments hereunder on all production from the leased premises, such calculations shall be made at the point of sale and shall be free of any and all delivery costs and shall not be burdened by any costs of production, including but not limited to, transportation expenses or any expenses associated with or attributable to treatment, gathering, trucking, processing or pipeline construction and maintenance.

9. Lessee shall have the right to pool into a separate operating unit or units the leased premises or any portion or portions thereof, as to all strata or any stratum or strata, with any other lands as to all strata or any stratum or strata, for the production primarily of oil or primarily of gas with or without distillate. The unit(s) formed by such pooling for an oil well which is not a horizontal completion shall not exceed 40 acres, and for a gas well or a horizontal completion shall not exceed 640 acres; provided that if any governmental regulation shall prescribe or permit a spacing pattern for the development of the field or allocate a producing allowable based on acreage per well, then any such unit may embrace as much additional acreage as may be so prescribed or permitted or as may be used in such allocation of allowable. Lessee shall provide Lessor with a copy of any unit designations filed in the County in which the leased premises are located. Operations upon and production from the unit shall be treated as if such operations were upon or such production were from the leased premises whether or not the well or wells are located thereon. In respect to production from the unit, Lessee shall pay Lessor, in lieu of other royalties thereon, only such proportion of the royalties, stipulated herein as the amount of his acreage placed in the unit, or Lessor's royalty interest therein on an acreage basis bears to the total acreage in the unit.

10. If Lessee shall commence to drill a well or commence reworking operations on an existing well within the term of this lease or any extension thereof, the Lessee shall have the right to drill such well to completion or complete reworking operations with reasonable diligence and dispatch, and if oil or gas, or either of them, be found in paying quantities, this lease shall continue and be in force with like effect as if such well had been completed within the primary term or extension thereof.

11. At the expiration of the primary term of this lease or any extension thereof which may occur in accordance with any provisions contained in this lease, rights under this lease shall terminate as to any part or parts of the leased premises not then included within a well unit or units from which production of either oil, gas or other related hydrocarbons and constituent elements (including sulfur) is being obtained.

12. At the expiration of the primary term of this lease or any extension thereof which may occur in accordance with any provisions contained in this lease, rights under this lease shall terminate as to all depths below the base of the deepest producing formation in any well commenced on or before the expiration of the primary term or extension thereof, on the leased premises.

OIL & GAS LEASE



2017-010220 Book 5216 Page 155
5/4/2017 3:33 PM Pg 153-156
Fee: \$19.00 Doc: \$0.00
Sharon Shoemake- Grady County Clerk
State of Oklahoma Page 3 of 4

13. If Lessor owns a less interest in the above described leased premises than the entire and undivided fee simple estate therein, then the royalties herein provided shall be paid to Lessor only in the proportion which Lessor's interest bears to the whole and undivided fee.

14. Lessee shall have the right to use, free of cost, gas and oil produced on the leased premises for its operation thereon.

15. Lessee shall pay for all damages caused by its operations on the leased premises.

16. Lessee shall have the right at any time to remove all machinery and fixtures placed on the leased premises, including the right to draw and remove casing.

17. The privilege of assigning this lease in whole or in part is expressly allowed. If less than the entire lease and all rights thereunder are assigned to a single assignee effective the same date in a single document, the assigned and unassigned portions shall be considered and treated as separate leases. No change or division in ownership of the land or royalties shall enlarge the obligations or diminish the rights of Lessee. No change in the ownership of the leased premises or royalties shall be binding on the Lessee until it has been furnished with a written transfer or assignment or a recorded copy thereof indicating it has been recorded in the County records where the leased premises are located. In the event Lessee assigns this lease, in whole or in part, Lessee shall be relieved of all obligations with respect to the assigned portion or portions arising subsequent to the effective date of the assignment. Lessee shall record any such assignment in the County records and furnish Lessor a copy of such assignment within 60 days of its recording in the County records.

18. All express or implied covenants of this lease shall be subject to all Federal and State Laws, Executive Orders, Rules and Regulations, and this lease shall not be terminated, in whole or in part, nor Lessee held liable in damages, for failure to comply therewith, if compliance is prevented by, or such failure is the result of, any such Law, Order, Rule or Regulation.

19. Lessee may surrender this lease as to any part or parts of the leased premises by placing a release of record in the proper county and mailing a copy of the recorded release to Lessor.

20. Lessee, at its option, 30 days after giving notice to Lessor, shall have the right to redeem for Lessor by payment any mortgages, taxes or other liens on the above described leased premises, and be subrogated to the rights of the holder thereof, and thereupon Lessee shall be relieved from all obligations and liabilities thereafter accruing but not theretofore accrued.

21. If requested in writing by Lessor, Lessee shall provide copies, if any, of the following related to all wells drilled by Lessee on the leased premises or lands pooled therewith: daily drilling reports; logs; reports; records of production; all forms furnished to any governmental authority having jurisdiction over activities conducted pursuant to this lease; plugging reports, and; copies of all drill stem tests. No interpretive data or information, or proprietary or licensed software is to be included in the information provided. Lessor shall maintain confidentiality of all such information furnished by Lessee and shall communicate no part thereof to third parties except Lessor's consultants and advisors.

22. This lease is given and granted without warranty, express or implied, in law or in equity.

23. Lessee shall be and will remain solely responsible for any and all liability arising from or otherwise resulting from its operations conducted on or for the benefit of the leased premises, and will indemnify Lessor and hold Lessor harmless from any loss, claim or damage in such respect,

OIL & GAS LEASE



2017-010220 Book 5216 Page 156
5/4/2017 3:33 PM Pg 153-156
Fee: \$19.00 Doc: \$0.00
Sharon Shoemake- Grady County Clerk
State of Oklahoma Page 4 of 4

including, but not by way of limitation, the proper plugging and abandonment of all wells drilled thereon under the terms of this lease.

24. Lessee represents that Lessee is not an officer, director, or employee of BOK Financial Corporation, its subsidiaries, or any of its member banks, nor is Lessee acting on behalf of any such officer, director or employee.

25. This lease and all its terms and conditions shall extend to and be binding on the parties hereto, their successors, heirs, administrators and assigns.

IN TESTIMONY WHEREOF, this instrument is made effective on the date first written above.

**MARY AND JAMES HARRISON
FOUNDATION**

Greg Collins
Senior Vice President
BOKF, NA, as Agent for Charles Harrison,
Robert Harrison, David Harrison and
James Harrison, Co-Trustees
(Lessor)

STATE OF OKLAHOMA § *CORPORATE ACKNOWLEDGMENT*
§
COUNTY OF TULSA §

Before me, the undersigned authority, on this 7th day of March, 2017, personally appeared Greg Collins, known to me to be the identical person whose name is subscribed on the foregoing instrument as Senior Vice President of BOKF, NA and acknowledged to me that he executed the same for the purposes and consideration therein expressed, in the capacity stated, and as the act and deed of said national banking association.

WITNESS my hand and official seal the day and year last above written.

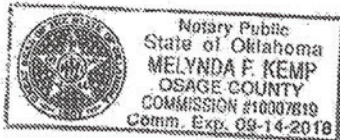

Notary Public

OIL & GAS LEASE



BOK FINANCIAL
THE PRIVATE BANK

January 26, 2018

PO Box 3499
Tulsa, Oklahoma 74101

Jones Energy, LLC
Attn: Jerad Abbott
8308 N. May Ave., Suite #100
Oklahoma City, OK 73120

RE: **Mary & James Harrison Foundation (Respondent #40)**
Order No. 672457
Cause CD No. 201704042
Legal Description: 20-9N-6W
Grady County, Oklahoma

To Whom It May Concern:

In regard to the subject Order, this interest is currently under lease to TPR Mid-Continent, LLC; a copy of the lease is attached.

In the event there is an interest owned by the Mary & James Harrison Foundation that is not included in the attached lease, or for some reason you do not accept the lease as validly covering the interests, then BOKF, NA, as Agent for the above-named Respondent, elects to accept the alternative set forth in paragraph 2 (e): "\$2,000.00 per acre cash, plus overriding or excess royalty of 1/8 (for a total royalty of 1/4)."

As specified in the Order, payment "shall be paid... within 35 days from the date of this Order." Accordingly, we must receive payment by February 26th, 2018 for you to maintain compliance with the Order. Please forward check to:

Bank of Oklahoma
P O Box 3499
Tulsa, OK 74101
Attn: Tracey Prodger

Sincerely,

Adam L. Finfrock

Adam L. Finfrock
Vice President and Assistant Land Manager

ALF/msk

P.O. Box 3499 • Tulsa, Oklahoma 74101 • Fax (918) 595-6953

OIL & GAS LEASE



BOK FINANCIAL®
THE PRIVATE BANK

Bank of Oklahoma Tower
PO Box 3499
Tulsa, Oklahoma 74101-3499

August 14, 2017

Newfield Exploration Mid-Continent, Inc.
24 Waterway Ave., Suite 900
The Woodlands, TX 77380

RE: **Mary and James Harrison Foundation (Respondent # 59)**
Pooling Order No. 666333
Cause CD No. 201605540-T
Legal Description: 14-4N-5W
Grady County, Oklahoma

To Whom It May Concern:

In regard to the subject Order, this interest appears to not require an election because the Respondent's name appears for curative purposes, or for some other reason would be subject to the election of another respondent. In the event any interest of the Respondent remains subject to the election requirements, BOKF, NA, as Agent for the above-named Respondent, hereby elects to accept the alternative set forth in paragraph 6(4): "Cash Consideration of \$1500.00 per acre and 1/5 Total Royalty."

As specified in the Order, payment "shall be paid...within 35 days from the date of this Order." Accordingly, we must receive payment by August 31st, 2017 for you to maintain compliance with the Order. Please forward check to:

Bank of Oklahoma
P O Box 3499
Tulsa, OK 74101
Attn: Tracey Prodger
Sincerely,

Sincerely,

Adam L. Finfrock

Adam L. Finfrock
Vice President and Assistant Land Manager

ALF/msk

P.O. Box 3499 • Tulsa, Oklahoma 74101 • Fax (918) 595-6953

THURSDAY, JANUARY 31 • 1:00 PM

CONVEYING MINERAL DEED



800.451.2709
SchraderAuction.com

 **SCHRADER**
Real Estate and Auction Company, Inc.

CONVEYING MINERAL DEED

COUNTY,
PREPARED BY: STEPHANIE CATTERSON
BOKF, NA

EXHIBIT B-5

(to be attached as Ex. E to the Agreement to Purchase)

MINERAL DEED

KNOW ALL MEN BY THESE PRESENTS:

THAT _____, hereinafter called GRANTOR, for and in consideration of the sum of Ten Dollars (\$10.00), cash in hand paid and other good and valuable considerations, the receipt and sufficiency of which is hereby acknowledged, do hereby grant, bargain, sell, convey, transfer, assign, and deliver unto:

hereinafter called GRANTEE, all of Grantor's right, title and interest in and to all of the oil, gas and other minerals in and under and that may be produced from the lands described below, situated in _____ County, State of _____, to-wit:

INSERT LEGAL DESCRIPTION

together with the right of ingress and egress at all times for the purpose of mining, drilling, exploring, operating and developing said lands for oil, gas and other minerals, storing, handling, transporting and marketing the same therefrom with the right to remove from said land all of Grantee's property and improvements.

THIS transfer and conveyance is made subject to all valid subsisting oil and gas lease(s) of record heretofore executed; it being understood and agreed that said Grantee shall have, receive and enjoy the herein granted undivided interest in and to all bonuses, rents, royalties and other benefits which may accrue under the terms of said lease(s) insofar as it covers the said described property from the Effective Date hereinafter defined.

GRANTEE REPRESENTS AND WARRANTS IT HAS EXAMINED TITLE TO THE EXTENT GRANTEE DEEMS NECESSARY AND THUS ACCEPTS TITLE IN ITS CURRENT CONDITION. MOREOVER, GRANTEE UNDERSTANDS AND ACCEPTS THAT THIS DEED IS MADE WITHOUT WARRANTY OF TITLE, EXPRESS OR IMPLIED AND GRANTOR SHALL NOT BE OBLIGATED FOR ANY TITLE CURATIVE SUBSEQUENT TO EXECUTION OF THIS DEED. GRANTOR MAKES NO REPRESENTATIONS OR WARRANTIES FOR ANY PURPOSE WHATSOEVER AS TO THE QUALITY, QUANTITY, USABILITY, SUITABILITY, MINEABILITY, VALUE OR CONDITION OF THE SAID DESCRIBED PROPERTY, INCLUDING THE OIL, GAS AND ALL OTHER MINERALS

CONVEYING MINERAL DEED

WHICH MAY OR MAY NOT BE PRESENT THEREIN, AND SAID PROPERTY TOGETHER WITH ITS ENVIRONMENTAL CONDITION IS HEREBY SOLD, CONVEYED, TRANSFERRED, ASSIGNED AND DELIVERED TO GRANTEE ON AN "AS-IS AND WHERE-IS" BASIS. THIS TRANSFER AND CONVEYANCE IS MADE WITHOUT ANY WARRANTY OF TITLE, EXPRESS OR IMPLIED.

IT is the express intention of Grantor to convey all of its interest described herein to Grantee.

GRANTOR agrees to execute such further assurances as may be requisite for the full and complete enjoyment of the rights herein granted and likewise agrees that Grantee herein shall have the right at any time to redeem for said Grantor by payment, any mortgage, taxes, or other liens on the above described property, upon default in payment by the Grantor, and be subrogated to the rights of the holder thereof.

IT is a condition to this Mineral Deed, as hereafter described, that Grantee, at any time prior to the date of execution of this Mineral Deed was not an employee, affiliate, representative or agent of the Grantor.

IN the event that Grantor determines that Grantee was an employee, affiliate, representative or agent of the Grantor prior to the date of the Mineral Deed, then within sixty days following the date this Mineral Deed is recorded in the records of the office of the clerk in which conveyances of property of the kind and nature conveyed herein are duly recorded (the "Official Records"), this Mineral Deed shall be deemed null and void, provided that Grantor within such sixty day period shall execute and file an Affidavit of Notice of Condition Precedent ("Notice of Condition") in the Official Records stating that Grantor has discovered that Grantee failed to meet the condition precedent to Mineral Deed. In the event that Grantor files a Notice of Condition, Grantor shall pay Grantee the price paid by Grantee for the property described herein, less any fees or costs paid by Grantee, including real estate, brokerage and auction commissions or fees, which shall be borne by the Grantee and which shall not be repaid by Grantor. In the event that Grantor fails to file the Notice of Condition, described herein, within the time period provided hereby, this Mineral Deed shall be deemed to be unconditioned with respect to such limitation and the Grantor shall have no further right to void transfer of the property described herein to the Grantee on such basis.

TO HAVE AND TO HOLD the property described hereto with all and singular the rights, privileges and appurtenances thereunto or in any wise belonging to Grantee, their heirs, successors, personal representatives, administrators, executors and assigns forever.

IN WITNESS WHEREOF, the undersigned have executed this instrument on the date of acknowledgements annexed hereto, but to be made effective for all purposes from and after 7:00 a.m., C.S.T., the ____ day of _____.

By: _____

CONVEYING MINERAL DEED

STATE OF OKLAHOMA }
 } §
COUNTY OF _____ }

ACKNOWLEDGMENT

Before me, the undersigned authority, on this _____ day of _____, 2018, personally appeared _____, to me known to be the identical person who executed the within and foregoing instrument and acknowledge to me that she had willingly made and executed it as her free and voluntary act and deed, for the uses and purposes therein expressed.

WITNESS my hand and official seal the day and year last above written.

Notary Public

DRAFT

THURSDAY, JANUARY 31 • 1:00 PM



 **SCHRADER**
Real Estate and Auction Company, Inc.

PO Box 508

950 North Liberty Drive

Columbia City, IN 46725

800.451.2709

260.244.7606

www.schraderauction.com

NAA
Auctioneer
RC19-731

Follow Us and Get Our New Schrader iOS App:

