

Defiance County  
Mark Center, Ohio

# CATTLE INFORMATION BOOKLET

*Ohio Dairy Dispersal*  
**AUCTION**  
*Visser's Dairy, LLC*

**TUESDAY,  
AUGUST 7th  
10 AM**

 **Online Bidding  
Available**

 **SCHRADER**  
Real Estate and Auction Company, Inc.

800-451-2709 | [SchraderAuction.com](http://SchraderAuction.com)

### **DISCLAIMER:**

This Information Booklet has been assembled on behalf of Vissers Dairy, LLC (collectively, the "Owner") for purposes of the auction to be conducted on August 7, 2018 by Schrader Real Estate and Auction Co., Inc. ("Auction Company"). The information in this booklet consists of: (i) Owner-supplied historical information regarding the property; and (ii) third party information regarding legal, production and permitting information pertaining to the operation of a CAFO permitted dairy.

The Auction Company is not qualified and have not undertaken to evaluate, interpret or vouch for any information or reports regarding any purported legal, production or permitting information of the dairy operation to be offered at auction. The Auction Company has attempted to identify the sources of the information provided herein. If there is any question regarding the source of any information, please contact the Auction Company for clarification.

The marketing materials prepared for this auction, including this Information Booklet, have been designed for prospective bidders who have (or have access to) the expertise necessary to independently evaluate the production and permitting information of the property and the legal issues relevant to the dairy operation offered for sale. Such marketing materials are not intended as a complete record of information pertaining to the property and the dairy operation, nor are they intended as a substitute for a complete and independent investigation and evaluation by a prospective bidder and its qualified advisers. All prospective bidders are responsible for obtaining their own independent technical and legal advice and for conducting their own independent investigation and evaluation of the property and permitting of the dairy operation at the auction and the information and reports provided with respect thereto.

**OWNER'S REPRESENTATIVES MAKE NO REPRESENTATION OR WARRANTY REGARDING THE PROPERTY OR PERMITS REQUIRED FOR OPERATION OF THE DAIRY. AUCTION COMPANY SHALL HAVE NO LIABILITY WITH RESPECT TO, AND HEREBY DISCLAIM ALL REPRESENTATIONS AND WARRANTIES CONTAINED IN, ANY INFORMATION OR REPORTS PROVIDED BY OWNER AND/OR THIRD PARTIES IN CONNECTION WITH THIS AUCTION.**

SELLER: Vissers Dairy, LLC

Auction Company: Schrader Real Estate and Auction Company, Inc.

# Pen #

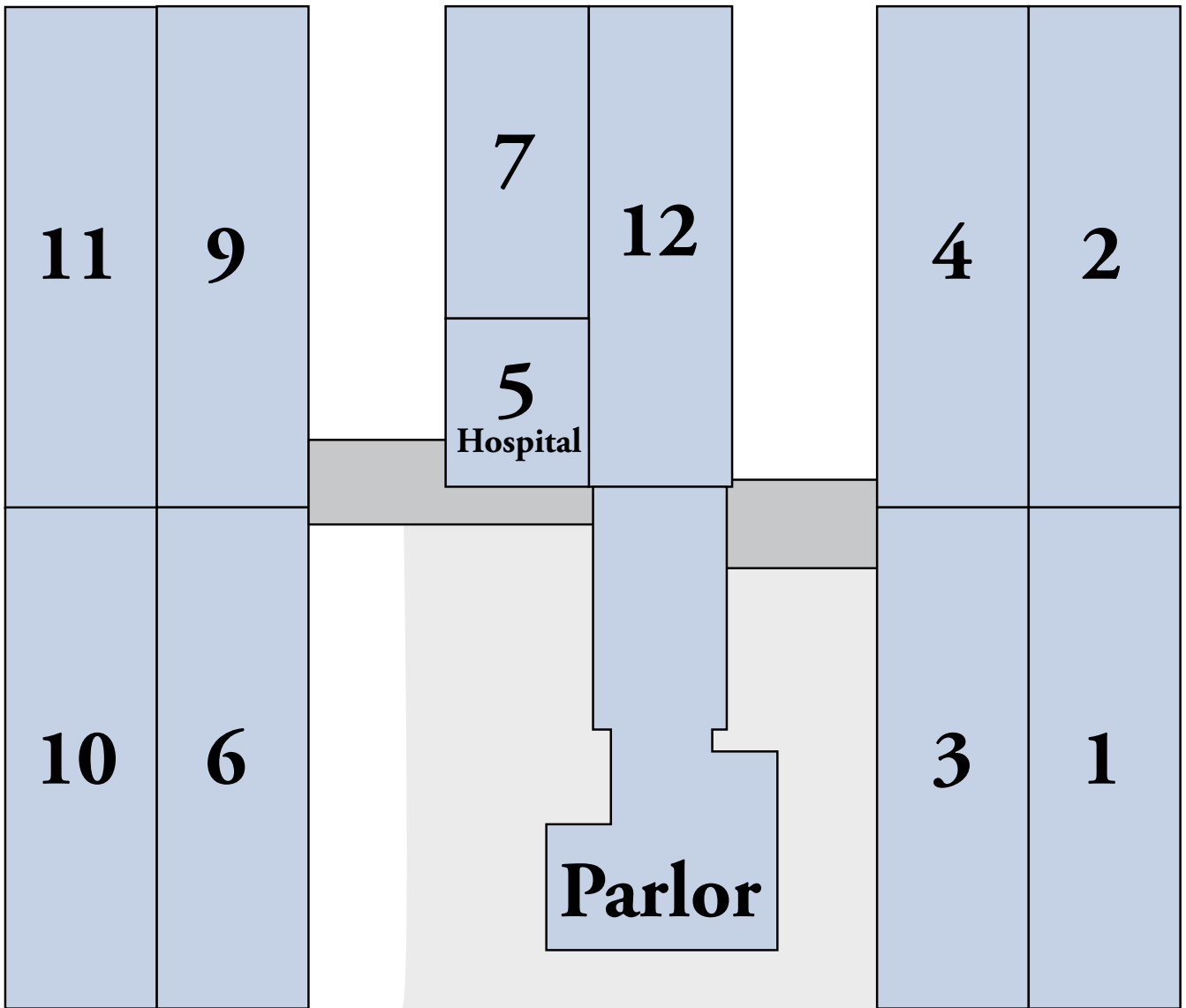



**(36 HEAD)**

**TRACT 6**

ID	LACT	DIM	PEN	RPRO	DCC	SIRC
4122	2	25	6	OK/OPEN	0	-
4140	2	23	6	OK/OPEN	0	-
4147	1	474	12	DRY	266	7AN345
4212	1	430	12	DRY	273	7AN345
4233	2	14	6	OK/OPEN	0	-
4263	2	21	6	OK/OPEN	0	-
4311	2	62	5	OK/OPEN	0	-
4312	1	375	12	DRY	280	7AN345
4315	1	377	12	DRY	280	7AN345
4324	2	19	6	OK/OPEN	0	-
4339	2	20	6	OK/OPEN	0	-
4362	1	374	12	DRY	261	7AN345
4373	1	361	12	DRY	273	7AN345
4375	1	360	12	DRY	266	7AN345
4376	1	332	12	DRY	277	7AN345
4380	1	343	12	DRY	261	7AN345
4395	2	18	6	OK/OPEN	0	-
4396	2	13	6	OK/OPEN	0	-
4397	2	15	6	OK/OPEN	0	-
4398	2	21	6	OK/OPEN	0	-
4405	1	313	12	DRY	269	7AN345
4412	1	371	7	DRY	231	7AN363
4419	1	324	12	DRY	273	7AN345
4421	2	21	6	OK/OPEN	0	-
4422	2	16	6	OK/OPEN	0	-
4428	2	13	6	OK/OPEN	0	-
4435	2	9	6	OK/OPEN	0	-
4438	2	10	6	OK/OPEN	0	-
4445	2	19	6	OK/OPEN	0	-
9019	4	22	6	OK/OPEN	0	-
9144	4	17	6	OK/OPEN	0	-
9520	3	16	16	OK/OPEN	0	-
9612	3	19	6	OK/OPEN	0	-
9688	3	14	6	OK/OPEN	0	-
9883	3	14	6	OK/OPEN	0	-
9901	3	11	6	OK/OPEN	0	-

**(36 HEAD)**

**TRACT 7**

ID	LACT	DIM	PEN	RPRO	DCC	SIRC
4126	2	14	5	OK/OPEN	0	-
4215	2	47	5	OK/OPEN	0	-
4279	2	20	6	OK/OPEN	0	-
4307	2	26	6	OK/OPEN	0	-
4335	2	9	6	OK/OPEN	0	-
4337	1	362	12	DRY	259	7AN345
4387	2	24	6	OK/OPEN	0	-
4420	1	314	12	DRY	267	7AN345
4434	1	311	12	DRY	270	7AN345
4436	1	295	12	DRY	271	7AN345
4437	2	13	6	OK/OPEN	0	-
4446	2	22	6	OK/OPEN	0	-
4450	1	286	12	DRY	270	7AN345
4453	1	296	12	DRY	261	7AN345
4455	1	288	12	DRY	277	7AN345
4458	1	303	12	DRY	264	7AN345
4463	1	305	12	DRY	257	7AN345
7180	8	9	16	OK/OPEN	0	-
7581	7	10	6	OK/OPEN	0	-
9047	3	335	12	DRY	273	7AN345
9172	4	18	6	OK/OPEN	0	-
9219	3	326	12	DRY	280	7AN345
9306	4	18	6	OK/OPEN	0	-
9535	3	151	6	PREG	87	7AN435
9621	3	20	6	OK/OPEN	0	-
9651	2	437	12	DRY	273	7AN345
9721	3	4	16	OK/OPEN	0	-
9723	3	8	16	OK/OPEN	0	-
9740	3	16	6	OK/OPEN	0	-
9745	3	18	6	OK/OPEN	0	-
9763	2	339	12	DRY	273	7AN345
9773	2	318	12	DRY	279	7H12345
9795	3	54	5	OK/OPEN	0	-
9810	3	24	5	OK/OPEN	0	-
9932	3	25	6	OK/OPEN	0	-
9934	2	334	12	DRY	280	7AN345

(35 HEAD)

# TRACT 8

ID	LACT	DIM	PEN	RPRO	DCC	SIRC
2669	4	18	6	OK/OPEN	0	-
2684	4	4	6	OK/OPEN	0	-
3429	5	2	5	OK/OPEN	0	-
4442	2	11	6	OK/OPEN	0	-
4443	2	5	6	OK/OPEN	0	-
6756	8	22	6	OK/OPEN	0	-
8213	6	20	6	OK/OPEN	0	-
8273	5	251	6	PREG	98	7AN449
8435	5	19	6	OK/OPEN	0	-
8660	5	4	6	OK/OPEN	0	-
8699	4	25	6	OK/OPEN	0	-
8900	4	4	6	OK/OPEN	0	-
9037	4	3	6	OK/OPEN	0	-
9059	4	12	6	OK/OPEN	0	-
9094	4	5	6	OK/OPEN	0	-
9139	4	21	6	OK/OPEN	0	-
9229	4	20	6	OK/OPEN	0	-
9286	4	16	6	OK/OPEN	0	-
9316	4	1	6	OK/OPEN	0	-
9345	4	7	6	OK/OPEN	0	-
9367	4	18	6	OK/OPEN	0	-
9636	3	22	6	OK/OPEN	0	-
9669	3	9	5	OK/OPEN	0	-
9770	3	54	5	OK/OPEN	0	-
9884	3	12	6	OK/OPEN	0	-
9888	2	323	12	DRY	268	7AN345
9891	2	341	12	DRY	273	7AN345
9894	2	308	12	DRY	273	7AN345
9895	2	330	12	DRY	273	7AN345
9897	2	311	12	DRY	277	7AN345
9898	2	304	12	DRY	271	7AN345
9909	2	298	12	DRY	267	7AN345
9910	2	305	12	DRY	271	7AN345
9922	2	299	12	DRY	264	7AN345
9964	2	294	12	DRY	265	7AN345

**(36 HEAD)**

**TRACT 9**

ID	LACT	DIM	PEN	RPRO	DCC	SIRC
878	1	223	9	PREG	56	7AN464
881	1	222	9	PREG	119	7AN442
884	1	203	9	PREG	98	7AN432
4074	2	204	9	PREG	124	14AN387
4132	2	201	9	PREG	139	7AN380
4254	1	437	9	PREG	189	7AN399
4430	1	363	9	PREG	195	7AN414
4454	1	328	9	PREG	147	7AN341
4482	1	329	9	PREG	171	7AN380
4485	1	336	9	PREG	168	7AN380
4486	1	319	9	PREG	182	7AN399
4487	1	287	9	PREG	208	7AN408
4488	1	287	9	PREG	133	14AN378
4489	1	287	9	PREG	194	7AN414
4514	1	338	9	PREG	105	7AN432
4522	1	295	9	PREG	205	7AN408
4525	1	282	9	PREG	164	7AN380
4532	1	289	9	PREG	111	7AN432
4534	1	288	9	PREG	171	7AN380
4535	1	292	9	PREG	197	7AN434
4541	1	288	9	PREG	167	7AN380
4556	1	265	9	PREG	119	7AN442
4557	1	265	9	PREG	141	7AN341
4558	1	265	9	PREG	168	7AN380
4559	1	265	9	PREG	119	7AN442
4566	1	257	9	PREG	164	7AN380
4567	1	250	9	PREG	123	7AN371
4568	1	250	9	PREG	187	7AN399
4569	1	250	9	PREG	173	7AN380
4570	1	250	9	PREG	184	7AN399
4571	1	250	9	PREG	173	7AN380
4572	1	250	9	PREG	108	7AN432
4573	1	250	9	PREG	169	7AN380
4576	1	274	9	PREG	176	7AN414
4583	1	266	9	PREG	168	7AN380
4584	1	271	9	PREG	147	7AN341



**(36 HEAD)**

# TRACT 10

ID	LACT	DIM	PEN	RPRO	DCC	SIRC
4585	1	276	9	PREG	174	7AN380
4586	1	273	9	PREG	133	14AN378
4591	1	282	9	PREG	147	7AN341
4592	1	260	9	PREG	161	7AN380
4598	1	236	9	PREG	187	7AN399
4599	1	236	9	PREG	35	7AN471
4600	1	236	9	PREG	140	7AN341
4601	1	236	9	PREG	133	14AN378
4602	1	236	9	PREG	159	7AN371
4610	1	289	9	PREG	194	7AN414
4611	1	245	9	PREG	157	7AN380
4626	1	250	9	PREG	184	7AN399
4627	1	245	9	PREG	90	7AN435
4632	1	255	9	PREG	144	7AN363
4633	1	237	9	PREG	135	7AN363
4637	1	250	9	PREG	119	7AN442
4641	1	250	9	PREG	187	7AN399
4642	1	243	9	PREG	166	7AN380
4656	1	209	9	PREG	131	7AN363
4658	1	209	9	PREG	127	7AN341
4664	1	209	9	PREG	131	7AN363
4681	1	201	9	PREG	105	7AN432
4685	1	201	9	PREG	137	7AN363
4689	1	190	9	PREG	124	14AN387
4695	1	217	9	PREG	138	7AN363
4696	1	218	9	PREG	55	7AN471
4697	1	206	9	PREG	138	7AN363
4700	1	218	9	PREG	121	7AN442
4708	1	217	9	PREG	119	7AN442
4717	1	179	9	PREG	100	14AN387
4728	1	240	9	PREG	161	7AN380
4729	1	209	9	PREG	91	7AN449
4732	1	261	9	PREG	127	7AN341
4733	1	234	9	PREG	126	7AN341
4736	1	225	9	PREG	146	7AN371
4737	1	233	9	PREG	161	7AN380

**(36 HEAD)**

**TRACT 11**

ID	LACT	DIM	PEN	RPRO	DCC	SIRC
4739	1	168	9	PREG	87	7AN435
4741	1	168	9	PREG	99	7AN442
4742	1	168	9	PREG	67	7AN435
4749	1	185	9	PREG	125	7AN442
4752	1	190	9	PREG	124	14AN387
4754	1	187	9	PREG	110	7AN449
4755	1	190	9	PREG	109	7AN432
4757	1	197	9	PREG	102	14AN387
4758	1	194	9	PREG	128	7AN341
4762	1	192	9	PREG	123	7AN371
4763	1	189	9	PREG	99	7AN442
4767	1	192	9	PREG	91	7AN449
4770	1	187	9	PREG	123	7AN371
4777	1	172	9	PREG	70	7AN444
4784	1	195	9	PREG	68	7AN435
4785	1	182	9	PREG	85	7AN444
4786	1	175	9	BRED	0	-
4787	1	200	9	PREG	91	7AN449
4788	1	163	9	BRED	0	-
4789	1	191	9	PREG	103	7AN432
4790	1	180	9	PREG	99	7AN442
4791	1	195	9	PREG	123	7AN371
4796	1	157	9	PREG	89	7AN435
4797	1	158	9	BRED	0	-
4798	1	159	9	PREG	96	7AN371
4809	1	146	9	PREG	49	7AN471
4812	1	155	9	PREG	95	7AN449
4817	1	128	9	PREG	61	7AN449
4820	1	133	9	PREG	35	7AN471
4821	1	132	9	BRED	0	-
4822	1	139	9	BRED	0	-
4824	1	165	9	BRED	0	-
4826	1	130	9	PREG	58	7AN471
4827	1	168	9	BRED	0	-
4828	1	138	9	BRED	0	-
4846	1	80	9	OK/OPEN	0	-

**(33 HEAD)**

# TRACT 12

ID	LACT	DIM	PEN	RPRO	DCC	SIRC
894	1	212	9	PREG	39	7AN471
4267	1	413	12	DRY	259	7AN345
4460	1	330	9	PREG	201	7AN446
4470	1	327	9	PREG	182	7AN399
4474	1	331	9	PREG	108	7AN432
4477	1	329	9	PREG	203	7AN434
4478	1	319	9	PREG	112	7AN449
4480	1	324	9	PREG	187	7AN399
4548	1	274	9	PREG	194	7AN414
4550	1	265	9	PREG	201	7AN446
4552	1	265	9	PREG	84	7AN444
4553	1	265	9	PREG	161	7AN380
4554	1	265	9	PREG	160	7AN380
4561	1	257	9	PREG	87	7AN435
4565	1	257	9	PREG	195	7AN414
4580	1	274	9	PREG	99	7AN442
4588	1	271	9	PREG	208	7AN408
4589	1	269	9	PREG	149	7AN363
4659	1	209	9	PREG	91	7AN449
4701	1	220	9	PREG	49	7AN471
4705	1	202	9	PREG	91	7AN449
4759	1	193	9	PREG	60	7AN471
4765	1	189	9	PREG	56	7AN464
4771	1	188	9	PREG	73	7AN435
4774	1	172	9	BRED	0	-
4803	1	156	9	BRED	0	-
4823	1	119	16	BRED	0	-
4847	1	80	9	BRED	0	-
8552	4	303	12	DRY	255	7AN345
9329	3	336	12	DRY	266	7AN345
9713	3	107	9	BRED	0	-
9794	2	424	6	PREG	206	7AN408
9886	2	338	9	PREG	198	7AN446

**(30 HEAD)**

**TRACT 13**

ID	LACT	DIM	PEN	RPRO	DCC	SIRC
9	5	11	6	OK/OPEN	0	-
404	7	2	16	OK/OPEN	0	-
2667	3	291	12	DRY	275	7AN345
4305	2	9	16	OK/OPEN	0	-
4537	1	286	9	PREG	80	7AN435
4546	1	274	9	PREG	208	7AN408
4551	1	265	9	PREG	49	7AN471
4756	1	194	9	PREG	42	7AN464
4761	1	196	9	BRED	0	-
4766	1	186	9	BRED	0	-
4768	1	190	9	BRED	0	-
4772	1	196	9	BRED	0	-
6658	9	18	6	OK/OPEN	0	-
7988	6	14	6	OK/OPEN	0	-
8055	5	303	12	DRY	271	7AN345
8081	5	307	12	DRY	262	7AN345
8153	5	334	12	DRY	269	7AN345
8454	4	401	12	DRY	273	7AN345
8635	4	335	12	DRY	260	7AN345
8676	5	9	6	OK/OPEN	0	-
9090	4	17	6	OK/OPEN	0	-
9138	4	21	6	OK/OPEN	0	-
9149	4	22	6	OK/OPEN	0	-
9159	4	24	6	OK/OPEN	0	-
9182	4	6	6	OK/OPEN	0	-
9195	4	20	6	OK/OPEN	0	-
9369	3	4	5	OK/OPEN	0	-
9499	3	19	6	OK/OPEN	0	-
9555	3	17	6	OK/OPEN	0	-
9864	3	4	6	OK/OPEN	0	-

(35 HEAD)

TRACT 14

ID	LACT	DIM	PEN	RPRO	DCC	SIRC
4114	2	175	10	PREG	70	7AN435
4137	2	107	10	BRED	0	-
4157	2	93	10	OK/OPEN	0	-
4159	2	37	10	OK/OPEN	0	-
4162	2	30	10	OK/OPEN	0	-
4164	2	53	10	OK/OPEN	0	-
4203	2	33	10	OK/OPEN	0	-
4232	2	53	10	OK/OPEN	0	-
4257	2	35	10	OK/OPEN	0	-
4259	2	54	10	OK/OPEN	0	-
4265	2	30	10	OK/OPEN	0	-
4266	2	105	10	BRED	0	-
4427	1	360	10	PREG	192	7AN407
4810	1	152	10	BRED	0	-
4829	1	106	10	BRED	0	-
4830	1	106	10	BRED	0	-
4831	1	106	10	BRED	0	-
4832	1	106	10	BRED	0	-
4833	1	106	10	BRED	0	-
4834	1	89	10	BRED	0	-
4835	1	89	10	BRED	0	-
4836	1	89	10	BRED	0	-
4837	1	89	10	BRED	0	-
4838	1	80	10	BRED	0	-
4839	1	80	10	OK/OPEN	0	-
4841	1	80	10	OK/OPEN	0	-
4842	1	80	10	OK/OPEN	0	-
4843	1	80	10	OK/OPEN	0	-
4844	1	80	10	BRED	0	-
4845	1	80	10	BRED	0	-
9233	4	54	10	OK/OPEN	0	-
9598	3	46	10	OK/OPEN	0	-
9640	3	93	10	OK/OPEN	0	-
9675	3	103	10	BRED	0	-
9786	3	91	10	BRED	0	-

(35 HEAD)

# TRACT 15

ID	LACT	DIM	PEN	RPRO	DCC	SIRC
4309	2	53	10	OK/OPEN	0	-
4313	2	33	10	OK/OPEN	0	-
4317	2	37	10	OK/OPEN	0	-
4320	2	64	10	OK/OPEN	0	-
4328	2	54	10	OK/OPEN	0	-
4332	2	46	10	OK/OPEN	0	-
4334	2	32	10	OK/OPEN	0	-
4351	2	30	10	OK/OPEN	0	-
4372	2	65	10	OK/OPEN	0	-
4401	1	355	10	PREG	154	7AN371
4402	1	355	10	PREG	101	7AN432
4414	2	46	10	OK/OPEN	0	-
4496	1	310	10	PREG	149	7AN363
4499	1	304	10	PREG	196	7AN399
4500	1	303	10	PREG	112	7AN449
4501	1	301	10	PREG	196	7AN399
4502	1	312	10	PREG	196	7AN399
4504	1	303	10	PREG	182	7AN414
4507	1	305	10	PREG	154	7AN371
4509	1	305	10	PREG	184	7AN399
4510	1	292	10	PREG	84	7AN444
4512	1	331	10	PREG	182	7AN414
4513	1	296	10	PREG	155	7AN380
4520	2	299	10	PREG	147	7AN341
4521	1	290	10	PREG	154	7AN371
4527	1	296	10	PREG	172	7AN380
4538	1	295	10	PREG	128	7AN341
4540	1	296	10	PREG	195	7AN414
4555	1	265	10	PREG	183	7AN399
4560	1	257	10	PREG	126	7AN442
4562	1	257	10	PREG	157	7AN380
4563	1	257	10	PREG	123	7AN371
4564	1	257	10	PREG	84	7AN444
4574	1	250	10	PREG	154	7AN371
4575	1	250	10	PREG	98	7AN432

**(35 HEAD)**

# TRACT 16

ID	LACT	DIM	PEN	RPRO	DCC	SIRC
4577	1	260	10	PREG	161	7AN380
4581	1	248	10	PREG	159	7AN371
4582	1	246	10	PREG	166	7AN380
4590	1	278	10	PREG	161	7AN380
4593	1	263	10	PREG	168	7AN380
4594	1	246	10	PREG	112	7AN449
4597	1	246	10	PREG	149	7AN363
4603	1	236	10	PREG	150	7AN380
4604	1	236	10	PREG	113	7AN432
4612	1	265	10	PREG	142	7AN363
4613	1	252	10	PREG	184	7AN399
4614	1	254	10	PREG	124	14AN387
4615	1	226	10	PREG	126	7AN341
4616	1	226	10	PREG	105	7AN449
4618	1	226	10	PREG	168	7AN380
4619	1	226	10	PREG	98	7AN432
4620	1	277	10	PREG	182	7AN399
4621	1	226	10	PREG	160	7AN380
4622	1	226	10	PREG	157	7AN380
4631	1	249	10	PREG	154	7AN371
4635	1	245	10	PREG	183	7AN399
4647	1	219	10	PREG	104	7AN432
4649	1	219	10	PREG	157	7AN380
4650	1	219	10	PREG	123	7AN371
4651	1	219	10	PREG	159	7AN371
4652	1	219	10	PREG	120	7AN442
4653	1	219	10	PREG	92	7AN449
4654	1	219	10	PREG	152	7AN371
4655	1	219	10	PREG	157	7AN380
4667	1	214	10	PREG	105	7AN432
4668	1	237	10	PREG	133	14AN378
4669	1	221	10	PREG	145	7AN363
4671	1	217	10	PREG	138	7AN363
4673	1	244	10	PREG	134	7AN363
4699	1	205	10	PREG	70	7AN444

(35 HEAD)

# TRACT 17

ID	LACT	DIM	PEN	RPRO	DCC	SIRC
4706	1	205	10	PREG	106	7AN432
4711	1	179	10	PREG	36	7AN471
4712	1	179	10	PREG	117	7AN432
4713	1	179	10	PREG	116	7AN432
4715	1	179	10	PREG	44	7AN471
4716	1	179	10	PREG	117	7AN432
4723	1	176	10	PREG	77	7AN444
4724	1	176	10	PREG	70	7AN444
4725	1	176	10	PREG	89	7AN435
4727	1	200	10	PREG	71	7AN435
4730	1	188	10	PREG	72	7AN435
4734	1	191	10	PREG	113	7AN432
4744	1	168	10	BRED	0	-
4750	1	214	10	PREG	80	7AN435
4751	1	204	10	PREG	116	7AN432
4780	1	147	10	BRED	0	-
4781	1	147	10	OK/OPEN	0	-
4782	1	147	10	PREG	68	7AN435
4783	1	147	10	BRED	0	-
4792	1	133	10	BRED	0	-
4793	1	133	10	BRED	0	-
4794	1	133	10	PREG	47	7AN435
4795	1	150	10	PREG	55	7AN471
4799	1	155	10	BRED	0	-
4800	1	148	10	BRED	0	-
4801	1	153	10	PREG	35	7AN471
4805	1	161	10	BRED	0	-
4806	1	154	10	BRED	0	-
4807	1	155	10	BRED	0	-
4808	1	152	10	BRED	0	-
4811	1	159	10	PREG	63	7AN444
4813	1	118	10	BRED	0	-
4815	1	118	10	BRED	0	-
4816	1	118	10	BRED	0	-
4825	1	130	10	BRED	0	-



**(33 HEAD)**

**TRACT 18**

ID	LACT	DIM	PEN	RPRO	DCC	SIRC
4515	1	292	10	PREG	111	7AN432
4624	1	226	10	PREG	91	7AN449
4628	1	243	10	PREG	100	14AN387
4638	1	245	10	PREG	63	7AN444
4640	1	246	10	PREG	70	7AN444
4646	1	219	10	PREG	69	7AN435
4670	1	218	10	PREG	77	7AN444
4674	1	221	10	PREG	55	7AN471
4676	1	211	10	PREG	59	7AN471
4710	1	210	10	PREG	95	7AN449
7287	7	50	10	OK/OPEN	0	-
7726	6	92	10	BRED	0	-
8571	5	65	10	BRED	0	-
8836	4	93	10	BRED	0	-
8924	4	63	10	OK/OPEN	0	-
8965	4	93	10	OK/OPEN	0	-
9035	4	46	10	OK/OPEN	0	-
9152	3	285	12	DRY	276	7AN341
9161	3	316	12	DRY	269	7AN345
9162	4	91	10	OK/OPEN	0	-
9179	3	356	12	DRY	273	7AN345
9193	3	303	12	DRY	262	7AN345
9198	3	336	12	DRY	266	7AN345
9212	3	303	12	DRY	271	7AN345
9261	3	318	12	DRY	280	7AN345
9272	3	335	12	DRY	261	7AN345
9307	3	334	12	DRY	266	7AN345
9350	3	336	12	DRY	266	7AN345
9372	3	290	12	DRY	265	7AN345
9802	2	371	12	DRY	259	7AN345
9807	2	288	12	DRY	263	7AN345
9867	2	296	12	DRY	264	7AN345
9870	2	306	12	DRY	261	7AN345

**(31 HEAD)**

# TRACT 19

ID	LACT	DIM	PEN	RPRO	DCC	SIRC
443	6	88	11	OK/OPEN	0	-
888	1	207	11	PREG	105	7AN432
4002	2	280	11	PREG	140	7AN341
4017	2	234	11	PREG	140	7AN341
4018	2	231	11	PREG	98	7AN432
4032	2	221	11	PREG	150	7AN380
4036	2	220	11	PREG	96	7AN371
4038	2	199	11	PREG	102	14AN387
4060	2	138	11	PREG	75	7AN444
4064	2	218	11	PREG	152	7AN371
4085	2	87	11	OK/OPEN	0	-
4087	2	197	11	PREG	117	7AN432
4096	2	102	11	PREG	39	7AN471
4102	2	199	11	PREG	108	7AN432
4104	2	201	11	PREG	63	7AN444
4107	2	120	11	BRED	0	-
4120	2	211	11	PREG	77	7AN444
4142	2	198	11	PREG	98	7AN432
4146	2	138	11	PREG	75	7AN444
4177	2	123	11	PREG	54	7AN464
4181	2	138	11	PREG	37	7AN471
4187	2	88	11	OK/OPEN	0	-
4202	2	87	11	BRED	0	-
4217	2	122	11	PREG	40	7AN471
4221	2	123	11	BRED	0	-
4229	2	137	11	OK/OPEN	0	-
4230	2	71	11	OK/OPEN	0	-
4246	2	55	11	OK/OPEN	0	-
4255	2	89	11	BRED	0	-
4264	2	56	11	OK/OPEN	0	-
7975	6	37	11	OK/OPEN	0	-

(31 HEAD)

TRACT 20

ID	LACT	DIM	PEN	RPRO	DCC	SIRC
4274	2	55	11	OK/OPEN	0	-
4281	2	51	11	OK/OPEN	0	-
4287	2	45	11	OK/OPEN	0	-
4297	3	87	11	BRED	0	-
4336	2	52	11	OK/OPEN	0	-
4357	2	55	11	OK/OPEN	0	-
4360	2	51	11	OK/OPEN	0	-
4361	2	53	10	OK/OPEN	0	-
4364	2	61	11	OK/OPEN	0	-
4382	2	52	11	OK/OPEN	0	-
4390	2	45	11	OK/OPEN	0	-
4407	2	51	11	OK/OPEN	0	-
4452	1	340	11	PREG	194	7AN414
4547	1	274	11	PREG	168	7AN380
4596	1	246	11	PREG	112	7AN449
4648	1	219	11	PREG	142	7AN363
4665	1	209	11	PREG	93	7AN449
4666	1	209	11	PREG	112	7AN449
4675	1	215	11	PREG	121	7AN442
4684	1	201	11	PREG	105	7AN432
4691	1	190	11	PREG	108	7AN432
4692	1	190	11	PREG	92	7AN449
4719	1	176	11	PREG	112	7AN449
4722	1	176	11	PREG	109	7AN432
4745	1	168	11	PREG	63	7AN444
4746	1	168	11	PREG	77	7AN444
4747	1	168	11	PREG	102	14AN387
4748	1	168	11	PREG	79	7AN435
4760	1	194	11	PREG	103	7AN432
4773	1	172	11	PREG	78	7AN444
4775	1	172	11	PREG	77	7AN444

(31 HEAD)

TRACT 21

ID	LACT	DIM	PEN	RPRO	DCC	SIRC
4778	1	172	11	PREG	53	7AN471
4840	1	80	11	OK/OPEN	0	-
9103	4	89	11	OK/OPEN	0	-
9107	4	137	11	PREG	42	7AN464
9330	4	44	11	OK/OPEN	0	-
9355	4	28	11	OK/OPEN	0	-
9460	3	88	11	OK/OPEN	0	-
9616	3	35	11	OK/OPEN	0	-
9619	3	122	11	BRED	0	-
9623	3	62	11	OK/OPEN	0	-
9638	3	62	11	OK/OPEN	0	-
9648	3	87	11	OK/OPEN	0	-
9663	3	52	11	OK/OPEN	0	-
9666	3	45	11	OK/OPEN	0	-
9668	3	34	11	OK/OPEN	0	-
9701	3	52	11	OK/OPEN	0	-
9702	3	102	11	PREG	38	7AN471
9707	3	121	11	PREG	40	7AN471
9733	3	122	11	BRED	0	-
9741	3	102	11	PREG	40	7AN471
9781	2	279	11	PREG	175	7AN414
9782	3	28	11	OK/OPEN	0	-
9806	3	56	11	OK/OPEN	0	-
9815	3	56	11	OK/OPEN	0	-
9913	2	283	11	PREG	133	14AN378
9918	2	230	11	PREG	133	14AN378
9931	3	28	11	OK/OPEN	0	-
9969	2	102	11	BRED	0	-
9984	2	260	11	PREG	154	7AN371
9985	2	261	11	PREG	193	7AN434
9996	2	259	11	PREG	192	7AN407

**(26 HEAD)**

# TRACT 22

ID	LACT	DIM	PEN	RPRO	DCC	SIRC
16	4	264	11	PREG	96	7AN371
2645	4	45	11	OK/OPEN	0	-
2648	3	296	11	PREG	149	7AN363
3315	5	234	11	PREG	151	7AN380
3382	5	30	11	OK/OPEN	0	-
4119	2	176	11	BRED	0	-
4663	1	209	11	PREG	112	7AN449
4682	1	201	11	PREG	105	7AN432
4687	1	201	11	PREG	69	7AN435
4688	1	190	11	PREG	93	7AN449
4720	1	176	11	PREG	56	7AN464
4721	1	176	11	PREG	35	7AN471
4743	1	168	11	BRED	0	-
4769	1	195	11	PREG	81	7AN435
4779	1	172	11	PREG	35	7AN471
8154	5	210	11	PREG	118	14AN387
8352	5	260	11	PREG	165	7AN380
8409	5	27	11	OK/OPEN	0	-
8451	5	123	11	BRED	0	-
8466	4	259	11	PREG	112	7AN449
8493	5	55	11	OK/OPEN	0	-
8513	5	55	11	OK/OPEN	0	-
8549	4	296	11	PREG	182	7AN399
8561	4	121	11	BRED	0	-
8638	4	382	11	PREG	126	7AN341
8681	4	283	11	PREG	147	7AN341

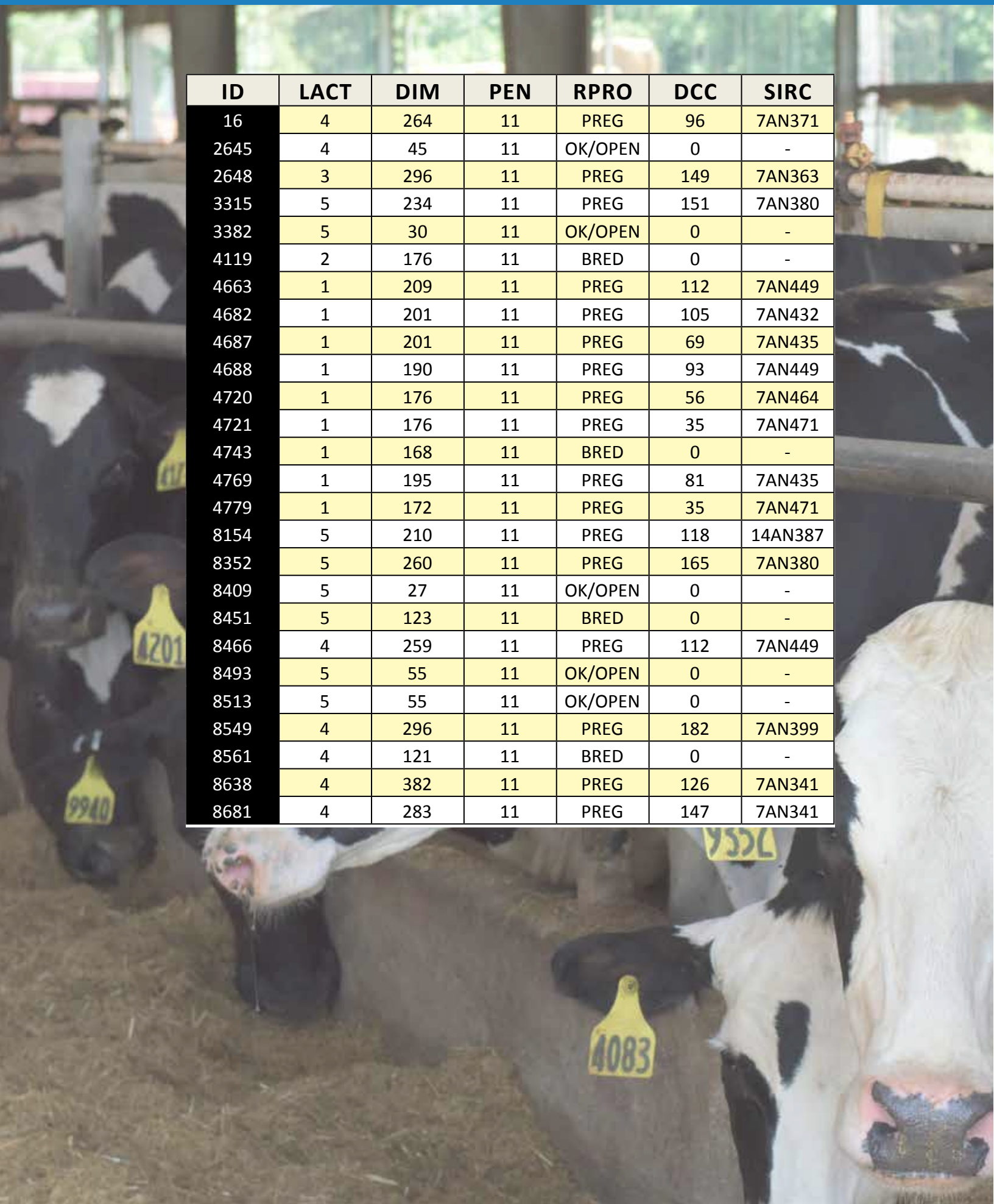

(25 HEAD)

TRACT 23

ID	LACT	DIM	PEN	RPRO	DCC	SIRC
8099	5	324	12	DRY	257	7AN345
8655	4	375	12	DRY	265	7AN345
8662	4	349	12	DRY	261	7AN345
8664	4	341	12	DRY	258	7AN345
8693	4	223	11	PREG	105	7AN449
8724	4	27	11	OK/OPEN	0	-
8795	3	394	12	DRY	265	7AN345
8851	4	102	11	BRED	0	-
8896	4	137	11	BRED	0	-
8986	4	218	11	PREG	88	7AN435
9065	3	332	12	DRY	263	7AN345
9080	3	426	12	DRY	262	7AN345
9166	3	300	11	PREG	77	7AN444
9218	3	231	11	PREG	49	7AN471
9278	4	34	11	OK/OPEN	0	-
9297	3	137	11	PREG	42	7AN464
9434	3	319	11	PREG	175	7AN414
9440	3	228	11	PREG	166	7AN380
9474	3	231	11	PREG	152	7AN371
9597	3	172	11	PREG	69	7AN435
9624	3	187	11	PREG	113	7AN432
9680	3	51	11	OK/OPEN	0	-
9687	3	61	11	OK/OPEN	0	-
9758	2	283	11	PREG	89	7AN435
9997	2	137	11	PREG	42	7AN464

(28 HEAD)

# TRACT 24

ID	LACT	DIM	PEN	RPRO	DCC	SIRC
4408	1	361	11	PREG	143	7AN363
4630	1	247	11	PREG	49	7AN471
4661	1	209	11	PREG	42	7AN464
4662	1	209	11	PREG	89	7AN435
4731	2	188	11	PREG	40	7AN471
4776	1	172	11	BRED	0	-
6138	9	284	11	PREG	165	7AN380
7260	8	37	11	OK/OPEN	0	-
7463	7	60	11	OK/OPEN	0	-
7540	6	340	11	PREG	157	7AN380
7762	6	281	11	PREG	147	7AN341
7791	5	343	11	PREG	180	7AN414
7859	6	88	11	BRED	0	-
7903	6	55	11	OK/OPEN	0	-
7918	6	60	11	OK/OPEN	0	-
7936	6	45	11	OK/OPEN	0	-
7997	5	284	11	PREG	167	7AN380
8288	5	219	11	PREG	104	7AN432
8338	5	231	11	PREG	35	7AN471
8473	5	62	11	OK/OPEN	0	-
8509	4	360	11	PREG	147	7AN341
8585	4	333	11	PREG	170	7AN380
9173	4	51	11	OK/OPEN	0	-
9466	3	210	11	PREG	35	7AN471
9546	3	198	11	BRED	0	-
9550	3	223	11	PREG	158	7AN380
9592	3	37	11	OK/OPEN	0	-
9682	3	58	11	OK/OPEN	0	-

**(53 HEAD)**

**TRACT 25**

ID	LACT	DIM	PEN	RPRO	DCC	SIRC
899	1	196	9	BRED	0	-
2683	4	13	6	OK/OPEN	0	-
3481	5	53	10	OK/OPEN	0	-
4041	2	229	6	PREG	145	7AN363
4089	2	232	11	PREG	157	7AN380
4325	1	412	9	PREG	160	7AN380
4344	1	419	9	PREG	182	7AN399
4352	2	62	10	OK/OPEN	0	-
4394	2	18	6	OK/OPEN	0	-
4425	1	360	10	PREG	98	7AN432
4431	1	356	10	PREG	112	7AN449
4528	1	291	9	BRED	0	-
4529	1	294	10	PREG	73	7AN435
4579	1	262	9	BRED	0	-
4595	1	246	10	PREG	35	7AN471
4606	1	273	9	BRED	0	-
4623	1	226	10	PREG	43	7AN464
4625	1	226	10	PREG	49	7AN471
4629	1	247	9	BRED	0	-
4643	1	244	10	PREG	138	7AN363
4644	1	248	10	BRED	0	-
4645	1	242	9	BRED	0	-
4677	1	201	9	BRED	0	-
4678	1	201	11	BRED	0	-
4679	1	201	11	PREG	105	7AN432
4680	1	201	9	BRED	0	-
4683	1	201	9	BRED	0	-
4686	1	201	9	BRED	0	-
4690	1	190	9	BRED	0	-
4693	1	190	9	BRED	0	-
4698	1	215	11	BRED	0	-
4702	1	212	10	PREG	112	7AN449



**(53 HEAD)**

**TRACT 25 cont.**

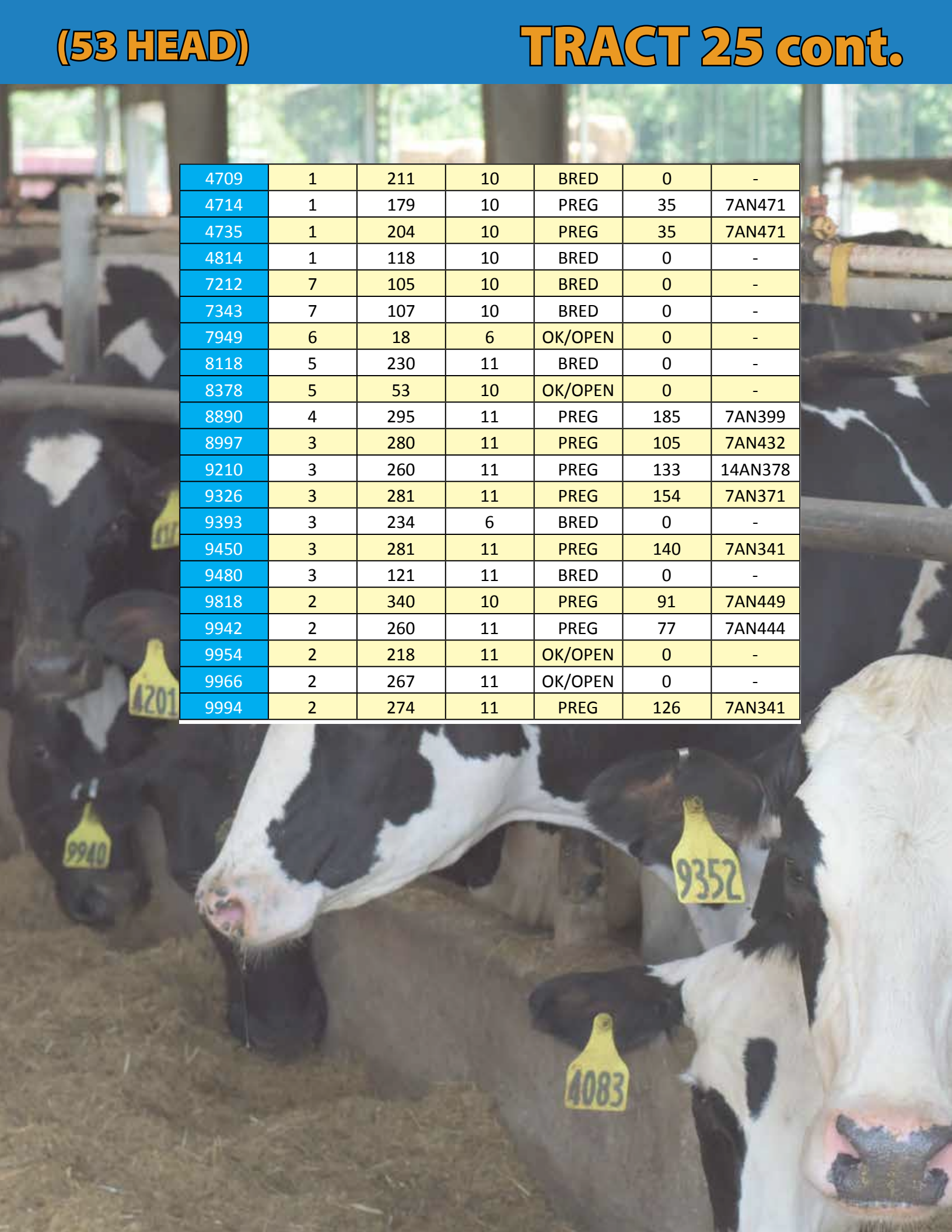

4709	1	211	10	BRED	0	-
4714	1	179	10	PREG	35	7AN471
4735	1	204	10	PREG	35	7AN471
4814	1	118	10	BRED	0	-
7212	7	105	10	BRED	0	-
7343	7	107	10	BRED	0	-
7949	6	18	6	OK/OPEN	0	-
8118	5	230	11	BRED	0	-
8378	5	53	10	OK/OPEN	0	-
8890	4	295	11	PREG	185	7AN399
8997	3	280	11	PREG	105	7AN432
9210	3	260	11	PREG	133	14AN378
9326	3	281	11	PREG	154	7AN371
9393	3	234	6	BRED	0	-
9450	3	281	11	PREG	140	7AN341
9480	3	121	11	BRED	0	-
9818	2	340	10	PREG	91	7AN449
9942	2	260	11	PREG	77	7AN444
9954	2	218	11	OK/OPEN	0	-
9966	2	267	11	OK/OPEN	0	-
9994	2	274	11	PREG	126	7AN341

**(35 HEAD)**

**TRACT 26**

ID	LACT	DIM	PEN	RPRO	DCC	SIRC
4008	2	276	1	PREG	116	7AN432
4011	2	135	1	PREG	53	7AN471
4035	2	72	1	OK/OPEN	0	-
4039	2	166	1	BRED	0	-
4058	2	189	1	PREG	109	7AN432
4078	2	166	1	PREG	80	7AN435
4092	2	257	1	PREG	84	7AN435
4100	2	208	1	PREG	112	7AN432
4121	2	186	1	BRED	0	-
4133	2	137	1	BRED	0	-
4152	2	164	1	PREG	97	7AN432
4158	2	135	1	BRED	0	-
4161	2	108	1	BRED	0	-
4167	2	95	1	BRED	0	-
4168	2	165	1	PREG	56	7AN471
4170	2	169	1	PREG	70	7AN435
4180	2	114	1	BRED	0	-
4193	2	94	1	OK/OPEN	0	-
4220	2	135	1	BRED	0	-
4256	2	49	1	OK/OPEN	0	-
4271	2	74	1	OK/OPEN	0	-
4321	2	76	1	OK/OPEN	0	-
4356	2	77	1	OK/OPEN	0	-
8383	5	284	1	PREG	63	7AN449
8873	4	214	1	PREG	120	7AN442
9052	4	73	1	OK/OPEN	0	-
9072	4	94	1	BRED	0	-
9082	4	114	1	PREG	43	7AN464
9268	3	258	1	PREG	180	7AN414
9270	4	76	1	OK/OPEN	0	-
9391	3	207	1	PREG	115	7AN442
9503	3	207	1	PREG	112	7AN432
9504	3	114	1	BRED	0	-
9515	3	168	1	PREG	46	7AN471
9568	3	134	1	BRED	0	-

**(36 HEAD)**

**TRACT 27**

ID	LACT	DIM	PEN	RPRO	DCC	SIRC
4013	2	252	1	PREG	187	7AN399
4014	2	184	1	PREG	117	7AN432
4015	2	260	1	PREG	180	7AN414
4059	2	209	1	PREG	113	7AN432
4062	2	275	1	PREG	175	7AN380
4101	2	190	1	PREG	56	7AN471
4171	2	133	1	PREG	68	7AN435
4176	2	208	1	PREG	145	7AN363
4194	2	95	1	BRED	0	-
4204	2	112	1	BRED	0	-
4209	2	108	1	BRED	0	-
4227	2	47	1	OK/OPEN	0	-
4262	2	57	1	OK/OPEN	0	-
4277	2	77	1	OK/OPEN	0	-
4290	2	48	1	OK/OPEN	0	-
4369	2	42	1	OK/OPEN	0	-
9548	3	206	1	PREG	84	7AN435
9602	3	74	1	OK/OPEN	0	-
9609	3	110	1	BRED	0	-
9626	3	95	1	BRED	0	-
9629	3	96	1	BRED	0	-
9647	3	139	1	PREG	35	7AN464
9672	3	85	1	OK/OPEN	0	-
9697	3	91	1	OK/OPEN	0	-
9711	3	95	1	BRED	0	-
9712	3	96	1	BRED	0	-
9727	3	57	1	OK/OPEN	0	-
9729	3	112	1	BRED	0	-
9767	3	112	1	BRED	0	-
9838	2	217	1	BRED	0	-
9843	2	215	1	BRED	0	-
9940	2	208	1	PREG	71	7AN435
9952	2	185	1	PREG	78	7AN444
9971	2	256	1	PREG	86	7AN435
9972	2	276	1	PREG	185	7AN399
9989	2	217	1	BRED	0	-

**(36 HEAD)****TRACT 28**

ID	LACT	DIM	PEN	RPRO	DCC	SIRC
4007	2	257	1	PREG	140	7AN341
4050	2	210	1	PREG	116	7AN432
4077	2	206	1	PREG	151	7AN380
4083	2	233	1	BRED	0	-
4113	2	133	1	PREG	67	7AN435
4118	2	216	1	BRED	0	-
4179	2	169	1	PREG	44	7AN471
4201	2	135	1	PREG	74	7AN435
4219	2	76	1	OK/OPEN	0	-
4273	2	93	1	OK/OPEN	0	-
4280	2	111	1	BRED	0	-
4289	2	49	1	OK/OPEN	0	-
4294	2	58	1	OK/OPEN	0	-
4299	2	75	1	OK/OPEN	0	-
4346	2	74	1	BRED	0	-
4819	1	146	1	BRED	0	-
6578	8	206	1	PREG	95	7AN449
7557	6	209	1	PREG	74	7AN435
8130	6	77	1	OK/OPEN	0	-
8589	5	72	1	OK/OPEN	0	-
8644	4	275	1	PREG	185	7AN399
8763	4	259	1	PREG	181	7AN414
8826	4	209	1	PREG	42	7AN464
8848	4	74	1	OK/OPEN	0	-
8976	4	109	1	BRED	0	-
9063	4	57	1	OK/OPEN	0	-
9255	3	350	1	PREG	126	7AN442
9267	3	253	1	PREG	154	7AN371
9513	3	215	1	PREG	136	7AN363
9519	3	185	1	BRED	0	-
9824	2	258	1	PREG	154	7AN371
9877	2	292	1	PREG	105	7AN449
9878	2	311	1	PREG	133	7AN442
9946	2	291	1	PREG	147	7AN363
9968	2	185	1	PREG	70	7AN435
9978	2	208	1	PREG	112	7AN432

**(36 HEAD)**

**TRACT 29**

ID	LACT	DIM	PEN	RPRO	DCC	SIRC
4029	2	254	1	PREG	127	7AN341
4053	2	140	1	BRED	0	-
4261	2	57	1	OK/OPEN	0	-
4348	2	49	1	OK/OPEN	0	-
7823	6	184	1	PREG	116	7AN432
8364	5	164	1	PREG	63	7AN449
8496	5	49	1	OK/OPEN	0	-
8503	5	137	1	PREG	35	7AN464
8581	4	260	1	BRED	0	-
8617	5	168	1	PREG	88	7AN435
8667	4	204	1	PREG	70	7AN435
8690	4	166	1	BRED	0	-
8775	4	217	1	PREG	113	7AN432
8845	4	186	1	BRED	0	-
8942	3	379	1	PREG	108	7AN432
8961	4	49	1	OK/OPEN	0	-
9114	4	108	1	BRED	0	-
9202	4	73	1	OK/OPEN	0	-
9204	4	73	1	BRED	0	-
9224	3	252	1	PREG	184	7AN399
9284	3	336	1	PREG	154	7AN371
9294	3	347	1	PREG	140	7AN341
9351	3	252	1	PREG	187	7AN399
9352	3	216	1	BRED	0	-
9443	3	252	1	PREG	187	7AN399
9475	3	186	1	PREG	127	7AN341
9527	3	182	1	PREG	49	7AN435
9540	3	258	1	PREG	136	7AN363
9549	3	167	1	BRED	0	-
9553	3	206	1	PREG	132	7AN363
9649	3	51	1	OK/OPEN	0	-
9674	3	94	1	BRED	0	-
9698	3	71	1	BRED	0	-
9722	3	134	1	PREG	35	7AN464
9832	2	377	1	PREG	158	7AN380
9840	2	292	1	PREG	154	7AN371

**(32 HEAD)**

**TRACT 30**

ID	LACT	DIM	PEN	RPRO	DCC	SIRC
4033	2	200	3	PREG	70	7AN435
4043	2	237	3	PREG	159	7AN371
4071	2	224	3	PREG	159	7AN371
4165	2	78	3	OK/OPEN	0	-
4186	2	182	3	PREG	117	7AN432
4195	2	147	3	BRED	0	-
4206	2	157	3	BRED	0	-
4208	2	249	3	PREG	187	7AN399
4216	2	129	3	BRED	0	-
4238	2	97	3	BRED	0	-
4240	2	78	3	OK/OPEN	0	-
4253	2	97	3	BRED	0	-
4276	2	50	3	OK/OPEN	0	-
4303	2	98	3	BRED	0	-
4306	2	69	3	OK/OPEN	0	-
4342	2	50	3	OK/OPEN	0	-
9130	4	69	3	OK/OPEN	0	-
9458	3	170	3	PREG	75	7AN444
9588	3	157	3	BRED	0	-
9603	3	155	3	BRED	0	-
9655	3	140	3	PREG	42	7AN464
9665	3	126	3	BRED	0	-
9691	3	127	3	BRED	0	-
9753	3	37	3	OK/OPEN	0	-
9774	3	49	3	OK/OPEN	0	-
9779	3	37	3	OK/OPEN	0	-
9780	3	40	3	OK/OPEN	0	-
9792	3	69	3	OK/OPEN	0	-
9976	2	234	3	PREG	133	7AN442
9977	2	231	3	PREG	91	14AN387
9980	2	249	3	PREG	119	14AN387
9990	2	251	3	PREG	154	7AN371

**(34 HEAD)**

**TRACT 31**

ID	LACT	DIM	PEN	RPRO	DCC	SIRC
2657	4	130	3	BRED	0	-
4028	2	200	3	PREG	124	14AN387
4127	2	171	3	PREG	103	7AN432
4151	2	164	3	BRED	0	-
4155	2	69	3	OK/OPEN	0	-
4173	2	103	3	BRED	0	-
4182	2	202	3	PREG	112	7AN432
4223	2	98	3	BRED	0	-
4224	2	126	3	BRED	0	-
4228	2	103	3	BRED	0	-
4245	2	78	3	OK/OPEN	0	-
4298	3	50	3	OK/OPEN	0	-
4326	2	73	3	OK/OPEN	0	-
4329	2	58	3	OK/OPEN	0	-
4374	2	38	3	OK/OPEN	0	-
4384	2	67	3	OK/OPEN	0	-
9420	3	157	3	OK/OPEN	0	-
9426	3	248	3	PREG	140	7AN341
9517	3	222	3	PREG	135	7AN363
9518	3	247	3	PREG	165	7AN380
9595	3	101	3	BRED	0	-
9601	3	176	3	BRED	0	-
9605	3	69	3	OK/OPEN	0	-
9631	3	164	3	BRED	0	-
9742	3	40	3	OK/OPEN	0	-
9826	3	58	3	OK/OPEN	0	-
9837	3	38	3	OK/OPEN	0	-
9848	3	40	3	OK/OPEN	0	-
9849	3	50	3	OK/OPEN	0	-
9911	2	238	3	PREG	173	7AN380
9914	2	308	3	PREG	133	7AN442
9928	3	40	3	OK/OPEN	0	-
9949	2	304	3	PREG	196	7AN399
9974	2	227	3	PREG	158	7AN380

**(30 HEAD)**

**TRACT 32**

ID	LACT	DIM	PEN	RPRO	DCC	SIRC
2639	4	130	3	PREG	67	7AN435
3367	5	228	3	PREG	77	7AN435
3432	5	157	3	BRED	0	-
4004	2	227	3	BRED	0	-
4016	2	228	3	PREG	77	7AN435
4024	2	174	3	PREG	110	7AN449
4044	2	227	3	BRED	0	-
4049	2	228	3	PREG	166	7AN380
4082	2	226	3	PREG	159	7AN371
4086	2	228	3	PREG	126	7AN442
4111	2	200	3	PREG	138	7AN363
4136	2	158	3	PREG	80	7AN435
4148	2	176	3	PREG	77	7AN435
4225	2	99	3	BRED	0	-
4226	2	129	4	PREG	47	7AN449
4247	2	99	3	BRED	0	-
6952	7	308	3	PREG	143	7AN363
7803	5	174	3	OK/OPEN	0	-
7999	6	58	3	OK/OPEN	0	-
8080	6	101	3	BRED	0	-
8177	5	99	3	BRED	0	-
8432	4	232	3	PREG	70	7AN435
8591	4	265	3	PREG	187	7AN399
8602	4	222	3	BRED	0	-
8632	4	278	3	PREG	181	7AN414
8663	5	99	3	BRED	0	-
8761	4	251	3	PREG	187	7AN399
8778	4	129	3	BRED	0	-
8809	4	298	3	PREG	152	7AN371
8834	4	205	3	PREG	105	7AN449



(31 HEAD)

TRACT 33

ID	LACT	DIM	PEN	RPRO	DCC	SIRC
8856	4	226	3	PREG	158	7AN380
8861	4	170	3	PREG	49	7AN435
8981	4	99	3	BRED	0	-
8991	4	69	3	OK/OPEN	0	-
8996	4	223	3	PREG	119	14AN387
9009	4	67	3	OK/OPEN	0	-
9018	4	101	3	BRED	0	-
9112	3	278	3	PREG	140	7AN341
9148	3	362	3	PREG	196	7AN399
9151	4	49	3	OK/OPEN	0	-
9250	3	301	3	PREG	107	7AN432
9301	3	370	3	PREG	182	7AN414
9349	3	222	3	PREG	144	7AN363
9397	3	240	3	PREG	150	7AN380
9417	3	222	3	PREG	126	7AN442
9429	3	278	3	PREG	119	14AN387
9447	3	257	3	PREG	161	7AN380
9523	3	174	3	PREG	117	7AN432
9534	3	179	3	BRED	0	-
9551	3	250	3	PREG	151	7AN380
9560	3	50	3	OK/OPEN	0	-
9566	3	154	3	BRED	0	-
9593	3	169	3	PREG	70	7AN435
9604	3	154	3	PREG	42	7AN464
9606	3	130	3	BRED	0	-
9625	3	37	3	OK/OPEN	0	-
9831	3	37	3	OK/OPEN	0	-
9836	3	37	3	OK/OPEN	0	-
9856	2	301	3	PREG	140	7AN341
9973	2	294	3	PREG	98	7AN449
9998	2	251	3	PREG	186	7AN399

**(35 HEAD)****TRACT 34**

ID	LACT	DIM	PEN	RPRO	DCC	SIRC
4042	2	148	4	BRED	0	-
4052	2	215	4	PREG	63	7AN449
4072	2	192	4	PREG	134	7AN363
4116	2	191	4	PREG	124	14AN387
4154	2	161	4	BRED	0	-
4175	2	141	4	BRED	0	-
4196	2	44	4	OK/OPEN	0	-
4222	2	43	4	OK/OPEN	0	-
4296	2	81	4	BRED	0	-
4304	2	70	4	OK/OPEN	0	-
4319	2	27	4	OK/OPEN	0	-
4392	2	82	4	OK/OPEN	0	-
8345	5	97	3	BRED	0	-
8467	5	274	3	PREG	161	7AN380
8543	4	249	3	PREG	184	7AN399
8599	4	302	3	PREG	197	7AN434
8628	4	249	3	PREG	154	7AN371
8666	4	302	3	PREG	195	7AN414
8757	4	176	3	BRED	0	-
8771	4	247	3	PREG	180	7AN414
8780	4	238	4	PREG	112	7AN432
8916	4	182	3	PREG	87	7AN435
9015	4	69	3	OK/OPEN	0	-
9025	4	49	3	OK/OPEN	0	-
9087	3	226	3	PREG	119	14AN387
9089	4	40	3	OK/OPEN	0	-
9129	4	65	3	OK/OPEN	0	-
9197	3	277	3	PREG	113	7AN432
9356	3	308	3	PREG	154	7AN371
9855	2	328	4	PREG	80	7AN435
9933	3	43	4	OK/OPEN	0	-
9941	2	270	4	PREG	166	7AN380
9950	2	270	4	PREG	133	7AN442
9970	2	289	4	PREG	166	7AN380
9993	2	273	4	PREG	175	7AN380

**(36 HEAD)**

**TRACT 35**

ID	LACT	DIM	PEN	RPRO	DCC	SIRC
4012	2	243	4	PREG	179	7AN414
4037	2	193	4	PREG	129	7AN341
4040	2	193	4	PREG	111	7AN432
4046	2	160	4	PREG	59	7AN471
4047	2	154	4	OK/OPEN	0	-
4048	2	241	4	PREG	150	7AN380
4055	2	141	4	PREG	74	7AN435
4068	2	242	4	PREG	132	7AN363
4069	2	42	4	OK/OPEN	0	-
4080	2	185	4	BRED	0	-
4088	2	86	4	OK/OPEN	0	-
4106	2	194	4	PREG	129	7AN341
4109	2	163	4	PREG	95	7AN449
4125	2	191	4	PREG	123	7AN371
4138	2	146	4	PREG	35	7AN464
4143	2	191	4	BRED	0	-
4149	2	163	4	BRED	0	-
4150	2	145	4	BRED	0	-
4188	2	144	4	PREG	82	7AN444
4211	2	145	4	NO BRED	0	-
4218	2	90	4	BRED	0	-
4235	2	35	4	OK/OPEN	0	-
4237	2	28	4	OK/OPEN	0	-
4241	2	90	4	OK/OPEN	0	-
4250	2	71	4	OK/OPEN	0	-
4275	2	71	4	OK/OPEN	0	-
4301	2	28	4	OK/OPEN	0	-
4308	2	70	4	OK/OPEN	0	-
4314	2	71	4	OK/OPEN	0	-
4323	2	70	4	OK/OPEN	0	-
4330	2	81	4	OK/OPEN	0	-
4331	2	26	4	OK/OPEN	0	-
4350	2	42	4	OK/OPEN	0	-
8967	4	159	4	PREG	53	7AN471
9203	4	79	4	OK/OPEN	0	-
9303	3	243	4	PREG	178	7AN414

**(36 HEAD)****TRACT 36**

ID	LACT	DIM	PEN	RPRO	DCC	SIRC
3377	5	149	4	PREG	82	7AN444
3422	5	317	4	PREG	136	7AN363
8255	5	158	4	BRED	0	-
8419	4	272	4	BRED	0	-
8522	4	366	4	PREG	119	14AN387
8776	4	273	4	PREG	175	7AN380
8784	4	313	4	PREG	154	7AN371
8816	4	246	4	PREG	179	7AN414
8887	4	242	4	PREG	77	7AN435
8928	4	147	4	PREG	81	7AN435
9104	4	70	4	OK/OPEN	0	-
9153	4	83	4	OK/OPEN	0	-
9181	4	44	4	OK/OPEN	0	-
9348	3	83	4	OK/OPEN	0	-
9383	3	147	4	OK/OPEN	0	-
9421	3	287	4	PREG	162	7AN380
9444	3	192	4	BRED	0	-
9477	3	211	4	PREG	47	7AN449
9529	3	86	4	OK/OPEN	0	-
9537	3	193	4	PREG	77	7AN435
9542	3	243	4	BRED	0	-
9556	3	161	4	PREG	63	7AN449
9559	3	190	4	PREG	88	7AN435
9561	3	83	4	BRED	0	-
9581	3	160	4	OK/OPEN	0	-
9591	3	203	4	PREG	70	7AN435
9744	3	151	4	BRED	0	-
9749	3	42	4	OK/OPEN	0	-
9751	2	269	4	PREG	126	7AN442
9764	3	89	4	OK/OPEN	0	-
9777	2	317	4	PREG	175	7AN380
9790	3	82	4	BRED	0	-
9796	3	84	4	OK/OPEN	0	-
9829	2	316	4	PREG	161	7AN380
9847	2	212	4	PREG	76	7AN435
9945	2	288	4	PREG	78	7AN444

**(36 HEAD)**

**TRACT 37**

ID	LACT	DIM	PEN	RPRO	DCC	SIRC
7257	6	393	4	PREG	147	7AN363
7634	6	339	4	PREG	119	14AN387
7971	5	241	4	PREG	140	7AN341
8005	6	161	4	BRED	0	-
8169	5	247	4	PREG	91	7AN449
8197	5	83	4	BRED	0	-
8221	4	286	4	BRED	0	-
8230	5	241	4	PREG	110	7AN449
8584	5	43	4	OK/OPEN	0	-
8630	4	239	4	PREG	112	7AN432
8654	5	41	4	OK/OPEN	0	-
8672	4	172	4	PREG	96	7AN442
8695	5	26	4	OK/OPEN	0	-
8785	4	180	4	PREG	80	7AN435
8818	4	213	4	PREG	155	7AN380
8822	4	148	4	PREG	68	7AN435
8857	4	153	4	BRED	0	-
8862	4	192	4	BRED	0	-
8925	4	213	4	PREG	105	7AN449
8936	4	149	4	BRED	0	-
8947	4	213	4	PREG	105	7AN449
9023	4	85	4	OK/OPEN	0	-
9088	4	145	4	PREG	83	7AN435
9170	4	43	4	OK/OPEN	0	-
9256	3	153	4	BRED	0	-
9277	3	309	4	PREG	184	7AN399
9298	3	172	4	BRED	0	-
9371	3	244	4	PREG	102	14AN387
9462	3	85	4	OK/OPEN	0	-
9469	3	211	4	PREG	112	7AN432
9478	3	191	4	PREG	135	7AN363
9485	3	151	4	BRED	0	-
9538	3	89	4	OK/OPEN	0	-
9657	3	187	4	PREG	123	7AN371
9678	3	70	4	OK/OPEN	0	-
9709	3	82	4	BRED	0	-

**(24 HEAD)**

# TRACT 38

ID	LACT	DIM	PEN	RPRO	DCC	SIRC
4021	2	259	2	PREG	194	7AN414
4025	2	257	2	PREG	194	7AN414
4252	1	437	2	PREG	182	7AN399
4270	1	453	2	PREG	196	7AN399
4389	1	386	2	PREG	168	7AN380
4409	1	384	2	PREG	198	7AN446
4448	2	352	2	PREG	202	7AN434
4461	1	337	2	PREG	189	7AN399
4479	1	322	2	PREG	189	7AN399
4545	1	274	2	PREG	206	7AN408
8479	4	296	2	PREG	196	7AN399
8554	4	295	2	PREG	189	7AN399
8679	4	302	2	PREG	168	7AN380
8973	3	362	2	PREG	180	7AN414
9057	3	318	2	PREG	182	7AN399
9333	3	354	2	PREG	154	7AN371
9497	3	140	1	BRED	0	-
9738	2	352	2	PREG	217	7AN363
9801	2	341	2	PREG	195	7AN414
9841	2	305	2	PREG	117	7AN432
9862	2	297	2	PREG	216	7AN363
9863	2	346	2	PREG	209	7AN408
9900	2	346	2	PREG	209	7AN408
9921	2	305	2	PREG	112	7AN449

**(24 HEAD)**

**TRACT 39**



ID	LACT	DIM	PEN	RPRO	DCC	SIRC
2686	3	270	2	PREG	194	7AN414
2688	3	369	2	PREG	237	7AN363
4031	2	270	2	PREG	208	7AN408
7648	6	347	2	PREG	77	7AN435
7799	6	278	2	PREG	214	7AN434
8274	4	324	2	PREG	206	7AN408
8671	4	338	2	PREG	119	14AN387
9011	3	313	2	PREG	187	7AN399
9026	3	347	2	PREG	217	7AN363
9070	3	364	2	PREG	143	7AN363
9221	3	304	2	PREG	57	7AN464
9361	3	283	2	PREG	201	7AN446
9416	3	296	2	PREG	214	7AN434
9630	3	210	2	PREG	145	7AN363
9679	2	364	2	PREG	154	7AN371
9747	2	435	2	PREG	217	7AN363
9768	2	361	2	PREG	179	7AN414
9798	2	385	2	PREG	140	7AN341
9811	2	333	2	PREG	206	7AN408
9874	2	294	2	PREG	208	7AN408
9902	2	309	2	PREG	209	7AN408
9904	2	296	2	PREG	215	7AN408
9923	2	293	2	PREG	215	7AN408
9924	2	317	2	PREG	193	7AN434

**(32 HEAD)**

**TRACT 40**

ID	LACT	DIM	PEN	RPRO	DCC	SIRC
4467	1	308	2	PREG	207	7AN363
7358	6	292	2	PREG	49	7AN435
7765	5	355	2	PREG	157	7AN380
7773	5	312	2	PREG	105	7AN432
8012	5	342	2	PREG	209	7AN408
8108	5	371	2	PREG	212	7AN434
8109	5	347	2	PREG	186	7AN399
8279	5	285	2	PREG	218	7AN363
8461	4	325	2	PREG	71	7AN435
8478	4	276	2	NO BRED	0	-
8481	4	280	2	PREG	201	7AN446
8537	4	316	2	PREG	161	7AN380
8769	3	406	2	PREG	168	7AN380
8843	3	431	2	PREG	217	7AN363
8853	3	328	2	PREG	42	7AN464
9040	3	346	2	PREG	172	7AN380
9238	3	344	2	PREG	161	7AN380
9271	3	354	2	NO BRED	0	-
9310	3	370	2	PREG	147	7AN363
9323	3	348	2	NO BRED	0	-
9567	2	357	2	PREG	217	7AN363
9693	2	443	2	PREG	161	7AN380
9752	2	342	2	PREG	130	7AN363
9756	2	360	2	PREG	154	7AN371
9808	2	353	2	PREG	175	7AN380
9819	2	316	2	PREG	173	7AN380
9821	2	399	2	PREG	185	7AN399
9879	2	335	2	PREG	105	7AN449
9885	2	263	2	PREG	200	7AN408
9896	2	331	2	PREG	207	7AN407
9926	2	362	2	PREG	210	7AN408
9999	2	289	2	PREG	217	7AN363



**(30 HEAD)**

**TRACT 41**

ID	LACT	DIM	PEN	RPRO	DCC	SIRC
4358	2	42	4	OK/OPEN	0	-
6924	7	271	4	PREG	105	7AN449
7450	6	288	4	PREG	168	7AN380
7456	7	154	4	PREG	81	7AN435
7519	6	169	4	BRED	0	-
7667	6	152	4	OK/OPEN	0	-
7671	6	128	4	BRED	0	-
8182	5	144	4	BRED	0	-
8285	5	212	4	PREG	49	7AN435
8329	5	239	4	PREG	170	7AN380
8557	5	71	4	BRED	0	-
8564	4	191	4	OK/OPEN	0	-
8622	5	330	4	PREG	175	7AN380
8673	4	167	4	PREG	38	7AN471
8772	4	196	4	PREG	122	7AN341
8774	4	269	4	PREG	98	7AN449
8803	4	146	4	BRED	0	-
8932	4	158	4	BRED	0	-
9002	4	70	4	OK/OPEN	0	-
9008	4	81	4	BRED	0	-
9049	5	252	4	PREG	98	7AN449
9093	4	90	4	OK/OPEN	0	-
9461	3	266	4	PREG	98	7AN449
9481	3	270	4	PREG	147	7AN363
9483	3	134	4	BRED	0	-
9490	3	191	4	PREG	63	7AN449
9578	3	71	4	OK/OPEN	0	-
9812	2	303	4	PREG	98	7AN449
9817	3	81	4	OK/OPEN	0	-
9963	2	289	4	BRED	0	-

(28 HEAD)

TRACT 42

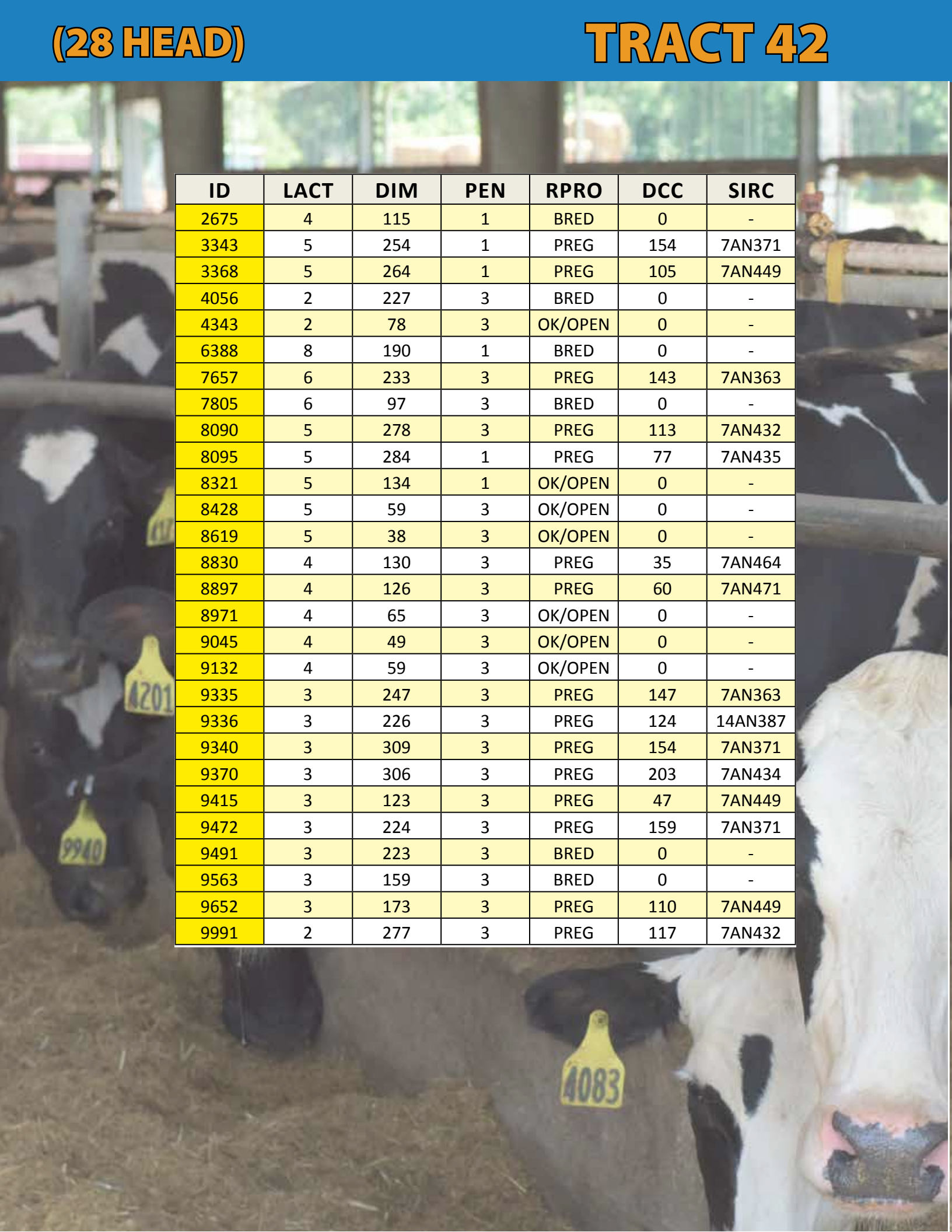

ID	LACT	DIM	PEN	RPRO	DCC	SIRC
2675	4	115	1	BRED	0	-
3343	5	254	1	PREG	154	7AN371
3368	5	264	1	PREG	105	7AN449
4056	2	227	3	BRED	0	-
4343	2	78	3	OK/OPEN	0	-
6388	8	190	1	BRED	0	-
7657	6	233	3	PREG	143	7AN363
7805	6	97	3	BRED	0	-
8090	5	278	3	PREG	113	7AN432
8095	5	284	1	PREG	77	7AN435
8321	5	134	1	OK/OPEN	0	-
8428	5	59	3	OK/OPEN	0	-
8619	5	38	3	OK/OPEN	0	-
8830	4	130	3	PREG	35	7AN464
8897	4	126	3	PREG	60	7AN471
8971	4	65	3	OK/OPEN	0	-
9045	4	49	3	OK/OPEN	0	-
9132	4	59	3	OK/OPEN	0	-
9335	3	247	3	PREG	147	7AN363
9336	3	226	3	PREG	124	14AN387
9340	3	309	3	PREG	154	7AN371
9370	3	306	3	PREG	203	7AN434
9415	3	123	3	PREG	47	7AN449
9472	3	224	3	PREG	159	7AN371
9491	3	223	3	BRED	0	-
9563	3	159	3	BRED	0	-
9652	3	173	3	PREG	110	7AN449
9991	2	277	3	PREG	117	7AN432

**(20 HEAD)**

**TRACT 43**

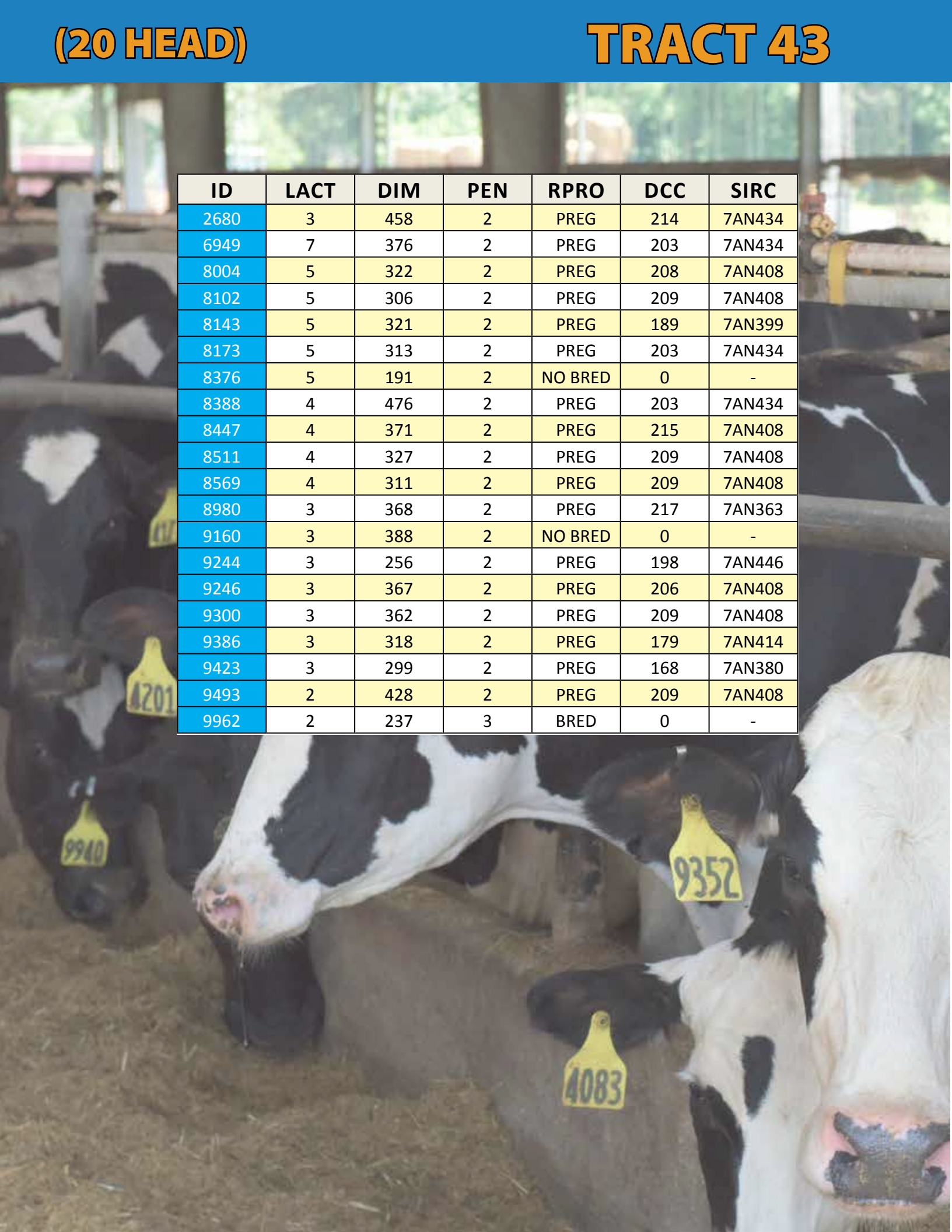

ID	LACT	DIM	PEN	RPRO	DCC	SIRC
2680	3	458	2	PREG	214	7AN434
6949	7	376	2	PREG	203	7AN434
8004	5	322	2	PREG	208	7AN408
8102	5	306	2	PREG	209	7AN408
8143	5	321	2	PREG	189	7AN399
8173	5	313	2	PREG	203	7AN434
8376	5	191	2	NO BRED	0	-
8388	4	476	2	PREG	203	7AN434
8447	4	371	2	PREG	215	7AN408
8511	4	327	2	PREG	209	7AN408
8569	4	311	2	PREG	209	7AN408
8980	3	368	2	PREG	217	7AN363
9160	3	388	2	NO BRED	0	-
9244	3	256	2	PREG	198	7AN446
9246	3	367	2	PREG	206	7AN408
9300	3	362	2	PREG	209	7AN408
9386	3	318	2	PREG	179	7AN414
9423	3	299	2	PREG	168	7AN380
9493	2	428	2	PREG	209	7AN408
9962	2	237	3	BRED	0	-

(41 HEAD)

TRACT 44

ID	LACT	DIM	PEN	RPRO	DCC	SIRC
29	7	304	1	PREG	133	7AN442
468	5	171	3	PREG	63	7AN444
2646	3	351	4	PREG	147	7AN363
4005	2	257	4	BRED	0	-
4026	2	238	3	BRED	0	-
4051	2	215	1	PREG	56	7AN471
4073	2	189	1	PREG	84	7AN435
4075	2	223	3	PREG	131	7AN363
4098	2	226	3	OK/OPEN	0	-
4112	2	198	3	PREG	112	7AN432
7546	6	332	4	PREG	105	7AN449
7892	6	57	1	OK/OPEN	0	-
8171	5	252	4	PREG	154	7AN371
8243	5	219	3	BRED	0	-
8309	5	202	3	PREG	63	7AN444
8351	5	239	4	PREG	70	7AN435
8476	5	151	4	BRED	0	-
8596	4	349	1	PREG	106	7AN432
8616	4	274	3	PREG	175	7AN380
8732	4	315	1	PREG	140	7AN341
8770	4	274	3	BRED	0	-
8939	4	202	3	PREG	136	7AN363
8958	3	290	4	BRED	0	-
9073	3	347	1	PREG	110	7AN449
9120	3	353	3	PREG	173	7AN380
9225	3	294	4	PREG	133	7AN442
9232	3	273	4	BRED	0	-
9279	3	311	1	PREG	168	7AN380
9365	3	312	1	PREG	146	7AN371
9406	3	284	1	PREG	147	7AN363
9407	3	258	1	PREG	138	7AN363
9453	3	202	3	PREG	105	7AN449
9511	3	231	3	BRED	0	-
9528	3	207	1	PREG	112	7AN432
9573	3	204	1	BRED	0	-
9714	3	114	1	BRED	0	-
9734	3	135	1	PREG	35	7AN464
9859	2	355	3	PREG	105	7AN449
9944	2	234	3	OPEN	0	-
9957	2	276	1	PREG	179	7AN414
9959	2	292	3	PREG	189	7AN399

**(33 HEAD)**

**TRACT 45**

ID	LACT	DIM	PEN	RPRO	DCC	SIRC
4198	1	480	2	PREG	204	7AN408
4258	1	419	7	DRY	243	7AN408
4300	1	400	7	DRY	245	7AN381
4327	1	399	7	DRY	241	7AN408
4340	1	338	7	DRY	253	7AN345
4341	1	353	7	DRY	252	7AN345
4347	1	384	7	DRY	253	7AN345
4353	1	420	9	PREG	217	7AN363
4354	1	415	9	PREG	213	7AN363
4363	1	410	2	PREG	209	7AN408
4366	1	381	7	DRY	246	7AN381
4367	1	377	7	DRY	245	7AN381
4370	1	394	7	DRY	231	7AN363
4378	1	364	7	DRY	224	7AN408
4379	1	364	7	DRY	238	7AN408
4391	1	380	7	DRY	231	7AN363
4393	1	348	7	DRY	242	7AN408
4403	1	321	12	DRY	259	7AN345
4404	1	349	7	DRY	232	7AN363
4410	1	356	2	PREG	217	7AN363
4413	1	373	2	PREG	221	7AN408
4415	1	393	2	PREG	209	7AN408
4423	1	356	2	PREG	216	7AN363
4426	1	358	2	PREG	214	7AN434
4465	1	335	9	PREG	209	7AN408
4492	1	287	9	PREG	199	7AN446
4493	1	314	2	PREG	198	7AN446
4505	1	316	2	PREG	211	7AN363
4511	1	297	2	PREG	215	7AN408
4517	1	322	2	PREG	222	7AN327
4519	1	325	2	PREG	216	7AN363
4544	1	274	2	PREG	207	7AN363
9839	2	334	2	PREG	224	7AN408

**(32 HEAD)**

**TRACT 46**

ID	LACT	DIM	PEN	RPRO	DCC	SIRC
4333	1	408	2	PREG	224	7AN408
4399	1	360	2	PREG	224	7AN408
4411	1	335	12	DRY	259	7AN345
4416	1	361	7	DRY	252	7AN345
4424	1	357	7	DRY	231	7AN363
4433	1	348	7	DRY	239	7AN408
4441	1	319	7	DRY	234	7AN363
4447	1	320	7	DRY	238	7AN408
4449	1	353	12	DRY	232	7AN363
4451	1	304	12	DRY	237	7AN363
4456	1	325	7	DRY	245	7AN381
4459	1	318	7	DRY	242	7AN408
4462	1	316	7	DRY	239	7AN408
4469	1	308	2	PREG	225	7AN327
4472	1	315	7	DRY	229	7AN327
4473	1	334	7	DRY	230	7AN327
4475	1	290	12	DRY	242	7AN408
4476	1	302	7	DRY	243	7AN408
4481	1	326	7	DRY	213	7AN363
4484	1	298	7	DRY	250	7AN345
4491	1	287	9	PREG	226	7AN327
4494	1	304	7	DRY	228	7AN327
4498	1	302	7	DRY	236	7AN363
4518	1	323	7	DRY	231	7AN363
4523	1	286	7	DRY	249	7AN345
4524	1	323	2	PREG	224	7AN408
4526	1	280	7	DRY	221	7AN408
4531	1	291	7	DRY	228	7AN327
4536	1	280	7	DRY	222	7AN327
4542	1	281	7	DRY	225	7AN327
9804	2	402	2	PREG	237	7AN363
9889	2	338	2	PREG	218	7AN363

**(32 HEAD)**

**TRACT 47**



ID	LACT	DIM	PEN	RPRO	DCC	SIRC
4278	1	460	2	PREG	224	7AN408
4293	1	421	9	PREG	209	7AN408
4429	1	373	2	PREG	215	7AN408
4549	1	274	9	PREG	209	7AN408
4587	1	280	9	PREG	215	7AN408
9313	3	353	7	DRY	254	7AN381
9332	3	373	7	DRY	238	7AN408
9337	3	289	12	DRY	234	7AN363
9357	3	342	7	DRY	238	7AN408
9358	3	333	12	DRY	234	7AN363
9362	3	300	7	DRY	243	7AN408
9368	3	297	12	DRY	250	7AN345
9374	3	321	7	DRY	253	7AN345
9375	3	325	7	DRY	240	7AN408
9400	3	330	7	DRY	245	7AN381
9402	3	331	7	DRY	238	7AN408
9409	3	303	7	DRY	249	7AN345
9411	3	322	2	PREG	226	7AN327
9451	3	308	2	PREG	231	7AN363
9454	3	319	2	PREG	224	7AN408
9459	3	296	2	PREG	228	7AN327
9509	2	472	2	PREG	214	7AN434
9676	2	341	7	DRY	252	7AN345
9783	2	398	12	DRY	231	7AN363
9791	2	352	2	PREG	234	7AN363
9816	2	411	5	PREG	238	7AN408
9866	2	309	2	PREG	232	7AN363
9868	2	345	7	DRY	254	7AN381
9876	2	358	2	PREG	237	7AN363
9905	2	329	2	PREG	214	7AN434
9961	2	311	2	PREG	209	7AN408
9965	2	297	2	PREG	229	7AN327

(29 HEAD)

TRACT 48

ID	LACT	DIM	PEN	RPRO	DCC	SIRC
8291	4	455	2	PREG	224	7AN408
8437	4	389	12	DRY	257	7AN345
8459	4	330	7	DRY	238	7AN408
8463	4	295	2	PREG	216	7AN363
8475	4	364	7	DRY	245	7AN381
8542	4	365	7	DRY	252	7AN345
8544	4	329	7	DRY	252	7AN345
8629	4	343	7	DRY	226	7AN327
8642	4	299	7	DRY	243	7AN408
8648	4	316	7	DRY	251	7AN345
8697	4	304	2	PREG	226	7AN327
8709	4	318	12	DRY	256	7AN345
8729	4	331	7	DRY	245	7AN381
8988	3	485	2	PREG	220	7AN363
9032	3	442	12	DRY	259	7AN345
9048	3	405	12	DRY	259	7AN345
9051	4	370	7	DRY	251	7AN345
9099	3	408	7	DRY	245	7AN381
9117	3	320	2	PREG	224	7AN408
9183	3	414	2	PREG	226	7AN327
9184	3	312	2	PREG	228	7AN327
9185	3	422	7	DRY	203	7AN434
9200	3	392	2	PREG	224	7AN408
9253	3	372	7	DRY	248	7AN381
9266	3	301	7	DRY	228	7AN327
9275	3	433	2	PREG	231	7AN363
9281	3	301	7	DRY	255	7AN345
9289	3	400	12	DRY	245	7AN381
9291	3	312	7	DRY	247	7AN381



**(32 HEAD)**

**TRACT 49**

ID	LACT	DIM	PEN	RPRO	DCC	SIRC
412	5	328	2	PREG	231	7AN363
911	5	388	7	DRY	238	7AN408
3416	4	333	7	DRY	244	7AN381
4530	1	291	2	PREG	215	7AN408
7168	7	304	7	DRY	242	7AN408
7357	6	364	2	PREG	219	7AN363
7757	5	352	7	DRY	245	7AN381
7959	5	403	2	PREG	224	7AN408
7986	5	326	2	PREG	231	7AN363
8023	5	325	2	PREG	224	7AN408
8195	5	290	2	PREG	222	7AN363
8421	4	290	4	PREG	218	7AN363
8424	4	371	7	DRY	252	7AN345
8456	4	506	7	DRY	253	7AN345
8525	4	300	7	DRY	242	7AN408
8536	4	401	2	PREG	224	7AN408
8563	4	318	2	PREG	226	7AN327
8606	4	297	2	PREG	229	7AN327
8624	4	463	2	PREG	234	7AN363
8627	4	311	2	PREG	209	7AN408
8700	4	339	2	PREG	235	7AN363
8750	4	293	2	PREG	231	7AN363
8781	4	290	2	PREG	222	7AN363
9265	3	383	2	PREG	234	7AN363
9314	3	402	2	PREG	231	7AN363
9427	3	307	2	PREG	221	7AN363
9613	2	475	2	PREG	224	7AN408
9853	2	322	2	PREG	221	7AN363
9873	2	332	2	PREG	224	7AN408
9881	2	289	2	PREG	222	7AN363
9912	2	331	2	PREG	233	7AN363
9951	2	318	2	PREG	208	7AN408

**(17 HEAD)**

**TRACT 50**

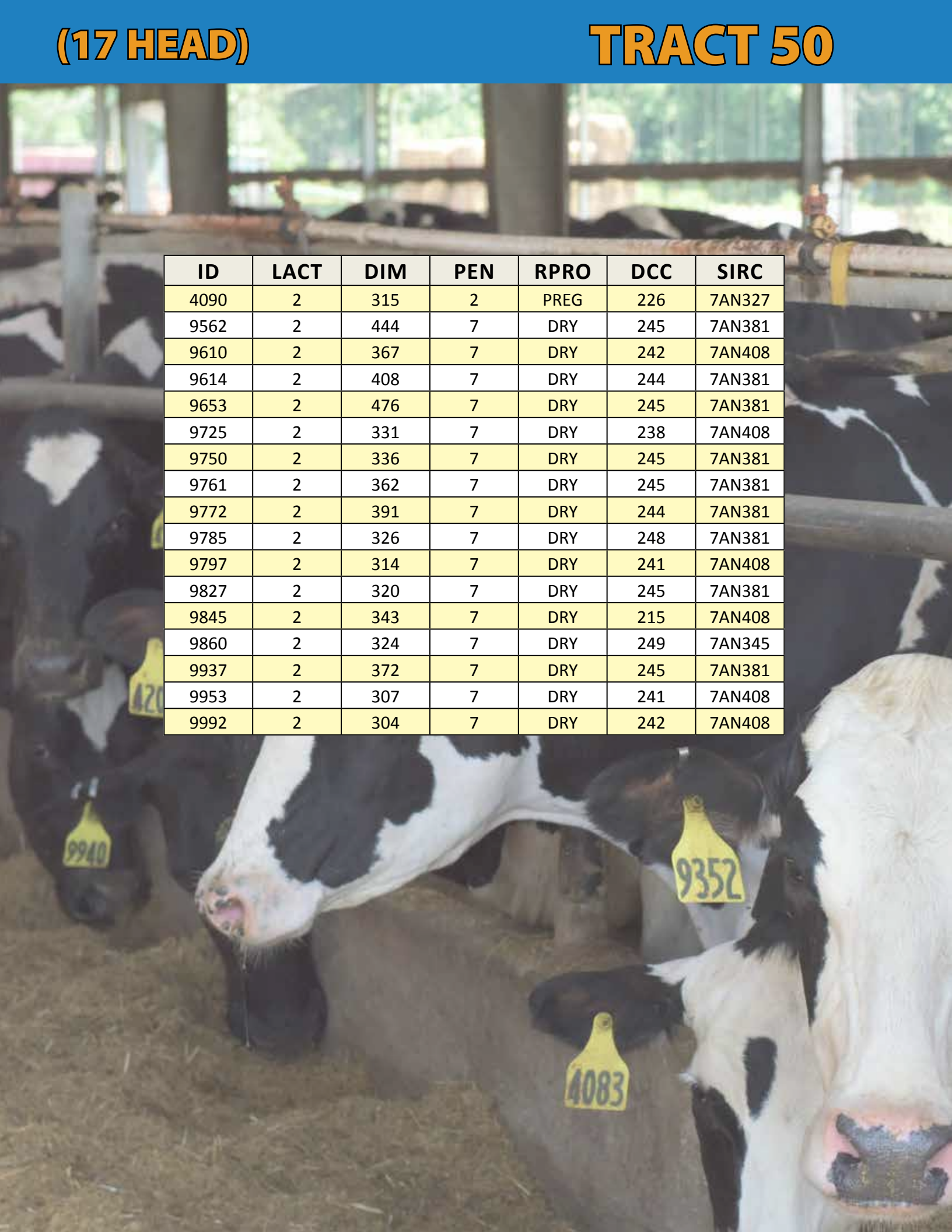

ID	LACT	DIM	PEN	RPRO	DCC	SIRC
4090	2	315	2	PREG	226	7AN327
9562	2	444	7	DRY	245	7AN381
9610	2	367	7	DRY	242	7AN408
9614	2	408	7	DRY	244	7AN381
9653	2	476	7	DRY	245	7AN381
9725	2	331	7	DRY	238	7AN408
9750	2	336	7	DRY	245	7AN381
9761	2	362	7	DRY	245	7AN381
9772	2	391	7	DRY	244	7AN381
9785	2	326	7	DRY	248	7AN381
9797	2	314	7	DRY	241	7AN408
9827	2	320	7	DRY	245	7AN381
9845	2	343	7	DRY	215	7AN408
9860	2	324	7	DRY	249	7AN345
9937	2	372	7	DRY	245	7AN381
9953	2	307	7	DRY	241	7AN408
9992	2	304	7	DRY	242	7AN408





 **SCHRADER**  
*Real Estate and Auction Company, Inc.*

800.451.2709 • [SchraderAuction.com](http://SchraderAuction.com)

Auctioneer: Rex Defoe Schrader II

