

REAL ESTATE

Listing

PROPERTY FOR SALE

Building Sites / Recreation
27.3± Total Acres

WHITLEY COUNTY - SMITH TOWNSHIP



TOTAL ACRES:
27.3± ACRES



PRICE:
\$200,000

OTHER DETAILS:

- Whitley County - Smith Township
- Owners: Stacy & Krista Holzinger
- Possession Date: At closing
- Topography: Rolling
- High School: Churubusco
- Additional Comments: Some of the property is enrolled in conservation reserve program, CRP payments are available.

DIRECTIONS:

From Churubusco, IN: Travel west on St Rd 205 to 450 E., then turn North (right) approx. 1 and 1/4 mile to property. Or, from Columbia City, IN, travel Northeast on St Rd 205 to CR 450 E, then turn North (left) to property.



The information on this sheet is subject to verification and no liability for errors or omissions is assumed by the Schradler Agency.

Holzinger • RC25W



800.451.2709
schraderauction.com/listings

Listing Agent: RITTER COX
260-609-3306 • ritter@schraderauction.com

REAL ESTATE

Listing

PROPERTY FOR SALE

Building Sites / Recreation
27.3± Total Acres



TOTAL ACRES:
27.3± ACRES



PRICE:
\$200,000

AERIAL MAP



SOILS MAP

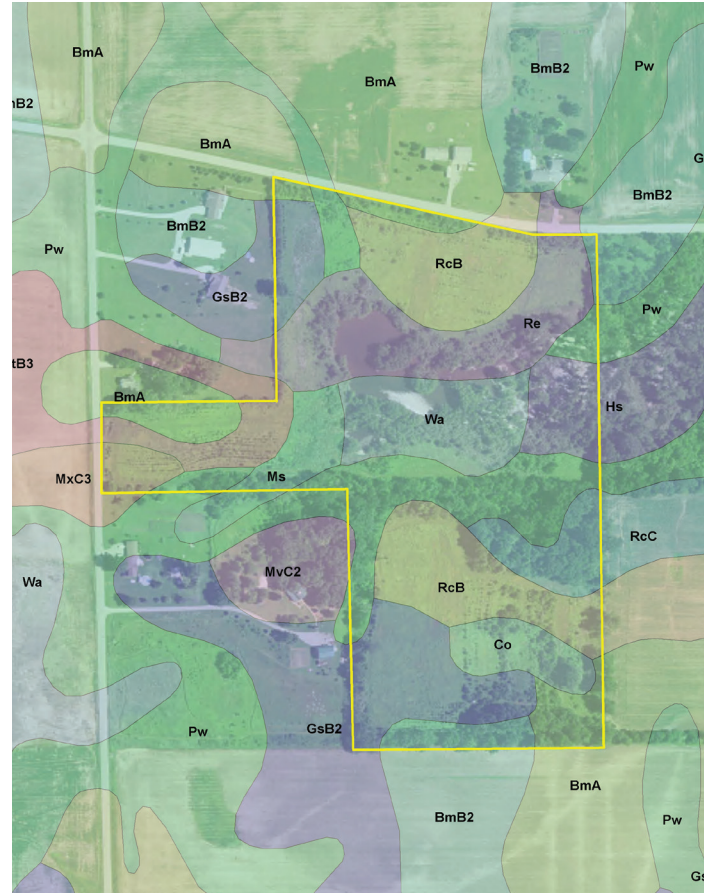

LOCATION MAP

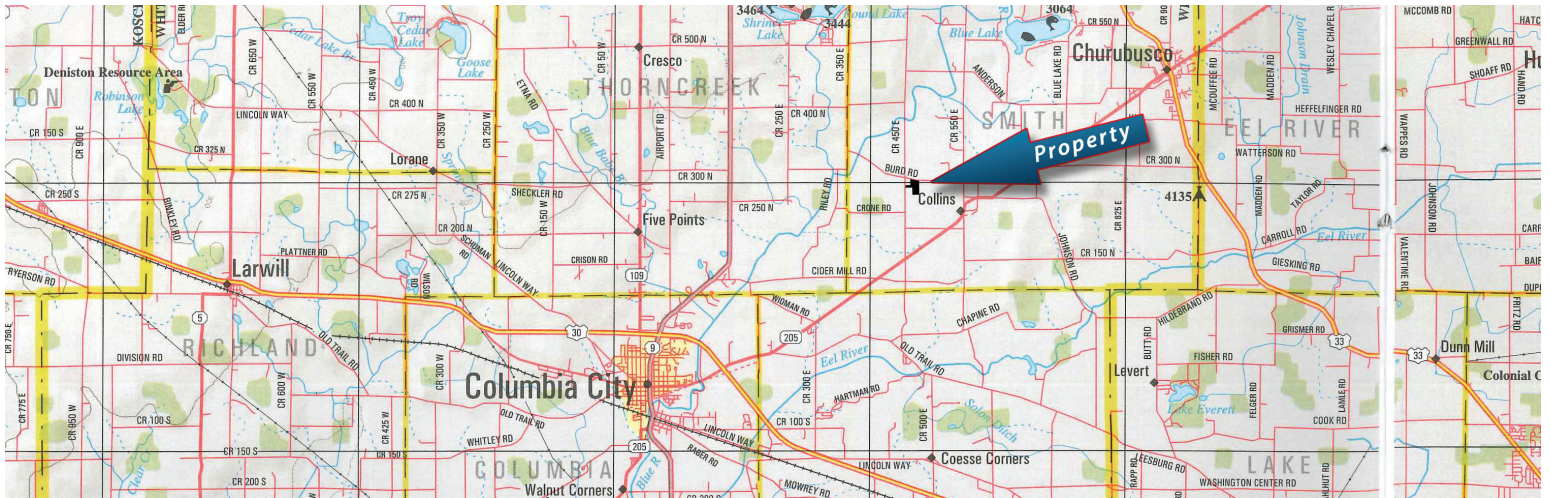

The information on this sheet is subject to verification and no liability for errors or omissions is assumed by the Schrader Agency.

Holzinger • RC25W



800.451.2709
schraderauction.com/listings

Listing Agent: RITTER COX
260-609-3306 • ritter@schraderauction.com