

## PLAT OF SURVEY

ALL OF SECTION THREE (3), TOWNSHIP SEVENTEEN (17) NORTH, RANGE FOUR (4) EAST OF THE THIRD (3RD) PRINCIPAL MERIDIAN, PIATT COUNTY, ILLINOIS, EXCEPT THAT PORTION CONVEYED FOR RIGHT OF WAY PURPOSES.

AND

ALL THAT PART OF SECTION TEN (10), TOWNSHIP SEVENTEEN (17) NORTH, RANGE FOUR (4) EAST OF THE THIRD (3RD) PRINCIPAL MERIDIAN, PIATT COUNTY, ILLINOIS, LYING NORTH OF THE SANGAMON RIVER, EXCEPT THAT PORTION CONVEYED FOR RIGHT OF WAY PURPOSES.

**Legend**  
 Scale: 1" = 400'  
 ○ = Iron Pipe or Pin From Prev. Surveys  
 ● = 5/8" Iron Pin Set This Survey  
 100.00' = Measured Dimension (100.00') = Record Dimension

0 400 800  
 Scale in Feet

Bearings are based on the Illinois State Plane Coordinate System - East Zone.

Fieldwork complete: January 29, 2018

**Survey Notes:**

- 1.) The field and office procedures were performed by me, or under my direct supervision in the month of January 2018.
- 2.) No investigation was made concerning environmental or subsurface conditions or the existence of underground utilities in the course of this survey.
- 3.) No investigation was made concerning the compliance or non-compliance with the local zoning ordinances in effect, if any, in the course of this survey.
- 4.) The boundary of this property was determined by the physical location of existing monumentation in Sections 3, 10 and the surrounding sections.
- 5.) This professional service conforms with the current Illinois Minimum Standards of Practice applicable to boundary surveys.

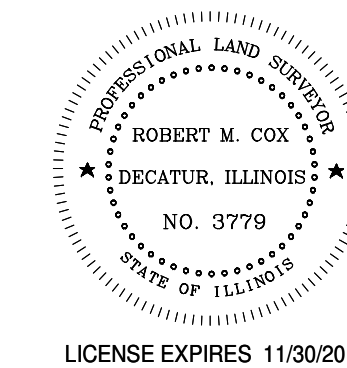

**Surveyor's Certificate**  
 I, Robert M. Cox, Illinois Professional Land Surveyor Number 3779, do hereby certify to the best of my knowledge and belief, that this plat correctly represents the results of a survey performed by me in the month of January 2018, in accordance with state statutes governing survey work in the State of Illinois.

**ELECTRONIC COPY**

January 29, 2018  
 Robert M. Cox  
 IL Professional Land Surveyor No. 3779  
 (License Expires November 30, 2018)