

TRACT 35



SHOW BARN



ANDERSON CIRCLE SHOW & SALE BARN

With the purchase of the Wilkinson farm in 1988, Anderson Circle Farm gained valuable road visibility from Route 127, the major north / south state route with links to other major Kentucky transportation routes. Thus, Ralph decided that the new Sale and Show Barn should be located with a direct access to Route 127. This would not only be a highly visible site, but would offer convenient access.

Looming on the landscape, the barn commands attention, respect, even reverence. The American Barn is an irrefutable testimony to the integrity and economy with which builders' shaped native materials into monumental structures. The American barn is one of a handful of rare symbols that immediately evoke our national heritage. The red, white, and blue with the stars and bars of our flag, or the magnificent bald eagle are both icons that symbolize America. Following closely is the image of a barn, another enduring symbol of the American pioneer spirit, and one that recalls the hard work and cultural values that combined to build our nation. Barns evoke a sense of tradition and security, of closeness to the land and to the people who built them. No two barns are exactly alike, which is another reason for their appeal. Americans take special pride in being singular individuals, and barns reflect that uniqueness. More than shelter and storage, a family's barn was a statement of pride.

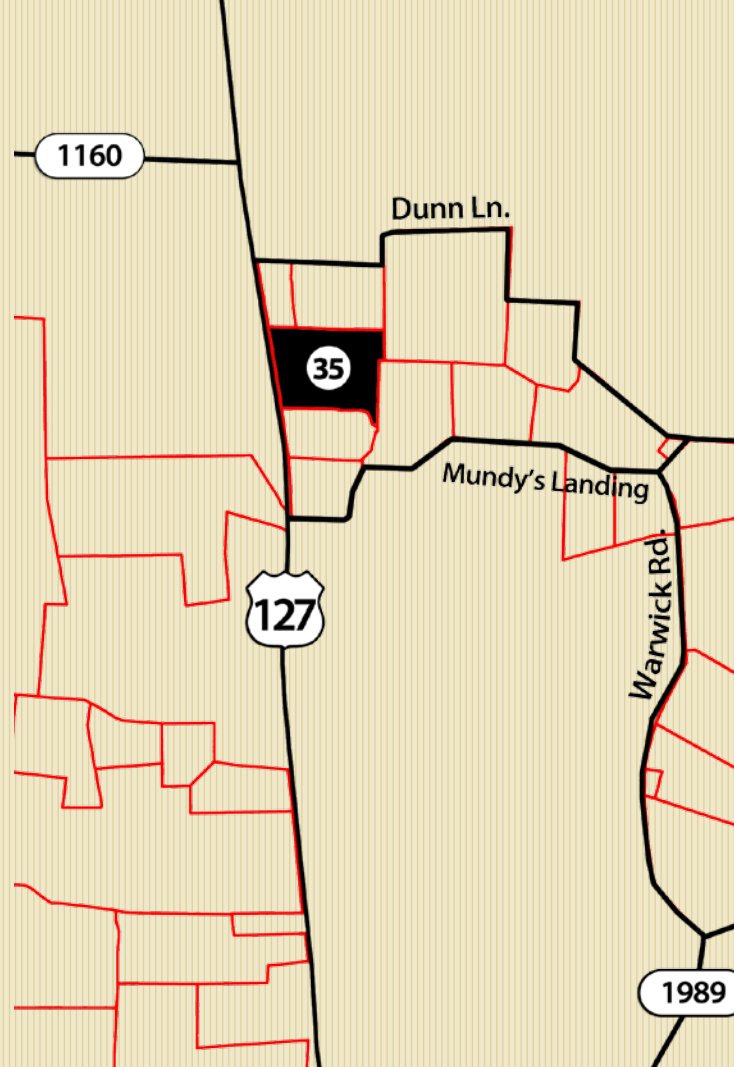

Applying the rich history of the Kentucky Barn to the functional requirements of the Anderson Circle Farm Sale and Show Barn led us to utilize two Traverse crib barns which intersect at the east end. One of the Traverse crib barns is designated as our Animal barn while the second one is designated as our Show Barn. Gable ends add visual interest to the roof line and define the two barns but integrate them as one unified design. Cupolas are located on the roofs covering both the Show Barn and the Animal Barn, and clearstory windows allow natural light to flood the Lobby area. The exterior siding is cedar wood siding applied vertically and stained dark grey. Natural limestone was used to form exposed support columns and add visual interest at all entrances. A standing seam, pre-finished metal roof serves as the roofing material.

We applied the visual design elements and colors found in horse and tobacco barn to create a new generation Cattle barn. The resulting design was a Show and Sale Barn facility with a Total Square Footage of 14,550 Square Feet.

Our desire was to create an open and spacious Lobby where visitors could socialize and have a meal during events. The interior is lined with cedar wood to give a feeling of warmth

and to add to the lightness of the space. A fully equipped commercial kitchen allows us to serve several hundred guests. During a typical year, several thousand meals are prepared and served from this location.

The animal barn is located to the east of the Lobby and is arranged to allow sale cattle to be brought from the Lot Pens directly into the Show Ring. Following the Lot Sale, cattle are returned to a holding lot located directly to the east. To fully serve our artificial insemination business, we constructed a modern, fully equipped Laboratory as a part of the Animal barn.

Since the Show and Sale Barn served as the main Anderson Circle Farm office, it was open during all business days throughout the year. Visitors frequent the office on a daily basis, and as such, a separate entrance is provided directly into the office area. Our offices are highly automated since we recognize that technology is the stepping stone to our future success. We utilized information technology to its greatest possible extent, and have high speed, broadband connectivity to the outside world via a T-1 line.











LOBBY & OFFICES

LOBBY: 40'6" x 36'

OFFICE #1: 12'8.5" x 12'

OFFICE #2: 15' x 12'

OFFICE #3: 6'5" x 11'

CONFERENCE ROOM: 14' X 22'

KITCHEN: 14'3" x 16'0

PANTRY: 5' x 7'

WOMEN'S BATHROOM: 9'2" x 20'

MEN'S BATHROOM: 9'2" x 20'

SHOW/SALE BARN

SHOW/SALE BARN: 44' x 85'

STORAGE #1: 15' x 18'

STORAGE #2: 15' x 18'

STALLS (EACH): 10' x 16'2.75"

CLEAN-UP: 12' x 17'4"

LAB: 16' x 16'

FEED ROOM: 23'1" x 16'5"



950 N. Liberty Drive Columbia City, IN

800.451.2709 | SchraderAuction.com

